



9 Water Meadow Close
Great Oakley, NN18 8JD



Simpson West

Boasting a perfect position within this much sought after cul-de-sac which can be found within Great Oakley, this rarely available detached bungalow which is being offered for sale with NO CHAIN. Presented in good condition throughout, the property offers features to include a reception hall, a highly spacious living/dining room with French doors leading into the conservatory. A refitted kitchen includes integrated appliances and there are THREE BEDROOMS with the master and guest suites enjoying fitted wardrobes, there is also a refitted shower room. Outside, there is an attractive lawned frontage with a driveway set to the right-hand side which provides OFF ROAD PARKING and leads to the GARAGE. A south easterly highly private rear garden is a particular feature as it has been landscaped to provide a large patio space with good sized lawned areas that are complimented by decorative and highly established borders. There are also a summerhouse and greenhouse, and pedestrian access to the garage. Viewing of this special bungalow is highly advised if its position and many features are to be truly appreciated! Energy Rating D. Council Tax Band D.

£359,950

 3  1  2



Ground Floor

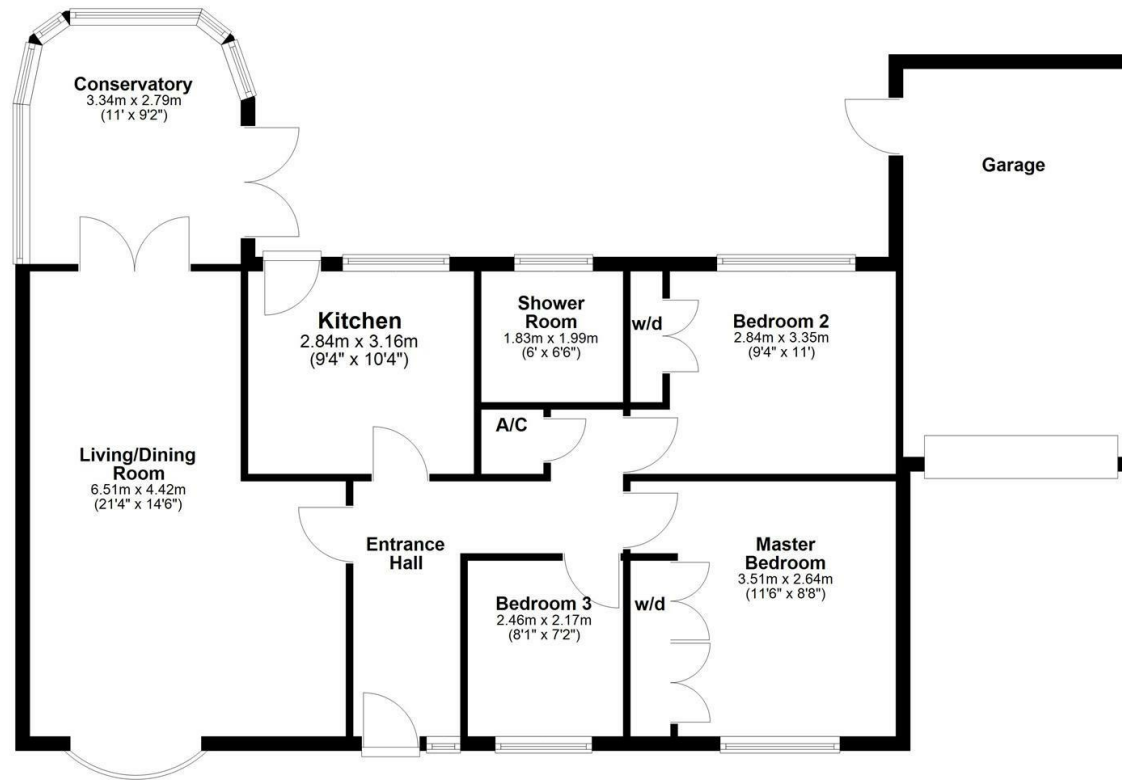

Energy Efficiency Rating		
	Current	Potential
Very energy efficient - lower running costs		
(92 plus) A		
(81-91) B		
(69-80) C		
(55-68) D	68	76
(39-54) E		
(21-38) F		
(1-20) G		
Not energy efficient - higher running costs		
England & Wales	EU Directive 2002/91/EC	



When you buy with Simpson West, you know **you'll be in safe hands**. From the moment you walk through our doors, we'll make you **feel truly welcome**. Our sales consultants and financial advisors will take you through **every step of the process**, offering **free expert advice** along the way, from help choosing the right mortgage and insurance through to finding your conveyancer. And if you need help selling your home too, **with over 20 years of local experience, you can trust us to get you moving**.



**Simpson
West**

Making Every
Journey Personal



01536 202007

info@simpsonwest.co.uk

<https://www.simpsonwest.co.uk/>

64 Corporation Street, Corby, Northants, NN17 1NH