

## Tayport Close, N1

£475,000

This bright split-level apartment is arranged over the top two floors and features a spacious reception room with direct access to a private balcony, along with a separate fitted kitchen. Upstairs, the property offers two double bedrooms, a family bathroom, and a separate WC.

Tayport Close offers excellent transport links, with Caledonian road (Overground) Angel Station (Northern Line) and King's Cross St Pancras Station providing extensive connections across London and Europe. The area boasts vibrant amenities, including the shops and restaurants of Upper Street, and the green spaces of Barnard Park.

### Features

- Chain Free
- Top Floor
- Two Bedrooms
- Separate Kitchen
- Split Level
- Balcony

# Tayport Close, London, N1

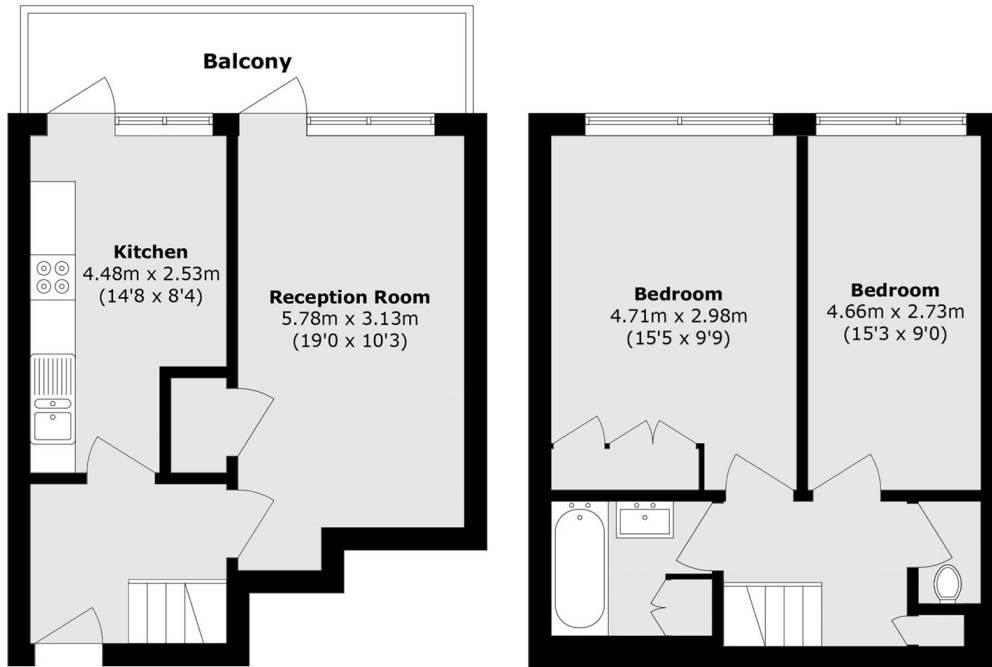

**Second Floor**

**Third Floor**

Total area (approx.): 78.7 sq. m (847.1 sq. ft)

Balcony area (approx.): 7.7 sq. m (82.8 sq. ft)