



Abbey Road, NW8

£320 Per week

A modern studio apartment on the fifth floor (via lift) in a portered block close to St Johns Wood station. Communal heating and hot water within the rent. Ideal home for a single professional or couple.

Langford Court is located just off of Abbey Road, close to the American School and a short walk to St Johns Wood High Street.

Features

- Studio Apartment
- Wood Floors Throughout
- Separate Kitchen
- Modern Bathroom
- Porter Service
- Communal Heating and Hot Water Included

Abbey Road, London, NW8

LANGFORD COURT, ABBEY ROAD, NW8

Approx. gross internal area

268 Sq Ft / 24.9 Sq M.

Representation of current layout.

Not to scale.

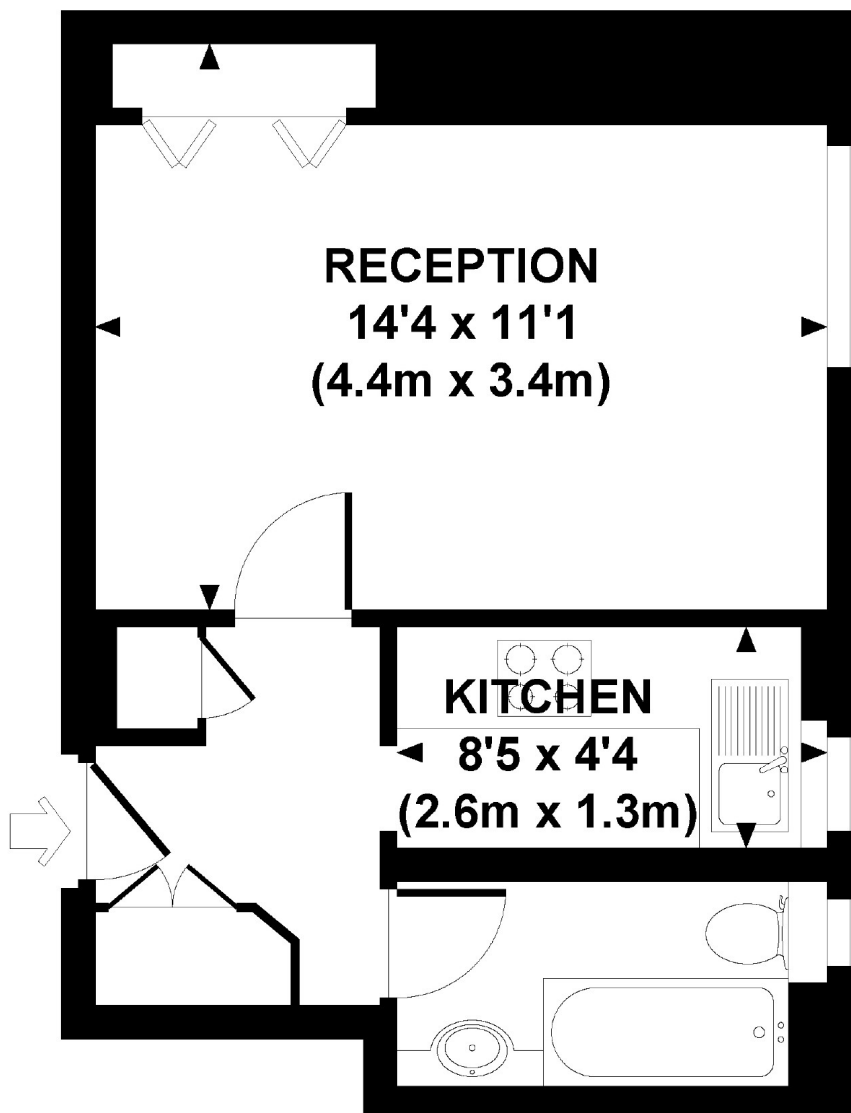

Contact

To arrange a viewing call our office on the number below or visit our website.



Energy Rating: C. We aim to make our particulars both accurate and reliable. However they are not guaranteed; nor do they form part of an offer or contract. If you require clarification on any points then please contact us, especially if you're traveling some distance to view. Please note that appliances and heating systems have not been tested and therefore no warranties can be given as to their good working order.