

MORGAN H LEWIS



Asking Price £270,000

Arbour Lane, Wigan WN6 0YJ

- *Semi Detached True Bungalow
- *Unrivalled Open Views To Front and Rear
- *Open Plan Kitchen Diner
- *Large Driveway With Ample Parking
- *Walking Distance to Standish Village
- *Brimming With Potential

MORGAN H LEWIS



MORGAN H LEWIS

Now available for sale, this delightful semi detached bungalow is situated along the ever popular Arbour Lane, arguably boasting Standish's most peaceful views just a stones throw away from Standish village, as well as excellent links via the M6 Motorway.

The property on offer is briefly comprised of; a welcoming entrance hallway, which gives access to all of the accommodation, a spacious living room to the front of the home looks out over the large front garden onto the fields. The open plan kitchen diner to the rear is a welcoming space, with plenty of storage and opens up into the spacious dining room to the rear, perfect for entertaining or as a spot to relax and look out to the views, with sliding doors giving access to the rear gardens. There are two generous double bedrooms, with the front bedroom benefitting from fitted wardrobes and drawers, and the back bedroom benefitting from fitted wardrobes with views out to the back. The bathroom completes the internal accommodation, with an enclosed shower, w.c. and sink.

Externally is where this property really shines, set well back from the road, with a large brick paved driveway providing parking for multiple vehicles. The rear garden is spacious, mostly paved with a raised patio to the bottom overlooking the fields, a beautiful space to entertain guests, spend time with family and enjoy the summer months.

Finally, to complete this property, a handy garage/carport completes the accommodation on offer. This home is very much a rare opportunity and is brimming with potential, offering the next custodians the chance to create a truly lovely home in one of the prettiest spots in the village.

Early viewings are recommended.

MORGAN H LEWIS



MORGAN H LEWIS



MORGAN H LEWIS

Arbour Lane, Standish, Wigan

Total Approx. Floor Area 904 Sq.ft. (84.0 Sq.M.)

Surveyed and drawn by Lens Media for illustrative purposes only. Not to scale. Whilst every attempt was made to ensure the accuracy of the floor plan, all measurements are approximate and no responsibility is taken for any error.

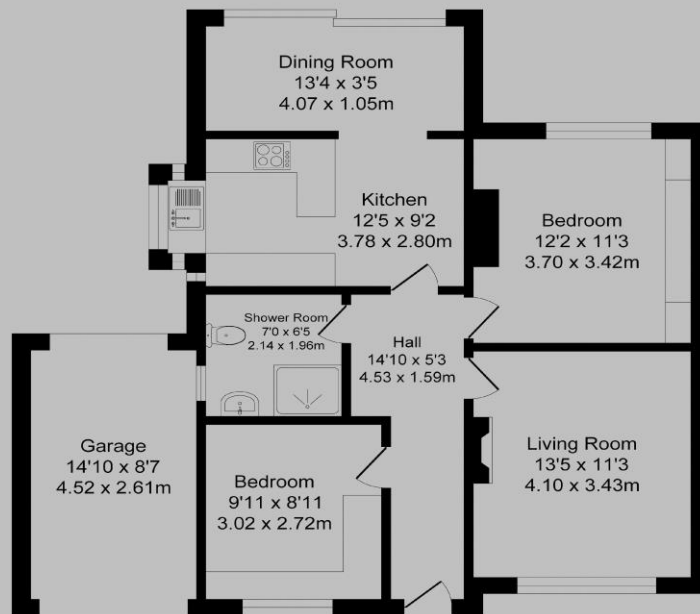

Approx. Floor
Area 904 Sq.Ft
(84.0 Sq.M.)