

Haworth Court, Preston Road, Clayton-Le-Woods

Offers Over £230,000

🛏 2 🚿 2 🛋 1



- Spacious two-bedroom, two-bathroom apartment on the ground floor
- Exclusive over-60s development with a warm community feel
- Modern fitted kitchen with integrated appliances
- Bright, airy lounge opening directly onto the patio
- Beautiful communal lounge and gardens
- Private patio with views of woodland and communal gardens
- On-site House Manager and 24-hour emergency call system
- Principal bedroom with walk-in wardrobe and en-suite bathroom
- Guest suite for family and friends
- Excellent transport links and local amenities within walking distance



Haworth Court, Preston Road, Chorley
Approximate Gross Internal Area
866 Sq Ft/80 Sq M

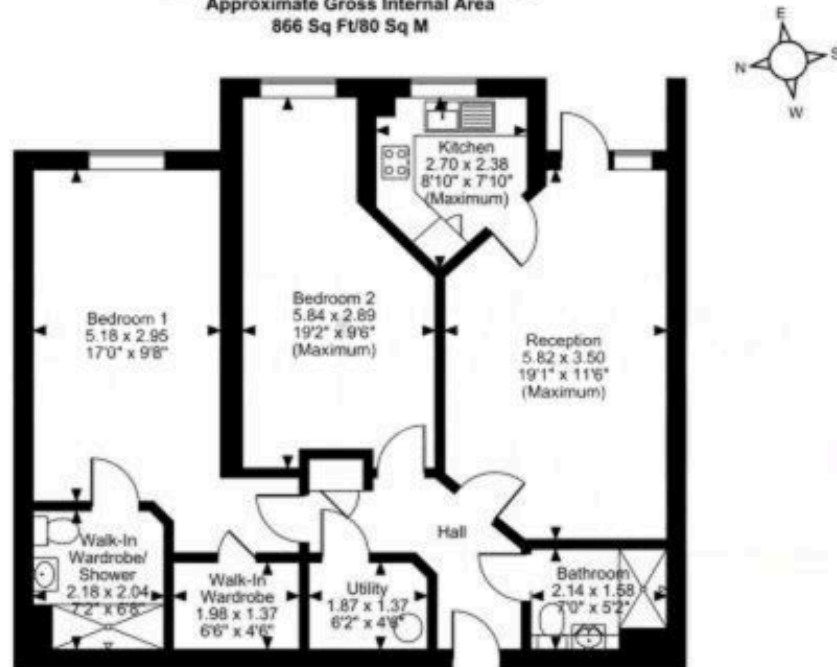

Set back in a peaceful pocket of Clayton-le-Woods, this beautifully presented two-bedroom, two-bathroom ground floor apartment is part of an exclusive over-60s development designed for ease, comfort, and community. With a private patio, landscaped gardens, welcoming communal spaces, an on-site House Manager, and a 24-hour emergency call system, it offers a secure and social lifestyle where everything you need is on your doorstep.