



**£250,000-£260,000**

**SOUTHCLIFFE ROAD  
CARLTON**

- DETACHED BUNGALOW
- KITCHEN/DINER
- TWO BEDROOMS
- DETACHED GARAGE
- CLOSE TO AMENITIES
- EPC D



## Spacious Two-Bedroom Detached Bungalow with Excellent Potential

SITUATED IN A POPULAR RESIDENTIAL LOCATION, THIS TWO-BEDROOM DETACHED BUNGALOW OFFERS SPACIOUS AND VERSATILE ACCOMMODATION THROUGHOUT AND PRESENTS AN EXCELLENT OPPORTUNITY FOR BUYERS LOOKING TO MODERNISE AND ADD THEIR OWN PERSONAL TOUCH. THE PROPERTY IS CONVENIENTLY POSITIONED WITHIN CLOSE PROXIMITY TO A RANGE OF LOCAL AMENITIES, SHOPS AND EXCELLENT TRANSPORT LINKS INTO NOTTINGHAM CITY CENTRE, AS WELL AS FALLING WITHIN THE CATCHMENT AREA FOR WELL-REGARDED SCHOOLS.

THE ACCOMMODATION COMPRISES A WELCOMING ENTRANCE HALLWAY, A GENEROUS LIVING ROOM, A SPACIOUS KITCHEN DINER WITH ACCESS THROUGH TO THE SUN ROOM OVERLOOKING THE REAR GARDEN, TWO WELL-PROPORTIONED DOUBLE BEDROOMS AND A BATHROOM.

EXTERNALLY, THE PROPERTY BENEFITS FROM GARDENS TO THE FRONT AND REAR, TOGETHER WITH DRIVEWAY PARKING LEADING TO A DETACHED GARAGE.

OFFERED TO THE MARKET WITH PLENTY OF POTENTIAL, THIS BUNGALOW IS IDEAL FOR BUYERS LOOKING TO CREATE A HOME TAILORED TO THEIR OWN STYLE AND REQUIREMENTS WITHIN A WELL-ESTABLISHED AREA.

- FREEHOLD
- COUNCIL TAX; BAND C
- LOCAL AUTHORITY; GEDLING BOROUGH COUNCIL
- MEASUREMENTS; 80 SQ METERS

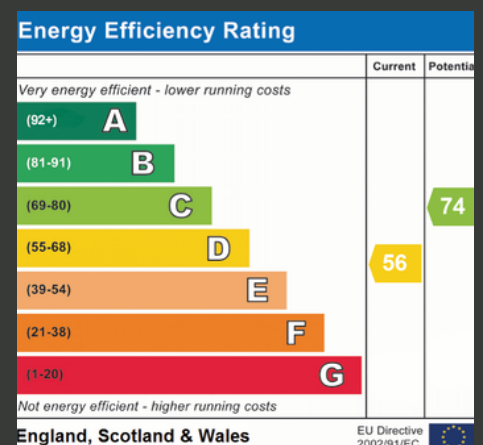



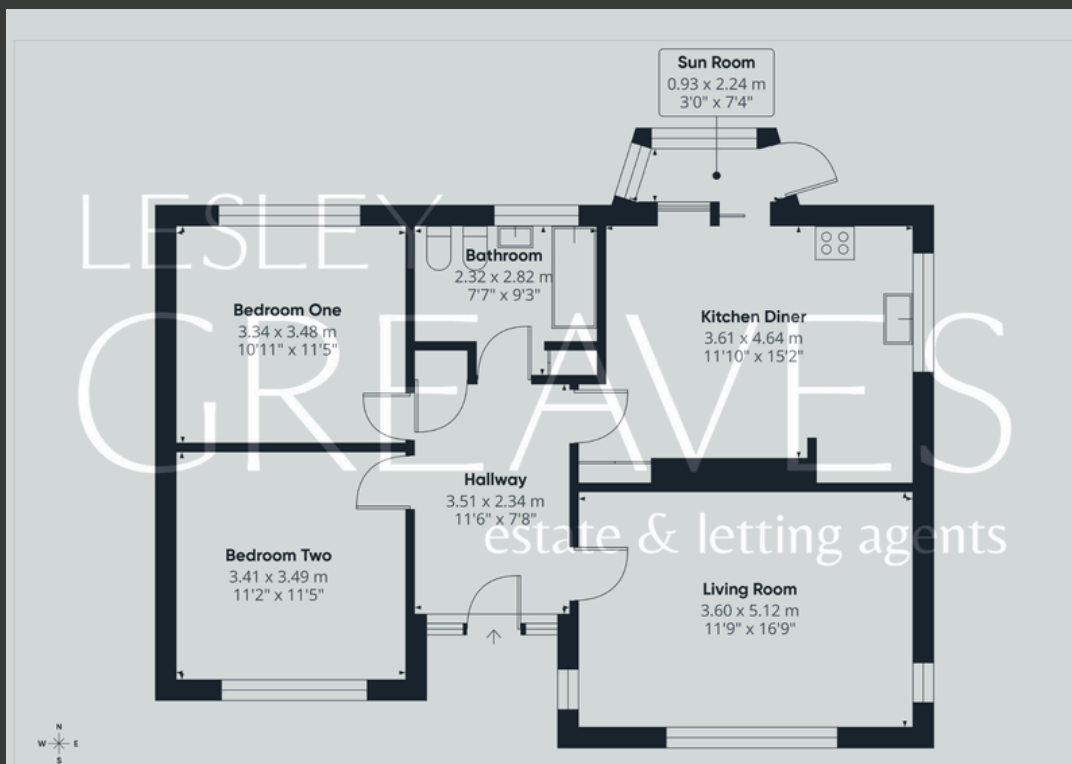

Agent's Note: These particulars have been prepared in good faith and are provided for guidance purposes only. While every effort has been made to ensure their accuracy, they should not be relied upon as exact. All measurements are approximate, and floor plans are for illustrative purposes only. Prospective buyers or tenants are advised to verify all details independently, conduct their own due diligence, and note that services, systems, and appliances have not been tested.

## Lesley Greaves Estate & Lettings Agents

22 Main Road ,Gedling, Nottingham, NG4 3HP

0115 987 7337

sales@lesleygreaves.co.uk