



Luscombe Maye

Since 1873

Turnchapel, South Coast of Devon

Offers Over £895,000

🛏️ 3 🚿 2 🚗 2



- Highly motivated sellers
- Stunning open-plan living with bespoke kitchen and wood burner
- Principal suite with freestanding bath and private balcony
- Contemporary bathrooms across all floors
- Prime Turnchapel village location with marina and city links
- Architect-designed three-storey detached waterside home
- Wrap-around balcony with uninterrupted water views
- Flexible layout with bedrooms and home office space
- Planning consent for a private slipway and boating access





Clovelly View, Turnchapel, Plymstock, Plymouth, PL9

Approximate Area = 2475 sq ft / 229.9 sq m

For identification only - Not to scale

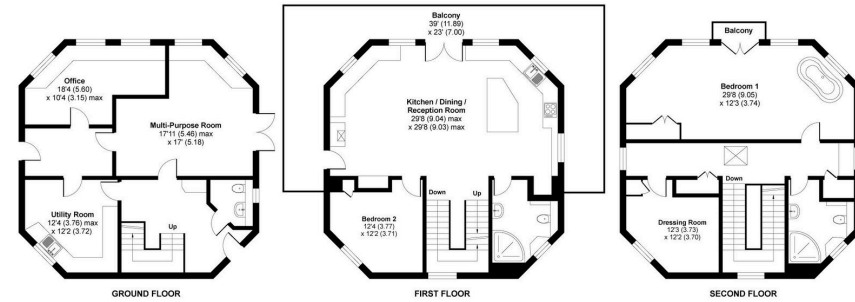

Floor plan produced in accordance with RICS Property Measurement 2nd Edition, Incorporating International Property Measurement Standards (IPMS2 Residential). © ricscom 2025. Produced for Luscombe Maye. REF: 1309302



An individually architecturally designed waterside detached home offering exceptional views and lifestyle appeal.

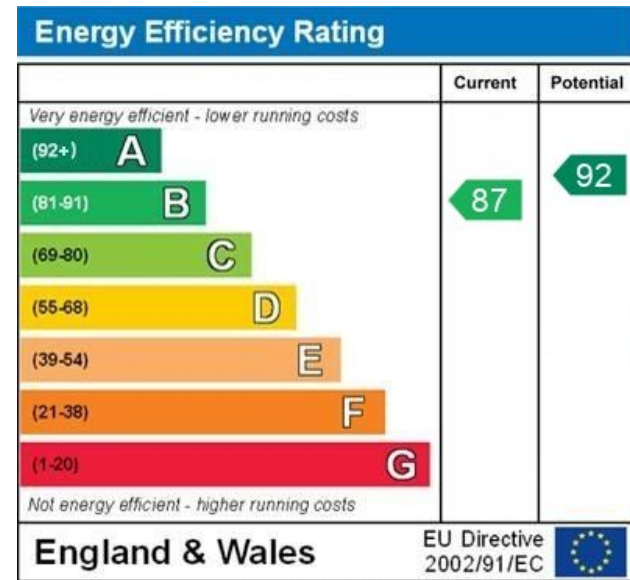

WWW.EPC4U.COM



Yealmpton:
 The Old Bakery, Market Street, Yealmpton PL8 2EA
 01752 880044
 yealmpton@luscombemaye.com
www.luscombemaye.com

Important Notice: Luscombe Maye gives notice that: 1. These particulars do not constitute an offer or contract or part thereof. 2. All descriptions, photographs and plans are for guidance only and should not be relied upon as statements or representations of fact. All measurements are approximate and not necessarily to scale. Any prospective purchaser must satisfy themselves of the correctness of the information within the particulars by inspection or otherwise. 3. Luscombe Maye does not have any authority to give any representations or warranties whatsoever in relation to this property (including but not limited to planning/building regulations), nor can it enter into any contract on behalf of the Vendor.