

£1,350 pcm  
Eagle Drive, Colindale



1  
Bedroom

1  
Bathroom

211 Edgware Rd, London, NW9 6LP |  
colindale@warrenbradleystates.co.uk

020 8200 7007

£1,350 pcm  
Eagle Drive, Colindale



**We are pleased to offer to rent this one bedroom first floor purpose built flat. This property is offered in good condition and has the additional benefits of double glazing, gas cooking, entryphone and an allocated parking space.**

Located on the popular 'Bird' development. The property is a few minutes from Colindale's Northern Line Underground Station and local shops. The property is offered part furnished and is available from the 26/07/26.



### Yellowhammer Court

Approx. 33.6 sq. metres (361.4 sq. feet)

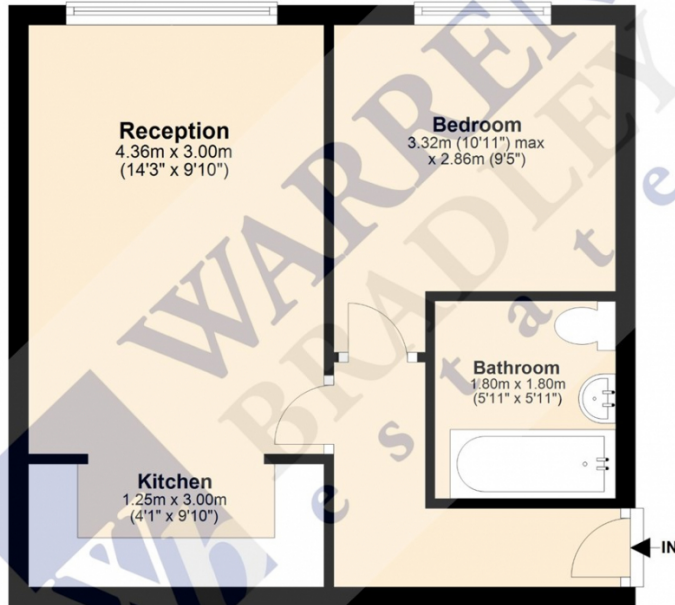

Total area: approx. 33.6 sq. metres (361.4 sq. feet)

Disclaimer: Please note this floor plan is for marketing purposes and is to be used as a guide only.

Plan produced using PlanUp.

Score	Energy rating	Current	Potential
92+	A		
81-91	B	82 B	82 B
69-80	C		
55-68	D		
39-54	E		
21-38	F		
1-20	G		

The graph shows this property's current and potential energy rating.

