



Connells

Fairfield Way
Great Ashby Stevenage



Property Description

We are pleased to present a modern three bedroom end terraced family home, located in the ever popular Great Ashby area on the edge of Stevenage. The property boasts spacious living accommodation & benefits from gas radiator heating, double glazing, modern fitted kitchen with dining area, en-suite shower to main double bedroom, neat enclosed rear garden and a garage with driveway in front.

Fairfield Way in Great Ashby is ideally located within easy reach of local amenities, good schooling for all ages & convenient road links to the town centre & A1M serving the north & south. Stevenage provides a fast & efficient link to London via the mainline station, the historic old high street with array of shops, restaurants & bars & the pedestrian new town centre with indoor market.

IMMEDIATE VIEWING HIGHLY
RECOMMENDED

Entrance Hall

Lounge

Kitchen / Diner

Landing

Bedroom One

En-Suite

Bedroom Two

Bedroom Three

Family Bathroom



Outside

Rear Garden

Garage

Driveway



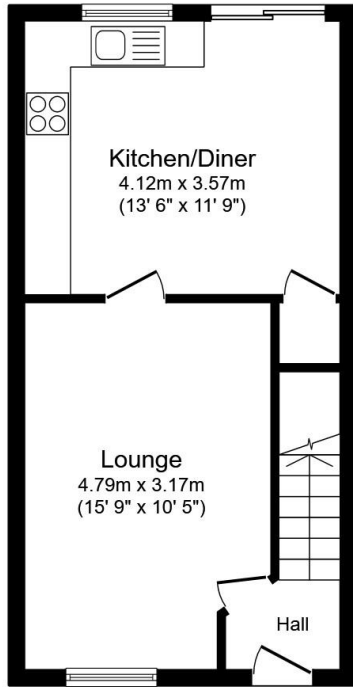

Ground Floor

Floor area 34.9 sq.m. (375 sq.ft.)

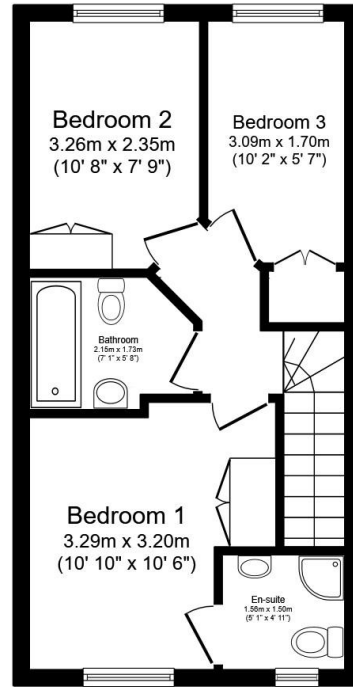

First Floor

Floor area 34.8 sq.m. (375 sq.ft.)

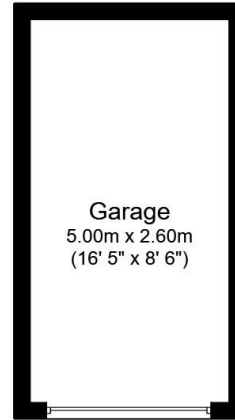

Garage

Floor area 13.0 sq.m. (140 sq.ft.)

Total floor area: 82.7 sq.m. (890 sq.ft.)

This floor plan is for illustrative purposes only. It is not drawn to scale. Any measurements, floor areas (including any total floor area), openings and orientations are approximate. No details are guaranteed, they cannot be relied upon for any purpose and do not form any part of any agreement. No liability is taken for any error, omission or misstatement. A party must rely upon its own inspection(s). Powered by www.Propertybox.io

To view this property please contact Connells on

T 01438 318 080
E stevenage@connells.co.uk

8 Market Place
 STEVENAGE SG1 1DB

EPC Rating: C Council Tax
 Band: D

view this property online connells.co.uk/Property/STV312646



Tenure: Freehold



1. MONEY LAUNDERING REGULATIONS Intending purchasers will be asked to produce identification documentation at a later stage and we would ask for your co-operation in order that there will be no delay in agreeing the sale. 2. These particulars do not constitute part or all of an offer or contract. 3. The measurements indicated are supplied for guidance only and as such must be considered incorrect. Potential buyers are advised to recheck measurements before committing to any expense. 4. We have not tested any apparatus, equipment, fixtures, fittings or services and it is in the buyers interest to check the working condition of any appliances.

Connells Residential is registered in England and Wales under company number 1489613, Registered Office is Cumbria House, 16-20 Hockliffe Street, Leighton Buzzard, Bedfordshire, LU7 1GN. VAT Registration Number is 500 2481 05.

See all our properties at www.connells.co.uk | www.rightmove.co.uk | www.zoopla.co.uk

Property Ref: STV312646 - 0007