



Price
£240,000

Freehold

1x  1x  1x 

**Duncan Close, Wickford,
Essex, SS12**

OVER 60?

Secure this property
for up to **59% less!**

 **DOUGLAS
ALLEN**
Helping you move forwards



Main features

- Immaculately presented home
- Off street parking
- Popular Wick Meadows estate
- Ideal for first time buyers
- Benefits from its own private rear garden and driveway

Accommodation

GROUND FLOOR

Entrance
 Lounge/Diner: 13'6 x 12'4 (4.12m x 3.76m)
 Kitchen: 12'4 x 6'2 (3.76m x 1.88m)

FIRST FLOOR

Landing
 Bedroom : 12'4 x 9'8 (3.76m x 2.95m)
 Bathroom

OUTSIDE

Front and Rear Gardens
 Driveway

Ground Floor

Approx. 22.1 sq. metres (238.0 sq. feet)

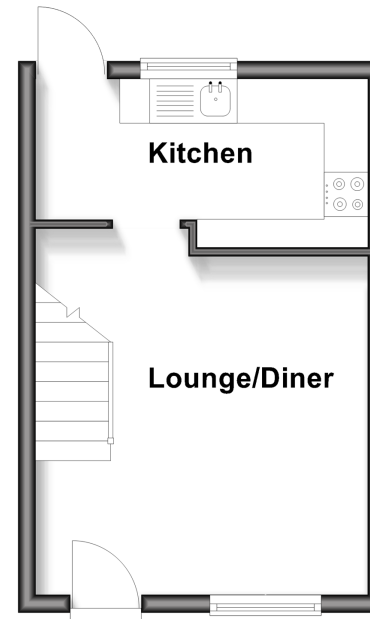

First Floor

Approx. 22.1 sq. metres (238.0 sq. feet)



Call Wickford - 01268 561287 ■ douglasallen.co.uk

■ If buying to rent, please check if Local Authority licensing schemes apply before proceeding

■ Through a Homewise Home For Life Plan people aged 60+ can secure this property for up to 59% less, by purchasing a Lifetime Lease



53412996/20260611/MB/BH