



Living
made
better

Baquba Building
Lewisham SE13



1



1



1



B

Offers In Excess Of £275,000

Baquba Building, Lewisham SE13

Madison Brook is excited to present to the market this beautiful one bedroom apartment located on the fourth floor of Baquba Building, forming part of the stunning Silkworks Development. The property is offered on NO CHAIN basis.

Boasting over 464 sq. ft. of internal living space, open-plan kitchen with integrated appliances, double bedroom with fitted wardrobe and a chic three piece bathroom. The property also benefits from a spacious balcony, 24 hour concierge and a residents gymnasium.

The apartment is located in a great spot for commuters, being only a short distance from either Elverson Road DLR (0.2 miles) or Lewisham Station (0.4 miles), as well as having easy access to the A20 offering roads into Central London & beyond. The property further benefits from access to Lewisham High Street offering a vast amount of restaurants, cafes and the famous Lewisham Open Market.



Madison Brook

Floorplan

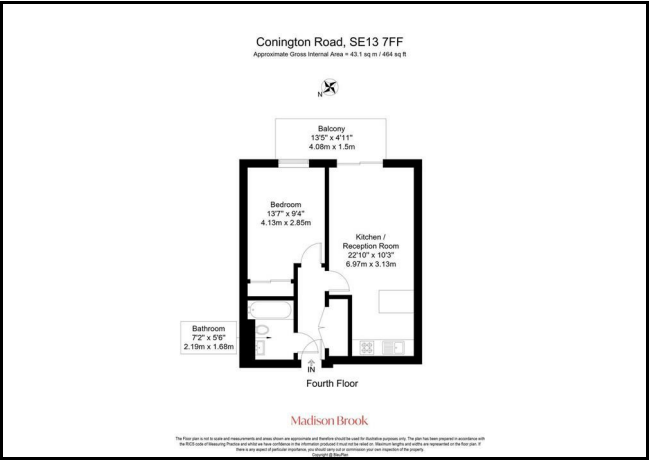

Area Map



Energy Efficiency Graph

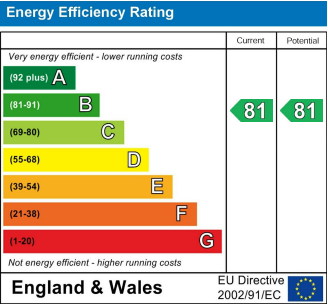

43 Loampit Vale, Lewisham, London, SE13 7FT
Tel: 020 3946 6200 Email: lewisham@madisonbrook.com <https://madisonbrook.com/>