



Caxton Road, SW19

£375,000

A two double bedroom ground floor Victorian conversion with a private garden. The property is in superb condition having been refurbished recently and is located just a few steps away from the park.

Located in the much sought after Poet's area, on a family orientated street and within the catchment for two primary schools and close to the Thames Link, London is just moments away!

Features

- Two Bedrooms
- Victorian Conversion
- Beside the Park
- Private Rear Garden
- Recently Refurbished
- Quiet Street

Caxton Road, London, SW19

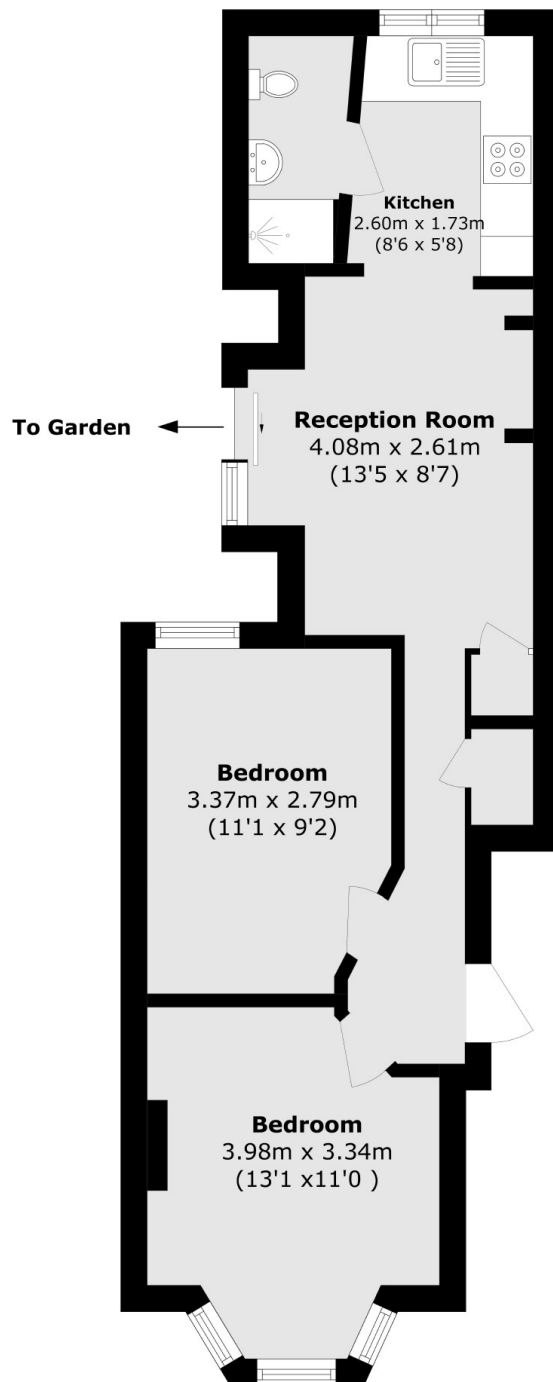

Total area (approx.): 49.7 sq. m (534.9 sq. ft)