



Isaac Way, SE1

£425,000

A highly attractive second floor flat, set to the back of the building, with a bright, private balcony, an open plan living room & modern kitchen, a generous double bedroom, with built-in wardrobes & modern three piece bathroom, plus secure underground parking.

Isaac Way sits just behind Borough Station, quietly tucked off Marshalsea Road, at the foot of Borough High Street. Moments away, Borough Market brings a lively mix of street food, artisan coffee, and local culture. A short walk leads to London Bridge and the riverside buzz of the South Bank.

Features

- One Double Bedroom
- Lift Access & Secure Entry
- Excellent Transport Links
- Secure Underground Parking
- Private Balcony
- Chain Free Sale

**Isaac Way,
London, SE1**

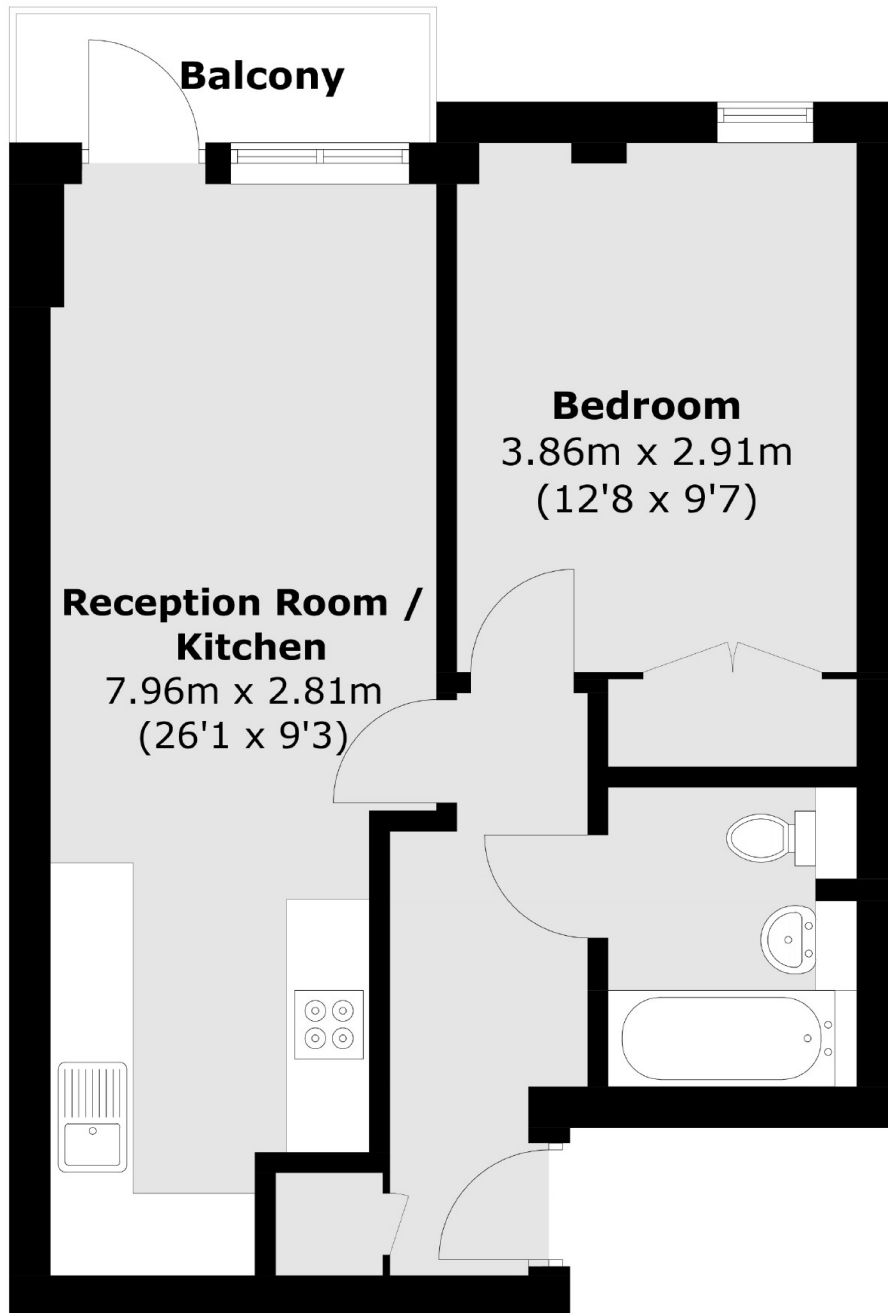

Total area (approx.): 44.5 sq. m (479.0 sq. ft)
Balcony: 2.8 sq. m (30.1 sq. ft)