

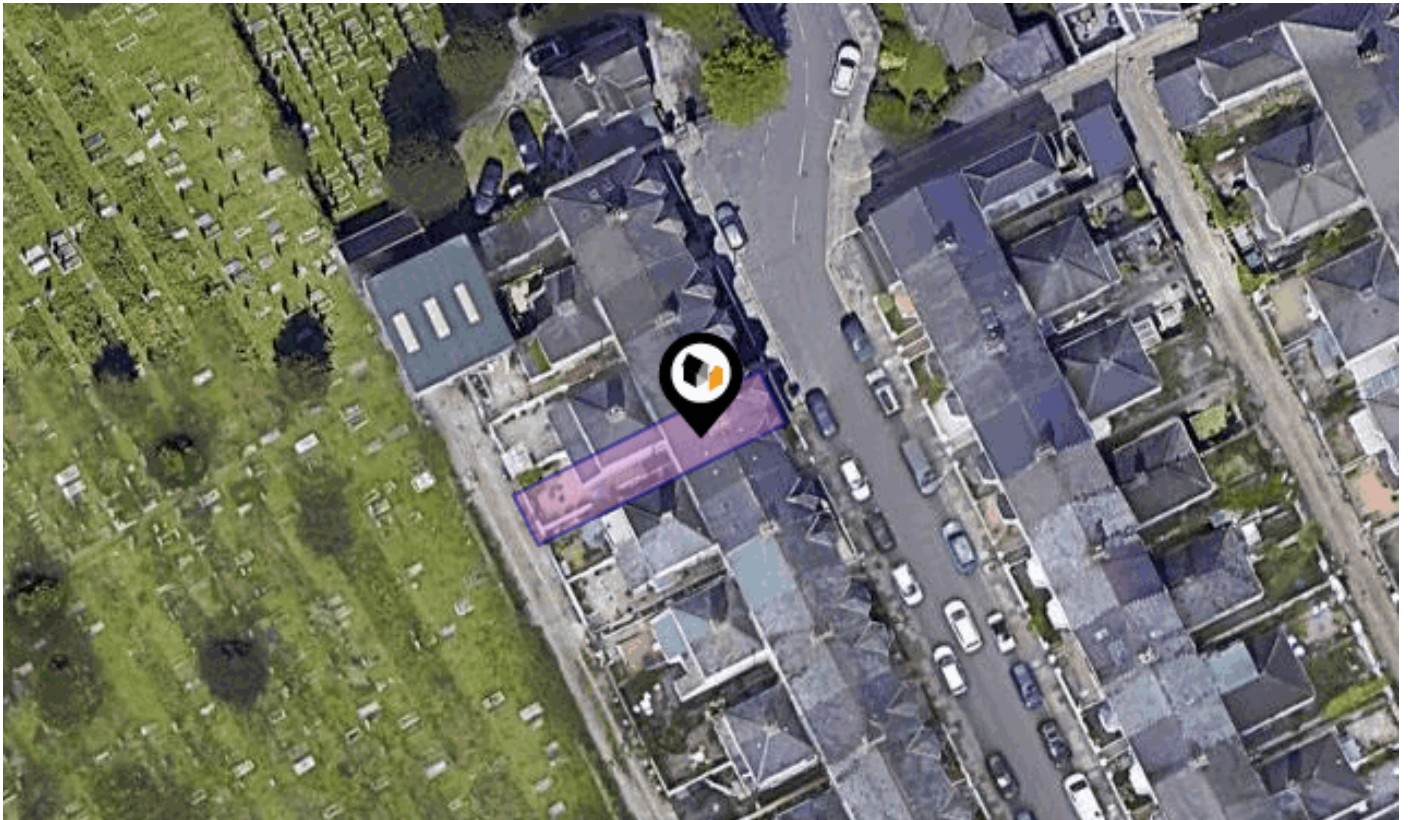

See More Online

KFB: Key Facts For Buyers

A Guide to This Property & the Local Area
Wednesday 29th April 2026



39, GIFFORD PLACE, PLYMOUTH, PL3 4JA

Lang Town & Country

6 Mannamead Road, Plymouth, PL4 7AA

01752 456000

carrie@langtownandcountry.com

www.langtownandcountry.com



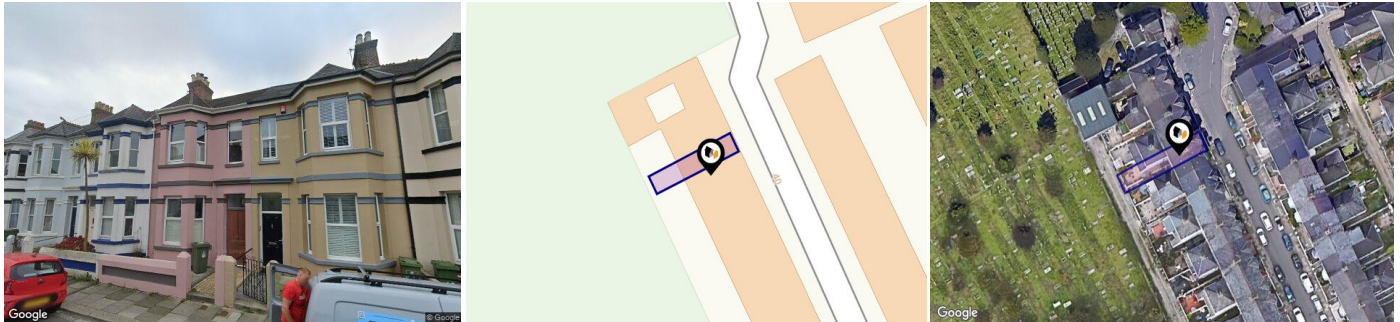



Property

Type:	Terraced	Last Sold Date:	04/03/2022
Bedrooms:	3	Last Sold Price:	£303,500
Floor Area:	1,237 ft ² / 115 m ²	Last Sold £/ft²:	£245
Plot Area:	0.03 acres	Tenure:	Freehold
Year Built :	1900-1929	Latest FENSA Work:	21/07/2003 - 9 windows, 1 door
Council Tax :	Band C		
Annual Estimate:	£2,171		
Title Number:	DN174164		
UPRN:	100040442572		
Restrictive Covenants:	Yes		

Local Area

Local Authority:	Plymouth
Conservation Area:	No
Flood Risk:	
• Rivers & Seas	Very low
• Surface Water	Very low

Estimated Broadband Speeds (Standard - Superfast - Ultrafast)

14 mb/s	100 mb/s	1800 mb/s
		

Mobile Coverage: (based on calls indoors)



Satellite/Fibre TV Availability:



39, GIFFORD PLACE, PLYMOUTH, PL3 4JA

GROUND FLOOR
637 sq.ft. (59.1 sq.m.) approx.

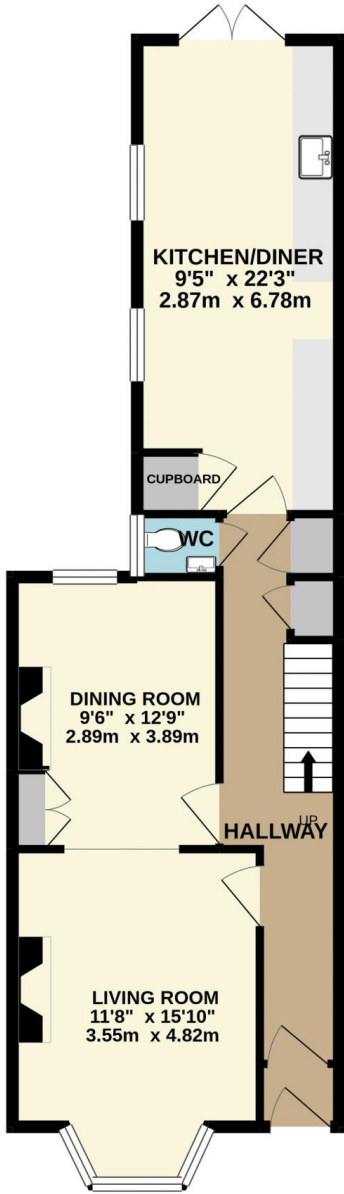

1ST FLOOR
596 sq.ft. (55.4 sq.m.) approx.

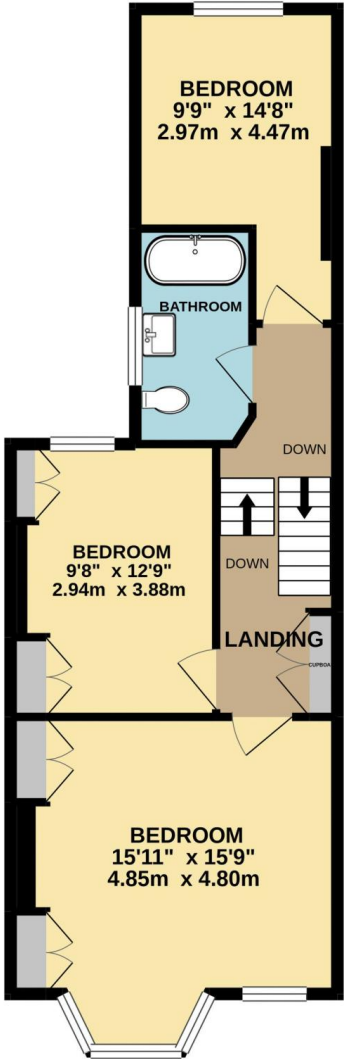

TOTAL FLOOR AREA : 1233 sq.ft. (114.5 sq.m.) approx.

Made with Metropix ©2021

39 GIFFORD PLACE, PL3 4JA

Energy rating

D

Valid until 04.08.2031

Score	Energy rating	Current	Potential
92+	A		
81-91	B		
69-80	C		76 C
55-68	D	59 D	
39-54	E		
21-38	F		
1-20	G		

Additional EPC Data

Property Type:	House
Build Form:	Mid-Terrace
Transaction Type:	Marketed sale
Energy Tariff:	Single
Main Fuel:	Mains gas (not community)
Main Gas:	Yes
Flat Top Storey:	No
Top Storey:	0
Glazing Type:	Double glazing, unknown install date
Previous Extension:	2
Open Fireplace:	3
Ventilation:	Natural
Walls:	Solid brick, as built, no insulation (assumed)
Walls Energy:	Poor
Roof:	Pitched, 150 mm loft insulation
Roof Energy:	Good
Main Heating:	Boiler and radiators, mains gas
Main Heating Controls:	Programmer, room thermostat and TRVs
Hot Water System:	From main system
Hot Water Energy Efficiency:	Good
Lighting:	Low energy lighting in 46% of fixed outlets
Floors:	Suspended, no insulation (assumed)
Total Floor Area:	115 m ²

This map displays nearby coal mine entrances and their classifications.



Mine Entry

- ✕ Adit
- ✕ Gutter Pit
- ✕ Shaft

The Coal Authority has records of over 175,000 mine entries within the UK captured in the National Coal Mining database, derived from sources including abandonment plans, geological and topographical plans.

Coal mining activity is recorded as far back as the 13th century, but prior to 1872 there was no requirement to deposit abandonment plans. It is therefore believed there may be many unrecorded mine entries of which the Authority has no information or knowledge. These entries do not, therefore, appear within the Authority's national dataset as shown on this map.

Maps

Conservation Areas



This map displays nearby official conservation areas. Every local authority in England has at least one conservation area. Most are designated by the Council as the local planning authority, though Historic England and the Secretary of State also have the power to create them.

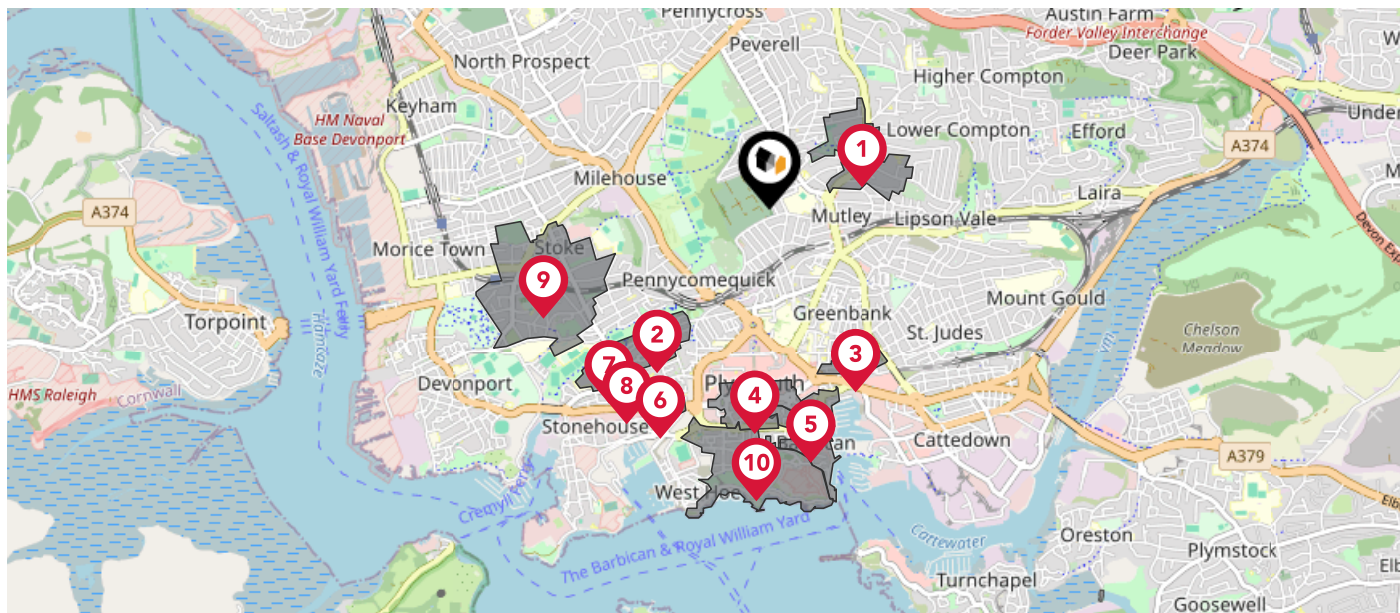







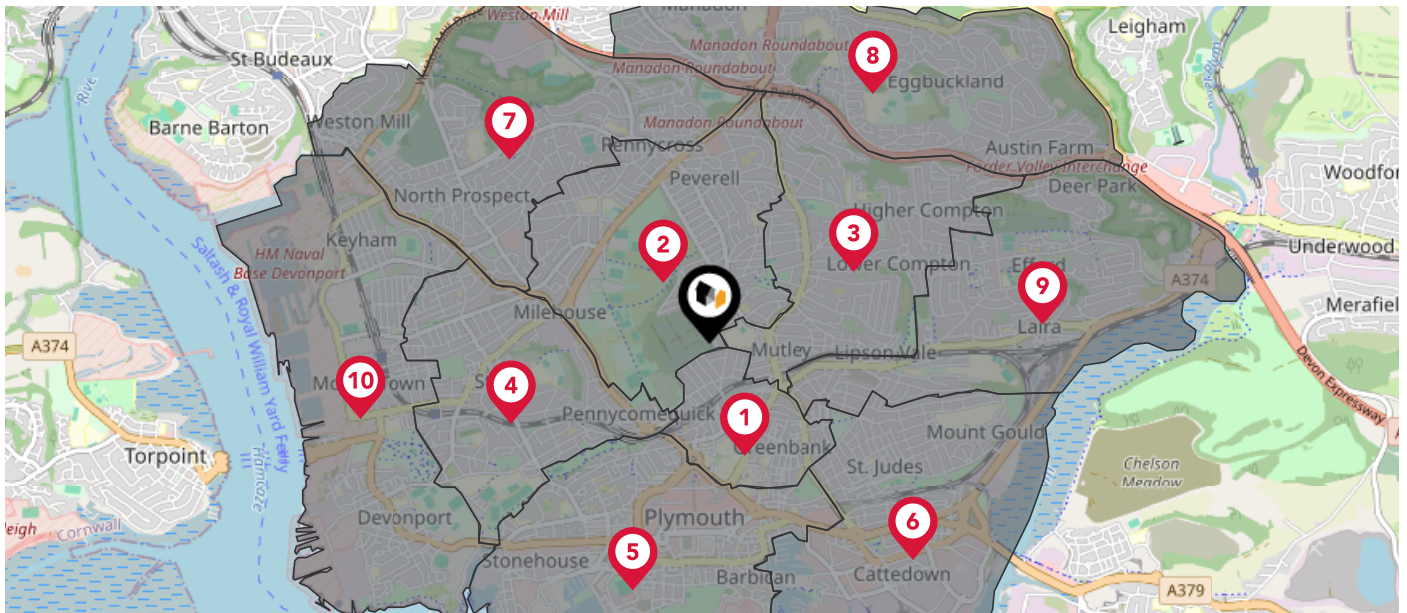



Nearby Conservation Areas

- 1 Mannamead
- 2 North Stonehouse
- 3 Ebrington Street
- 4 City Centre
- 5 Barbican
- 6 Union Street
- 7 Royal Naval Hospital
- 8 Adelaide Street/Clarence Place
- 9 Stoke
- 10 The Hoe

The UK is divided into wards that are used for local elections to elect local government councillors. Sometimes these are known as 'electoral divisions'. Population counts can vary substantially between wards, but the national average is about 5,500



Nearby Council Wards

-  Drake Ward
-  Peverell Ward
-  Compton Ward
-  Stoke Ward
-  St. Peter and the Waterfront Ward
-  Sutton and Mount Gould Ward
-  Ham Ward
-  Egguckland Ward
-  Efford and Lipson Ward
-  Devonport Ward

This map displays the noise levels from nearby network rail and HS1 railway routes that affect this property...

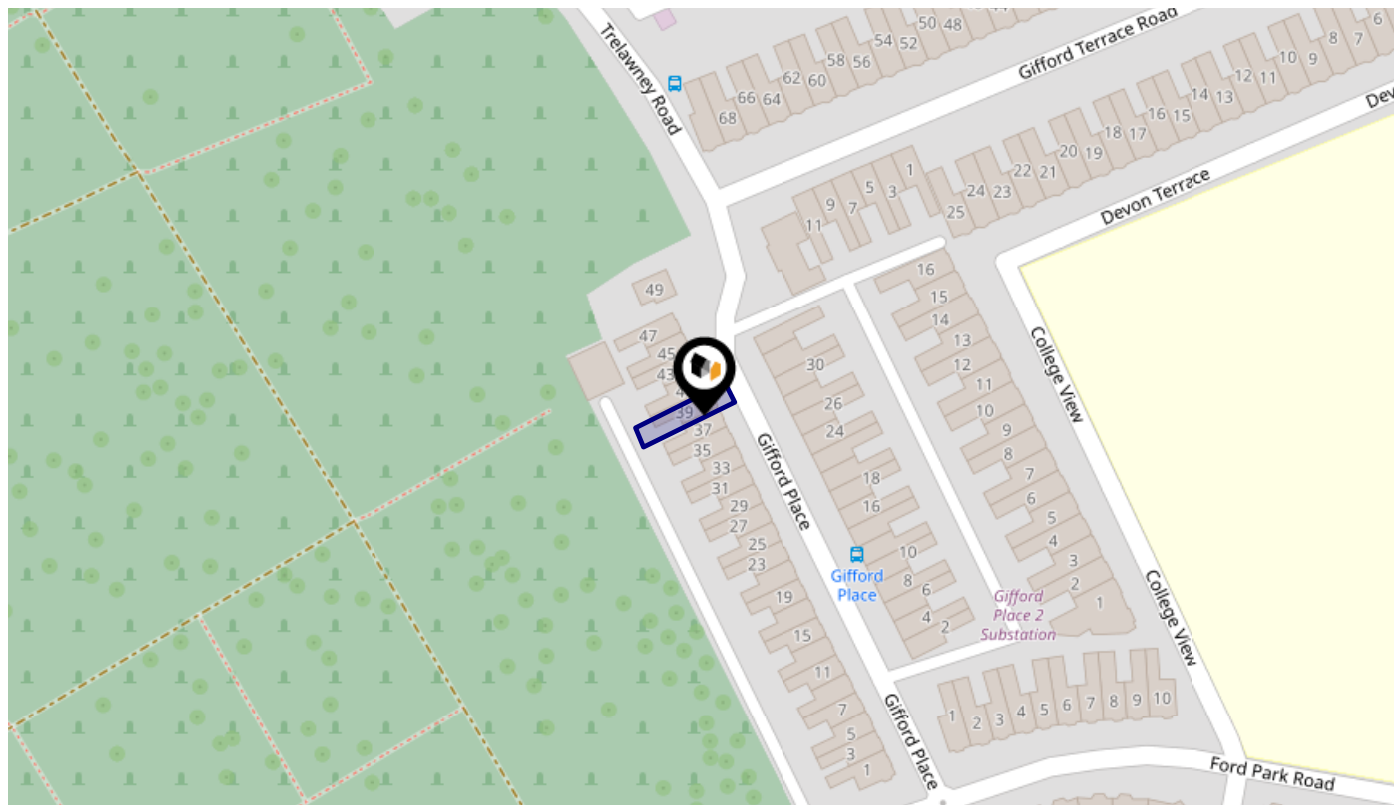

Rail Noise Data

This data indicates the level of noise according to the strategic noise mapping of rail sources within areas with a population of at least 100,000 people (agglomerations) and along Network Rail and HS1 traffic routes.

The data indicates the annual average noise levels for the 16-hour period between 0700 - 2300.

Noise levels are modelled on a 10m grid at a receptor height of 4m above ground, polygons are then produced by merging neighbouring cells within the following noise classes:

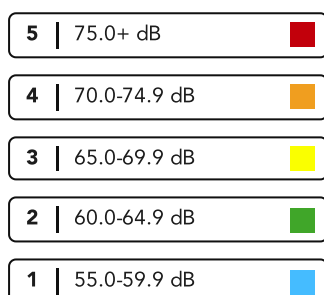

Flood Risk

Rivers & Seas - Flood Risk



This map shows the chance of flooding from rivers and / or the sea, taking into account flood defences and their condition.

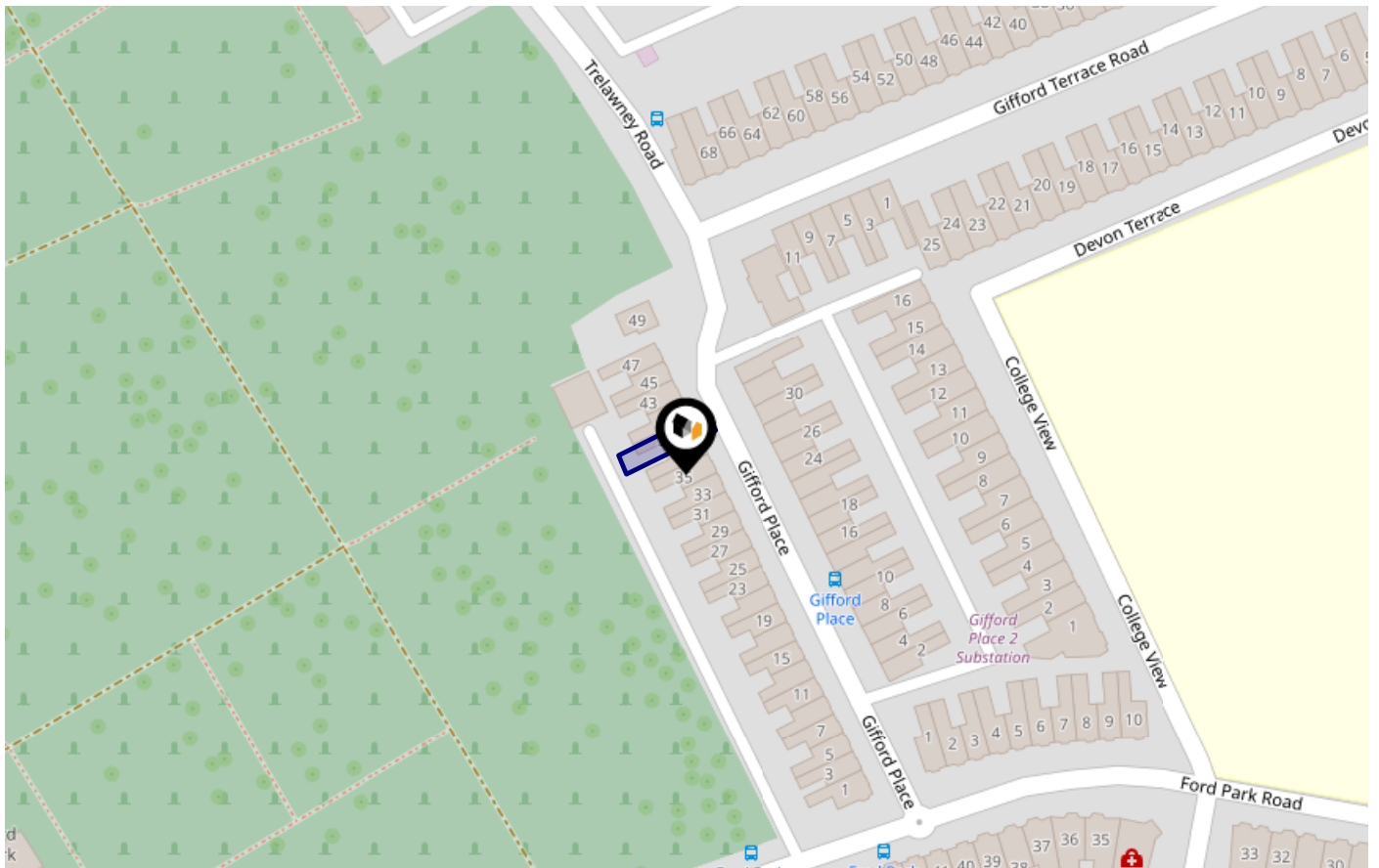

Risk Rating: Very low

The map does not contain sufficient information for it to be used to determine flood risk to individual properties, but it does give you an indication of whether your area may be affected by surface water flooding at this risk level.

- **High Risk** - an area which has a chance of flooding of greater than 1 in 30 (3.3%) in any one year.
- **Medium Risk** - an area which has a chance of flooding of greater than 1 in 100 (1.0%) in any one year.
- **Low Risk** - an area which has a chance of flooding of greater than 1 in 1000 (0.1%) in any one year.
- **Very Low Risk** - an area in which the risk is below 1 in 1000 (0.1%) in any one year.

Chance of flooding to the following depths at this property:



Flood Risk

Rivers & Seas - Climate Change



This map shows the future chance of flooding from rivers and / or the sea **between 2036 and 2069**, taking into account flood defences and their condition. The government climate change models cannot predict exactly when the chance of flooding will go up. It could happen at any time during the time period.

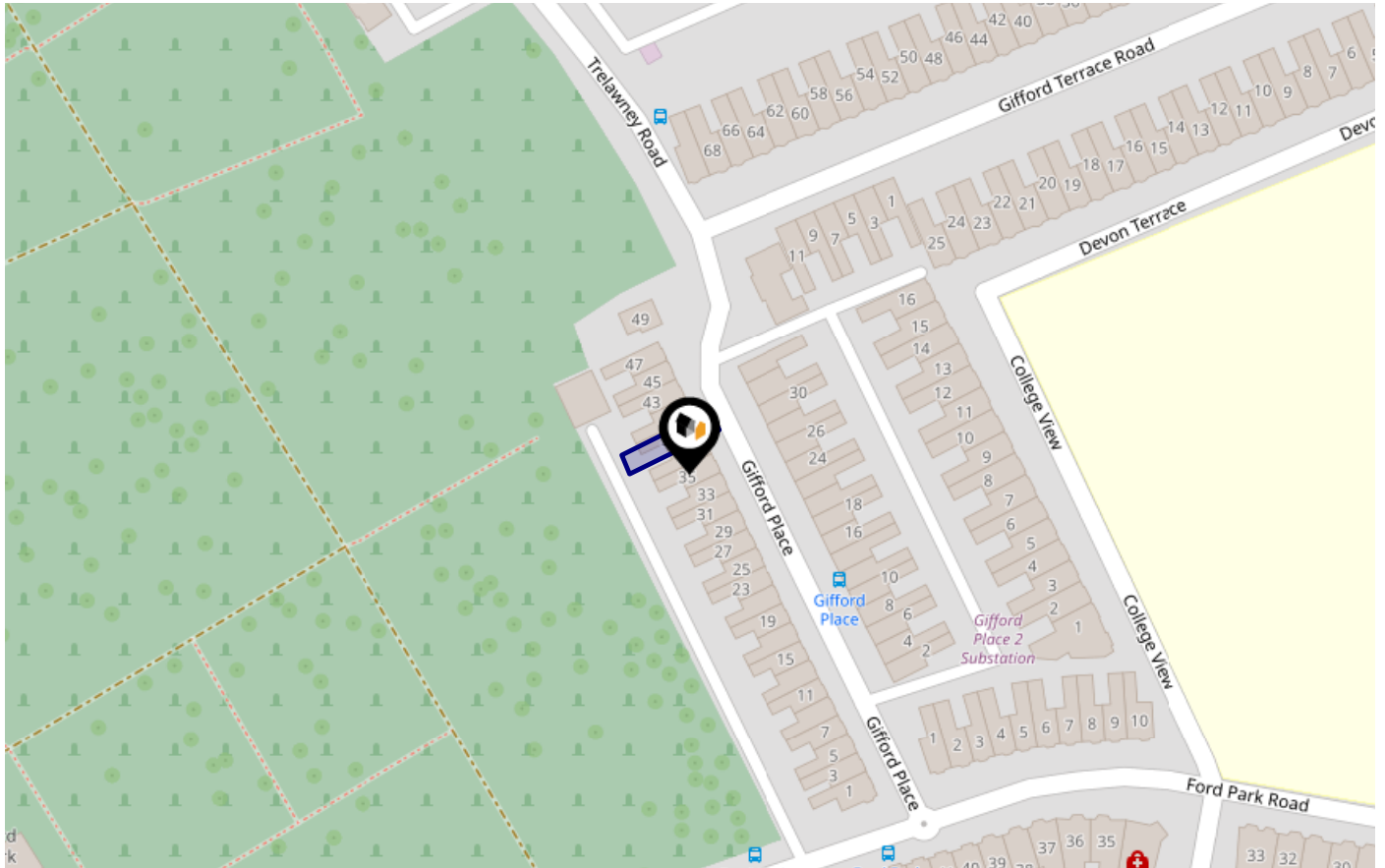

Risk Rating: Very low

The map does not contain sufficient information for it to be used to determine flood risk to individual properties, but it does give you an indication of whether your area may be affected by surface water flooding at this risk level.

- **High Risk** - an area which has a chance of flooding of greater than 1 in 30 (3.3%) in any one year.
- **Medium Risk** - an area which has a chance of flooding of greater than 1 in 100 (1.0%) in any one year.
- **Low Risk** - an area which has a chance of flooding of greater than 1 in 1000 (0.1%) in any one year.
- **Very Low Risk** - an area in which the risk is below 1 in 1000 (0.1%) in any one year.

Chance of flooding to the following depths at this property:



Flood Risk

Surface Water - Flood Risk



This map shows the chance of flooding where rainwater has nowhere to drain. This kind of flooding can occur far from rivers or seas.

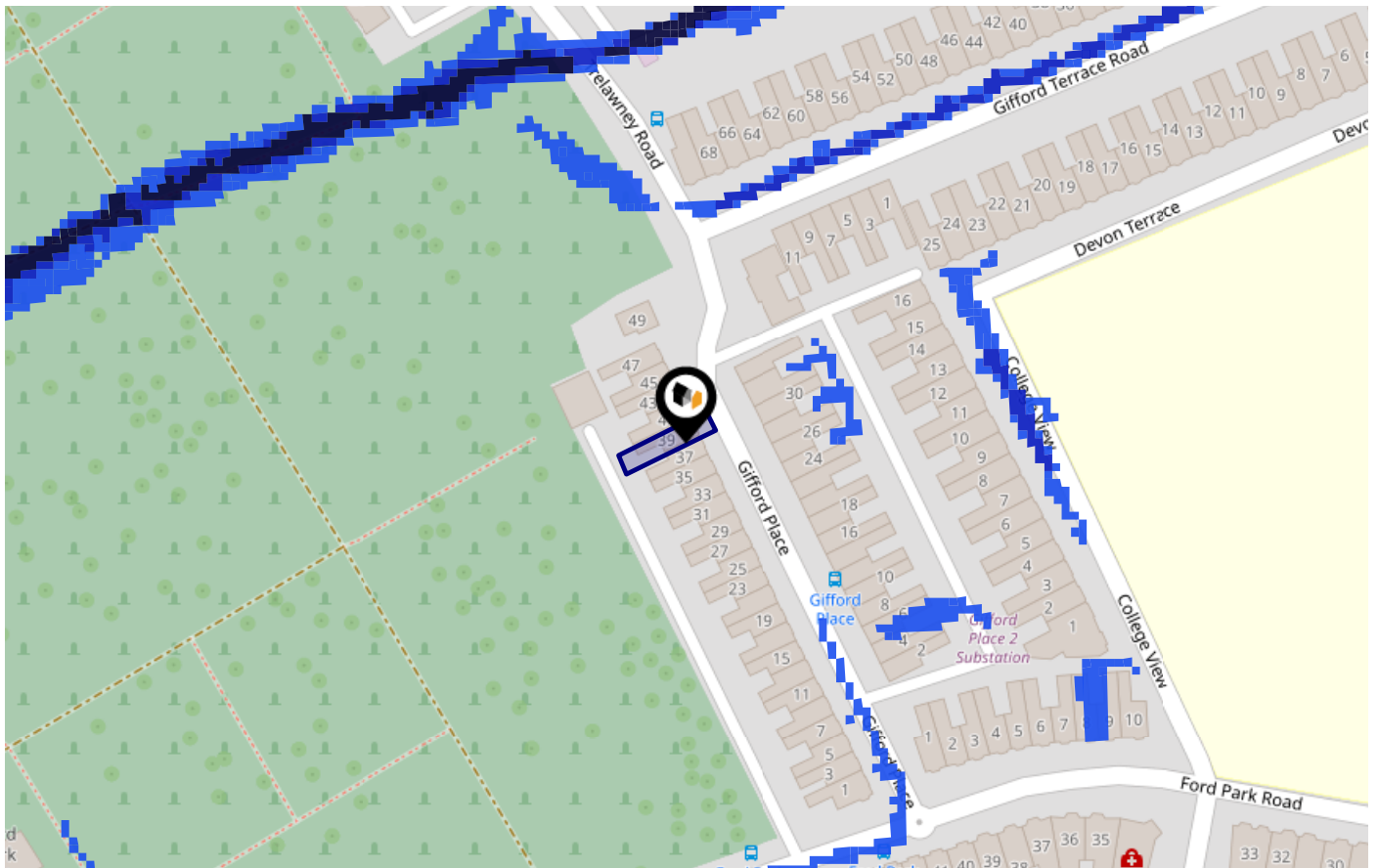

Risk Rating: Very low

The map does not contain sufficient information for it to be used to determine flood risk to individual properties, but it does give you an indication of whether your area may be affected by surface water flooding at this risk level.

- High Risk** - an area which has a chance of flooding of greater than 1 in 30 (3.3%) in any one year.
- Medium Risk** - an area which has a chance of flooding of greater than 1 in 100 (1.0%) in any one year.
- Low Risk** - an area which has a chance of flooding of greater than 1 in 1000 (0.1%) in any one year.
- Very Low Risk** - an area in which the risk is below 1 in 1000 (0.1%) in any one year.

Chance of flooding to the following depths at this property:



Flood Risk

Surface Water - Climate Change



This map shows the future chance of flooding **between 2040 and 2060** where rainwater has nowhere to drain. This kind of flooding can occur far from rivers or seas. The government climate change models cannot predict exactly when the chance of flooding will go up. It could happen at any time during the time period.

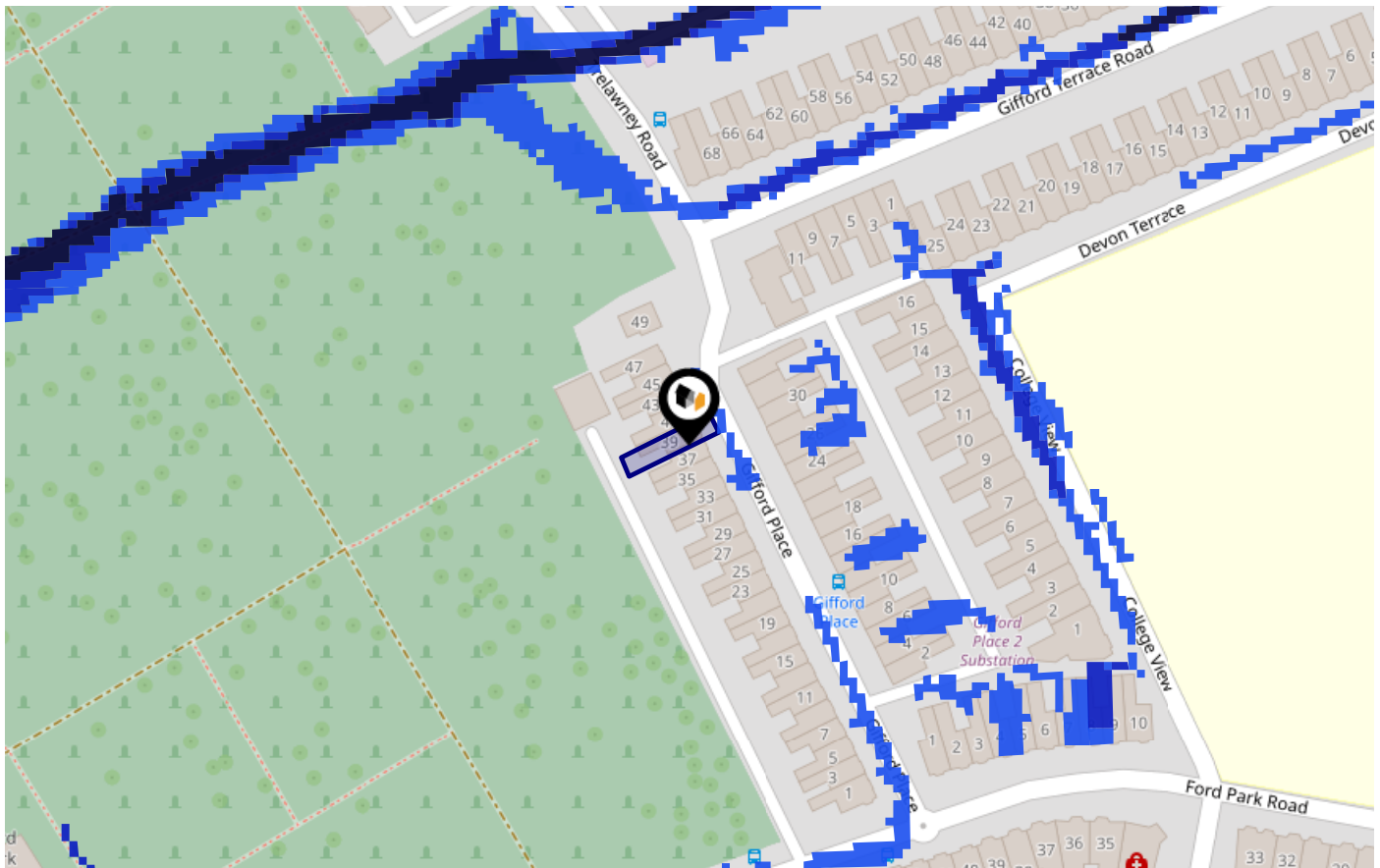

Risk Rating: **Very low**

The map does not contain sufficient information for it to be used to determine flood risk to individual properties, but it does give you an indication of whether your area may be affected by surface water flooding at this risk level.

- High Risk** - an area which has a chance of flooding of greater than 1 in 30 (3.3%) in any one year.
- Medium Risk** - an area which has a chance of flooding of greater than 1 in 100 (1.0%) in any one year.
- Low Risk** - an area which has a chance of flooding of greater than 1 in 1000 (0.1%) in any one year.
- Very Low Risk** - an area in which the risk is below 1 in 1000 (0.1%) in any one year.

Chance of flooding to the following depths at this property:



This map displays nearby areas that have been designated as Green Belt...

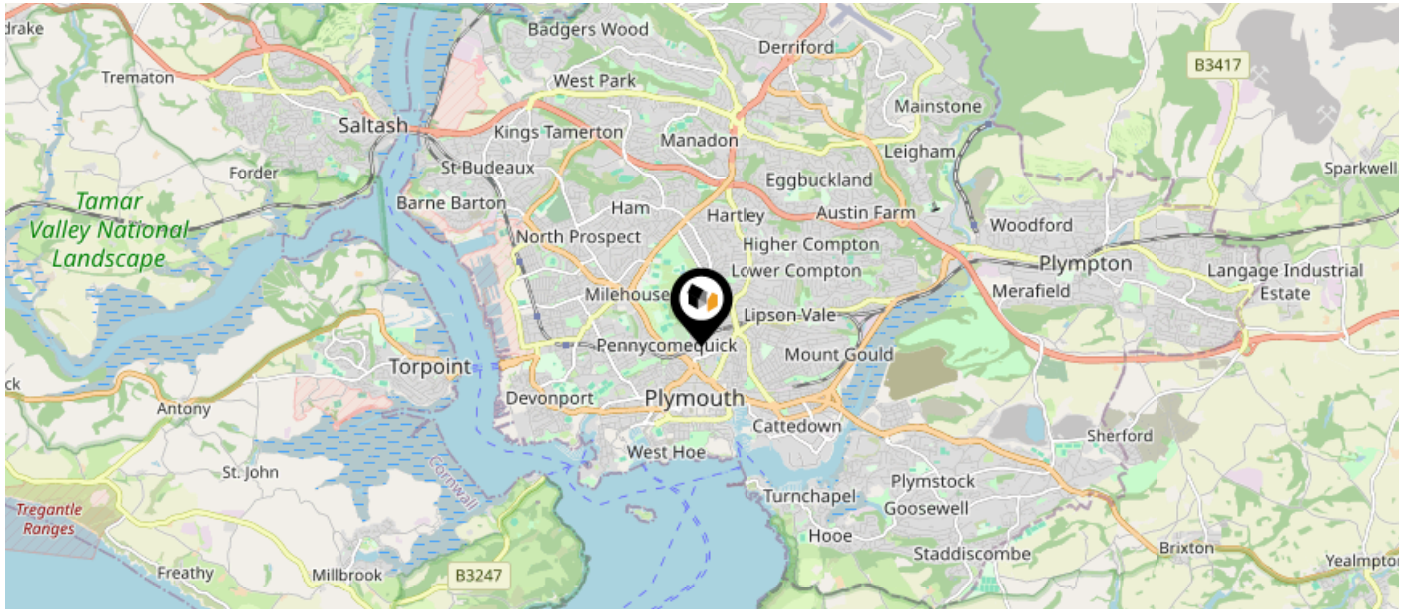

Nearby Green Belt Land

No data available.

Maps

Landfill Sites

This map displays the location of known landfill sites. Historic sites are where there is no environmental permit in force. Active sites are currently authorised by the Environment Agency under Environmental Permitting Regulations.

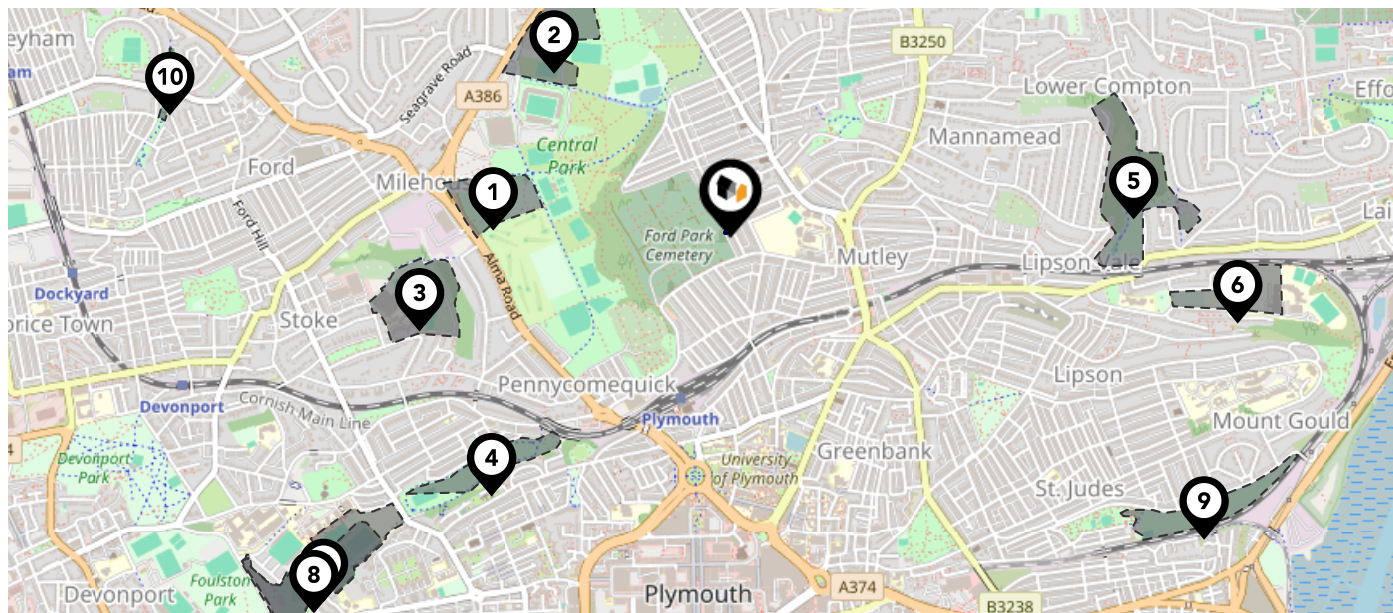

Nearby Landfill Sites





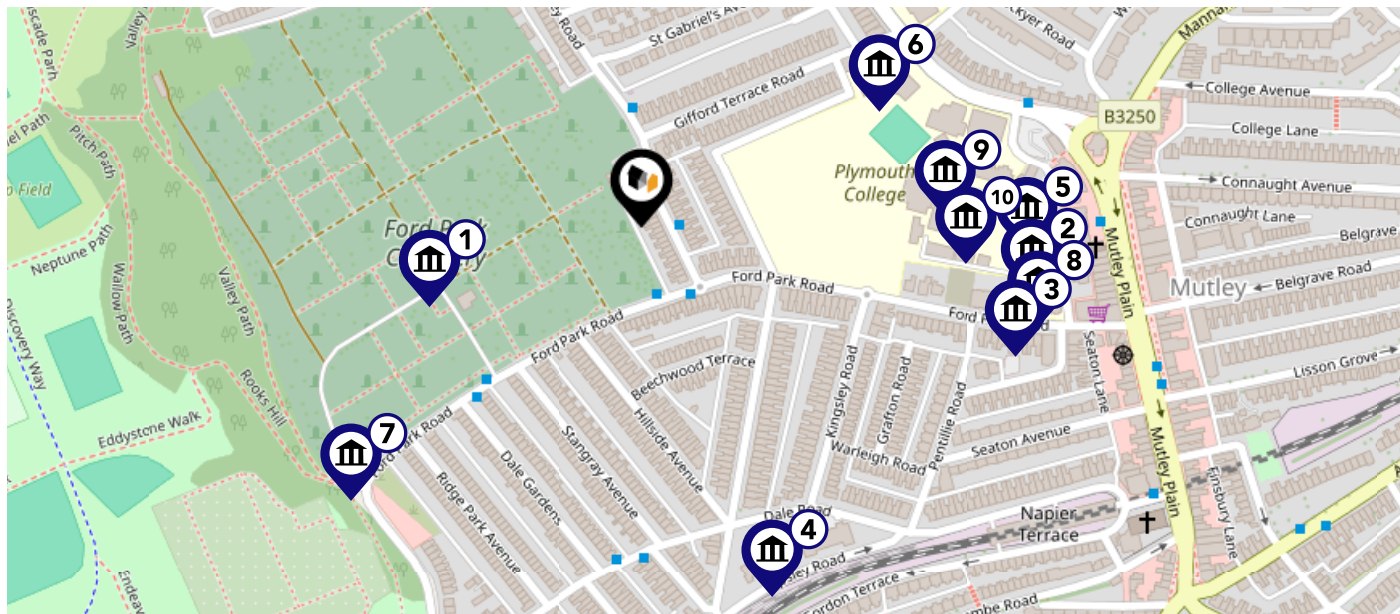

1	Central Park Milehouse-Central Park (Milehouse), Plymouth	Historic Landfill
2	Peverell Cricket Ground-Peverell Cricket Ground, Plymouth	Historic Landfill
3	Stoke School Playing Field And Allotments-Stoke School Playing Field And Allotments, Plymouth	Historic Landfill
4	Victoria Park-Victoria Park, Plymouth	Historic Landfill
5	Lower Compton-Lipson Vale, Plymouth	Historic Landfill
6	Laira Lipson College-Laira, Plymouth	Historic Landfill
7	Stonehouse Lake-Plymouth, Devon	Historic Landfill
8	Stonehouse Playing Fields-Stonehouse Playing Fields, Stonehouse, Plymouth, Devon	Historic Landfill
9	Tothill Park Recreation Ground-Tothill Park Recreation Ground Mount Gold/Laira, Plymouth	Historic Landfill
10	Disused Railway Cutting-North Down, Devonport, Plymouth	Historic Landfill

Maps

Listed Buildings

This map displays nearby listed buildings and protected structures, as well as their listed tier and distance from the target property...



Listed Buildings in the local district		Grade	Distance
	1407641 - Church Of England Chapel At Ford Park Cemetery	Grade II	0.1 miles
	1244523 - 6, 8 (college House) And 10, Ford Park	Grade II	0.2 miles
	1244528 - Gate Piers And Flanking Walls To South East Entrance	Grade II	0.2 miles
	1129984 - Royal Eye Infirmary	Grade II	0.2 miles
	1244524 - 12 And 14, Ford Park	Grade II	0.2 miles
	1322004 - Plymouth College	Grade II	0.2 miles
	1244418 - South West Lodge And Walls And Railings At Plymouth Devonport And Stonehouse Cemetery	Grade II	0.2 miles
	1244522 - 2 And 4, Ford Park	Grade II	0.2 miles
	1244525 - 1 And 2, Shaftesbury Villas	Grade II	0.2 miles
	1244526 - The Headmaster's House	Grade II	0.2 miles

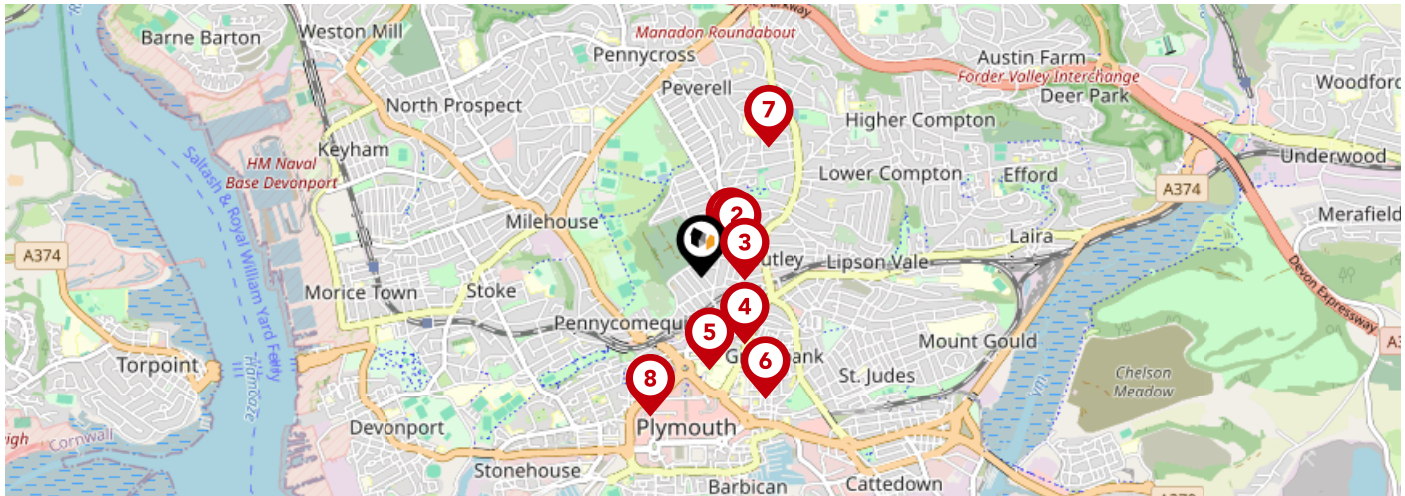

		Nursery	Primary	Secondary	College	Private
1	Hyde Park Junior School Ofsted Rating: Good Pupils: 355 Distance:0.19	<input type="checkbox"/>	<input checked="" type="checkbox"/>	<input type="checkbox"/>	<input type="checkbox"/>	<input type="checkbox"/>
2	Hyde Park Infants' School Ofsted Rating: Not Rated Pupils: 243 Distance:0.2	<input type="checkbox"/>	<input checked="" type="checkbox"/>	<input type="checkbox"/>	<input type="checkbox"/>	<input type="checkbox"/>
3	Plymouth College Ofsted Rating: Not Rated Pupils: 513 Distance:0.2	<input type="checkbox"/>	<input type="checkbox"/>	<input checked="" type="checkbox"/>	<input type="checkbox"/>	<input type="checkbox"/>
4	Plymouth High School for Girls Ofsted Rating: Good Pupils: 816 Distance:0.38	<input type="checkbox"/>	<input type="checkbox"/>	<input checked="" type="checkbox"/>	<input type="checkbox"/>	<input type="checkbox"/>
5	Fletewood School at Derry Villas Ofsted Rating: Good Pupils: 58 Distance:0.44	<input type="checkbox"/>	<input checked="" type="checkbox"/>	<input type="checkbox"/>	<input type="checkbox"/>	<input type="checkbox"/>
6	Mount Street Primary School Ofsted Rating: Good Pupils: 258 Distance:0.65	<input type="checkbox"/>	<input checked="" type="checkbox"/>	<input type="checkbox"/>	<input type="checkbox"/>	<input type="checkbox"/>
7	King's School Ofsted Rating: Not Rated Pupils: 298 Distance:0.69	<input type="checkbox"/>	<input checked="" type="checkbox"/>	<input type="checkbox"/>	<input type="checkbox"/>	<input type="checkbox"/>
8	Pilgrim Primary Academy Ofsted Rating: Outstanding Pupils: 390 Distance:0.7	<input type="checkbox"/>	<input checked="" type="checkbox"/>	<input type="checkbox"/>	<input type="checkbox"/>	<input type="checkbox"/>

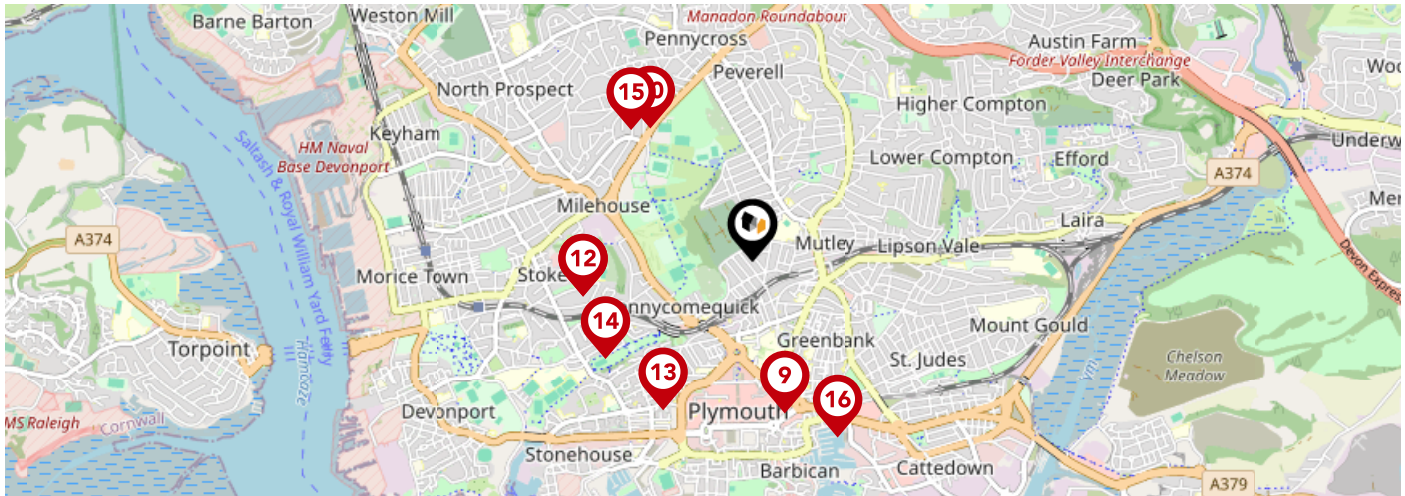

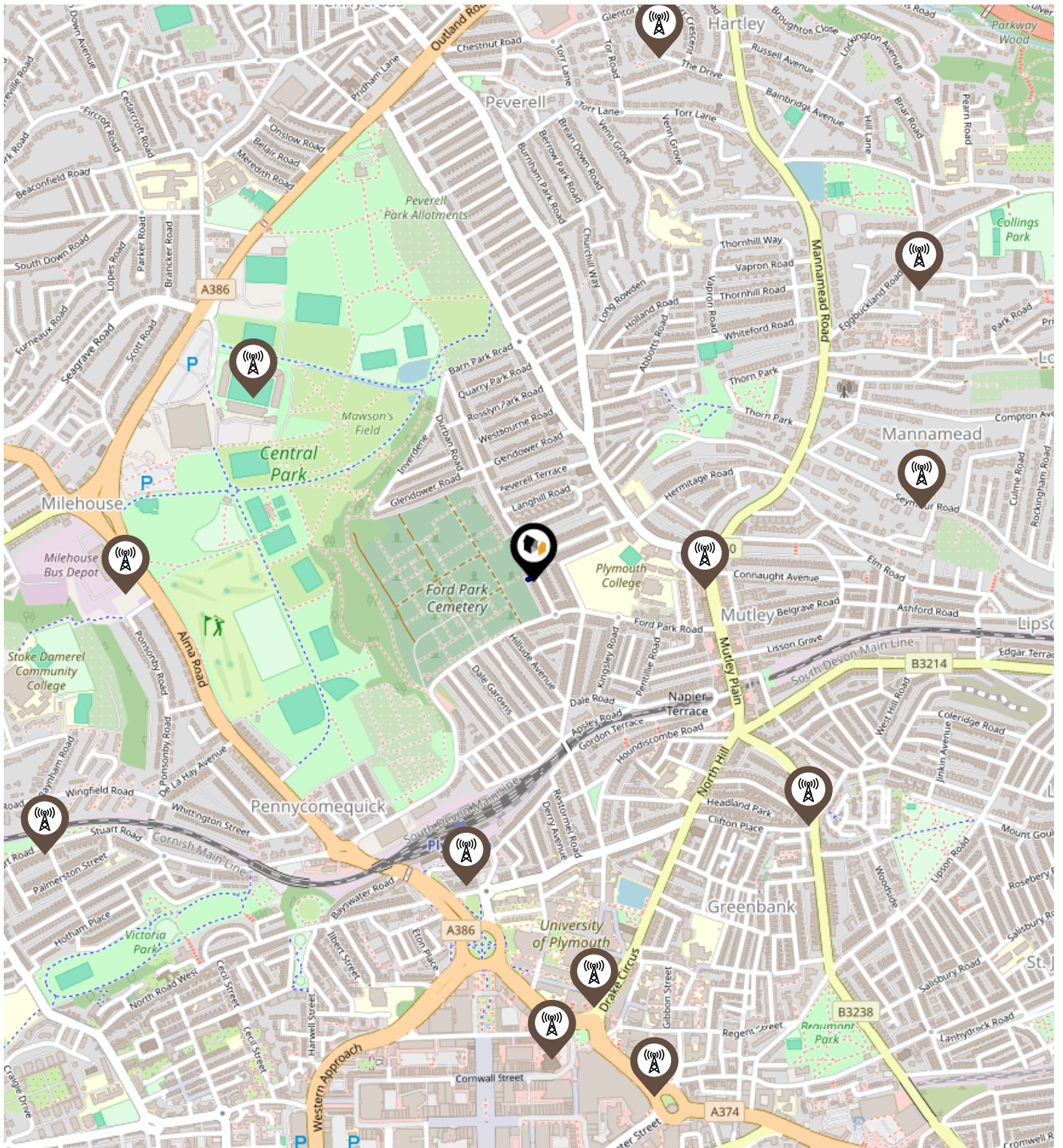

	Nursery	Primary	Secondary	College	Private
9 Arts University Plymouth Ofsted Rating: Good Pupils:0 Distance:0.73	<input type="checkbox"/>	<input type="checkbox"/>	<input checked="" type="checkbox"/>	<input type="checkbox"/>	<input type="checkbox"/>
10 Devonport High School for Girls Ofsted Rating: Good Pupils: 860 Distance:0.8	<input type="checkbox"/>	<input type="checkbox"/>	<input checked="" type="checkbox"/>	<input type="checkbox"/>	<input type="checkbox"/>
11 Scott Medical and Healthcare College Ofsted Rating: Good Pupils: 233 Distance:0.83	<input type="checkbox"/>	<input type="checkbox"/>	<input checked="" type="checkbox"/>	<input type="checkbox"/>	<input type="checkbox"/>
12 Stoke Damerel Community College Ofsted Rating: Good Pupils: 1301 Distance:0.83	<input type="checkbox"/>	<input type="checkbox"/>	<input checked="" type="checkbox"/>	<input type="checkbox"/>	<input type="checkbox"/>
13 The Cathedral School of St Mary Ofsted Rating: Requires improvement Pupils: 109 Distance:0.83	<input type="checkbox"/>	<input checked="" type="checkbox"/>	<input type="checkbox"/>	<input type="checkbox"/>	<input type="checkbox"/>
14 Stuart Road Primary Academy Ofsted Rating: Good Pupils: 189 Distance:0.84	<input type="checkbox"/>	<input checked="" type="checkbox"/>	<input type="checkbox"/>	<input type="checkbox"/>	<input type="checkbox"/>
15 Montpelier Primary School Ofsted Rating: Good Pupils: 652 Distance:0.85	<input type="checkbox"/>	<input checked="" type="checkbox"/>	<input type="checkbox"/>	<input type="checkbox"/>	<input type="checkbox"/>
16 Holy Cross Catholic Primary School Ofsted Rating: Good Pupils: 306 Distance:0.92	<input type="checkbox"/>	<input checked="" type="checkbox"/>	<input type="checkbox"/>	<input type="checkbox"/>	<input type="checkbox"/>

Local Area Masts & Pylons



Key:

-  Power Pylons
-  Communication Masts

What is Radon?

Radon is a natural radioactive gas, which enters buildings from the ground. Exposure to high concentrations increases the risk of lung cancer. The UK Health Security Agency (UKHSA) recommends that radon levels should be reduced in homes where the annual average is at or above 200 becquerels per cubic metre (200 Bq/m³).

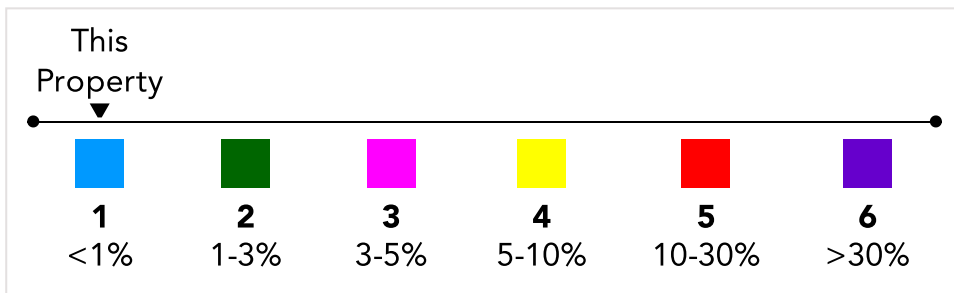
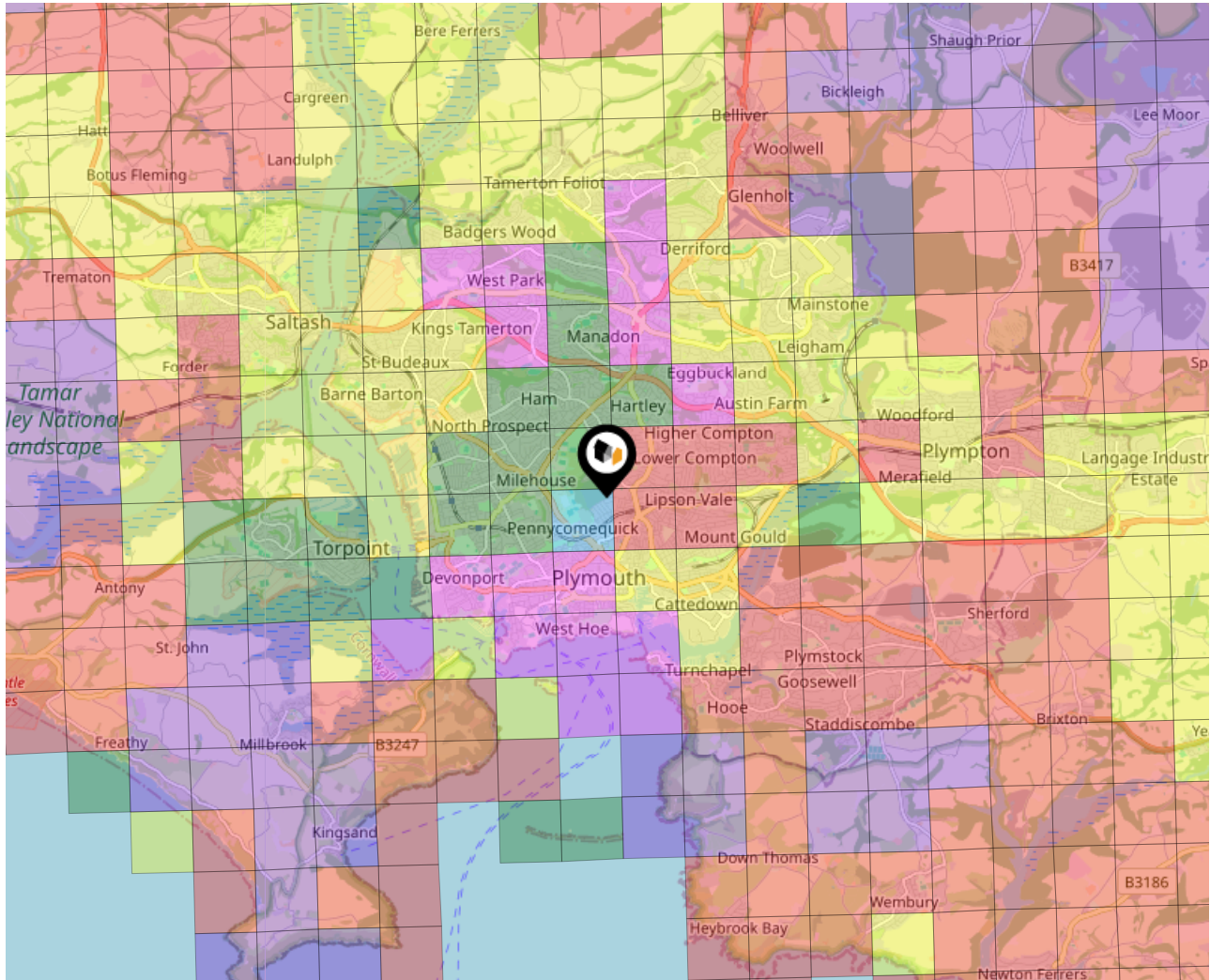

Local Area Road Noise

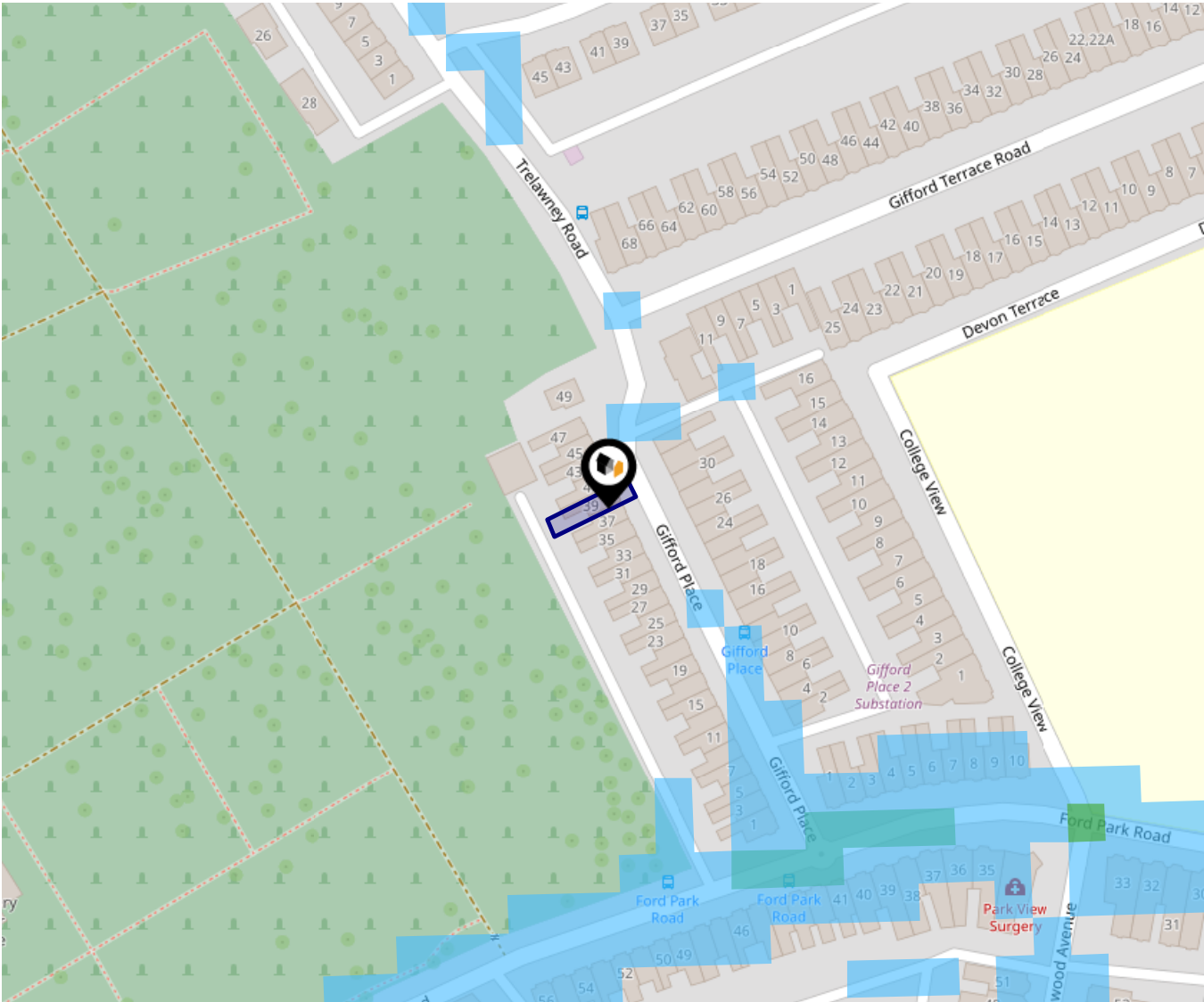

The data indicates the level of noise according to strategic noise sources across all traffic routes. This indicates a 25 house annual average noise level with separate weightings for the evening and the night periods.

- 75.0+ dB
- 70.0-74.9 dB
- 65.0-69.9 dB
- 60.0-64.9 dB
- 55.0-59.9 dB

Ground Composition for this Address (Surrounding square kilometer zone around property)

Carbon Content:	NONE	Soil Texture:	LOAM TO SILTY LOAM
Parent Material Grain:	ARGILLACEOUS	Soil Depth:	INTERMEDIATE-SHALLOW
Soil Group:	MEDIUM TO LIGHT(SILTY) TO HEAVY		

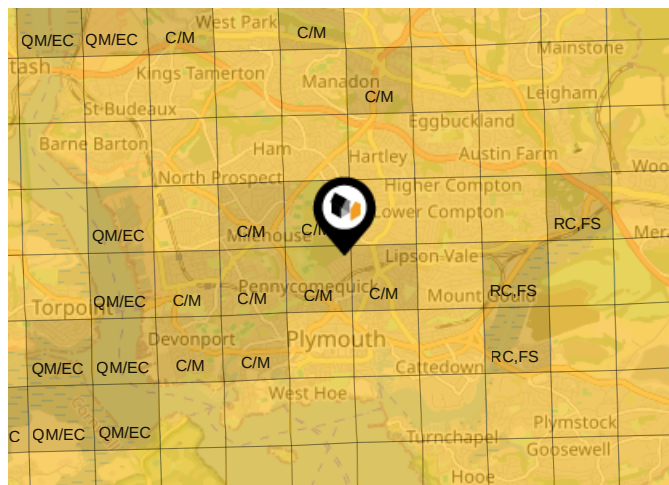

Primary Classifications (Most Common Clay Types)

C/M	Claystone / Mudstone
FPC,S	Floodplain Clay, Sand / Gravel
FC,S	Fluvial Clays & Silts
FC,S,G	Fluvial Clays, Silts, Sands & Gravel
PM/EC	Prequaternary Marine / Estuarine Clay / Silt
QM/EC	Quaternary Marine / Estuarine Clay / Silt
RC	Residual Clay
RC/LL	Residual Clay & Loamy Loess
RC,S	River Clay & Silt
RC,FS	Riverine Clay & Floodplain Sands and Gravel
RC,FL	Riverine Clay & Fluvial Sands and Gravel
TC	Terrace Clay
TC/LL	Terrace Clay & Loamy Loess

Area Transport (National)

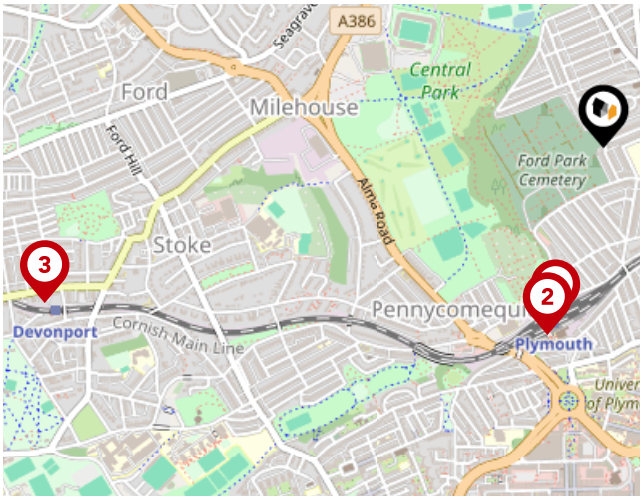

National Rail Stations

Pin	Name	Distance
1	Plymouth Rail Station	0.43 miles
2	Plymouth Rail Station	0.46 miles
3	Devonport Rail Station	1.37 miles

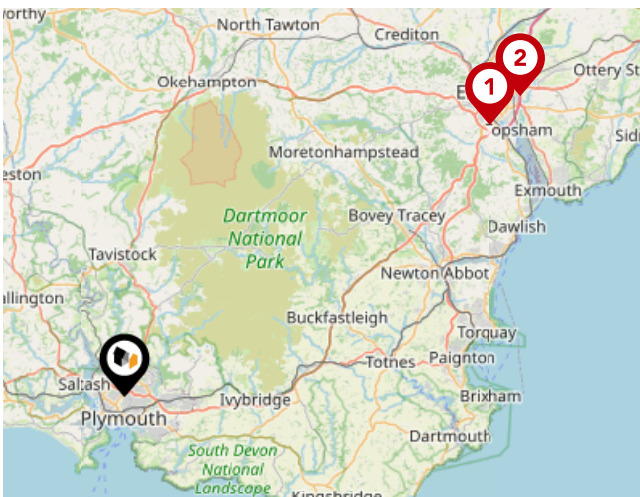

Trunk Roads/Motorways

Pin	Name	Distance
1	M5 J31	34.3 miles
2	M5 J30	37.44 miles

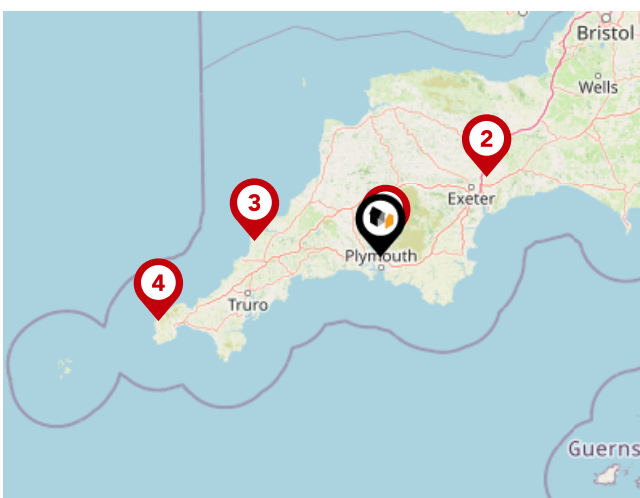

Airports/Helipads

Pin	Name	Distance
1	Glenholt	3 miles
2	Exeter Airport	39.87 miles
3	St Mawgan	38.36 miles
4	Joppa	70.29 miles

Area Transport (Local)

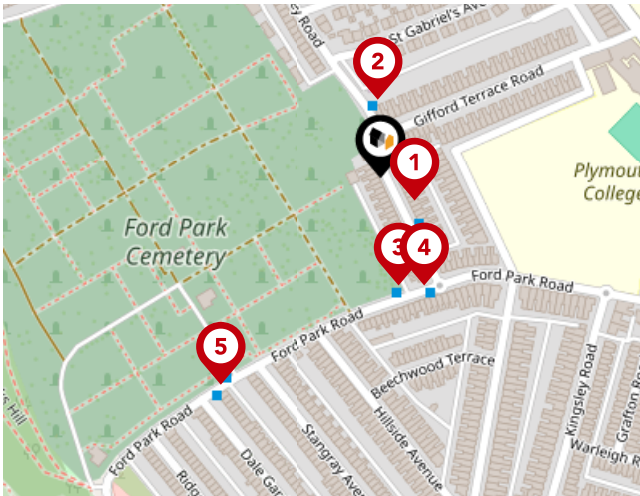

Bus Stops/Stations

Pin	Name	Distance
1	Gifford Place	0.02 miles
2	Gifford Terrace	0.05 miles
3	Ford Park Road	0.06 miles
4	Ford Park Road	0.07 miles
5	Dale Gardens	0.15 miles

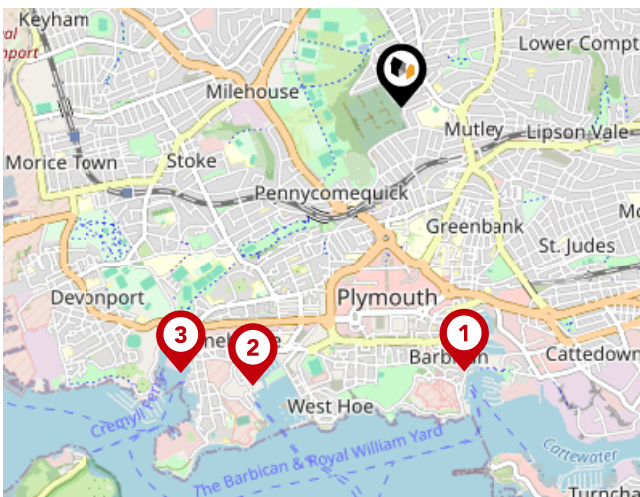

Ferry Terminals

Pin	Name	Distance
1	Plymouth (Barbican) Landing Stage	1.29 miles
2	Plymouth Ferry Terminal	1.49 miles
3	Plymouth Stonehouse Ferry Terminal	1.63 miles

Lang Town & Country Data Quality

We are committed to comprehensive property data being made available upfront to make the home buying and selling process quicker, easier and cheaper. This is why we have partnered with Sprift, the UK's leading supplier of property-specific data.



Contains public sector information licensed under the Open Government License v3.0

The information contained within this report is for general information purposes only.

Sprift Technologies Ltd aggregate this data from a wide variety of sources and while we endeavour to keep the information up to date and correct, we make no representations or warranties of any kind, express or implied, about the completeness, accuracy, reliability, of the information or related graphics contained within this report for any purpose.

Any reliance you place on such information is therefore strictly at your own risk. In no event will we be liable for any loss or damage including without limitation, indirect or consequential loss or damage, or any loss or damage whatsoever arising from loss of data or profits arising out of, or in connection with, the use of this report.



Lang Town & Country

6 Mannamead Road, Plymouth, PL4 7AA

01752 456000

carrie@langtownandcountry.com

www.langtownandcountry.com

