



43121 Charlton Green, Dover, CT16 1AP
£2,470 Per month



43121 Charlton Green, Dover, CT16 1AP

£2,470 Per month

Elkington House is a purpose-built Retirement Living Plus development by McCarthy & Stone, designed for the over-70s who want to live independently with the reassurance of extra care and support on hand.

An Estate Manager and team oversee the day-to-day running of the development. Communal facilities include a residents' lounge hosting regular social events, a wellness suite, landscaped gardens, a fully equipped laundry room and an on-site bistro serving breakfast and lunch daily. A hotel-style guest suite is also available to book for visiting friends and family.

For peace of mind, a 24-hour emergency call system operates via a personal pendant and call points in the bedroom and bathroom, backed by on-site management around the clock. One hour of domestic support per week is included in the service charge, with additional care and support available from as little as 15 minutes per session - easily scaled up or down to suit your needs.

Description



Situation



Furnished
Council Tax Band:
Available:

Floor Plans

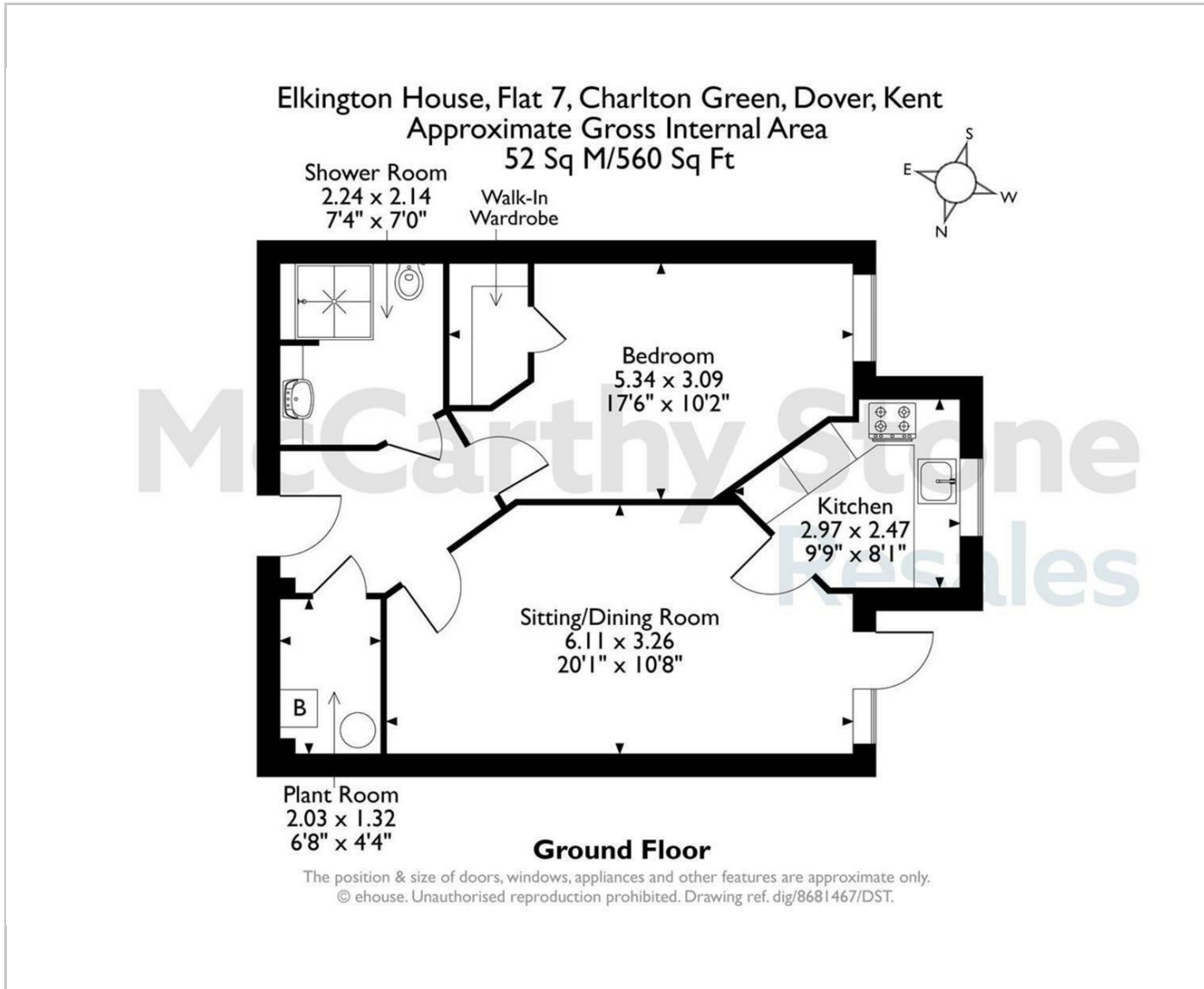

Area Map

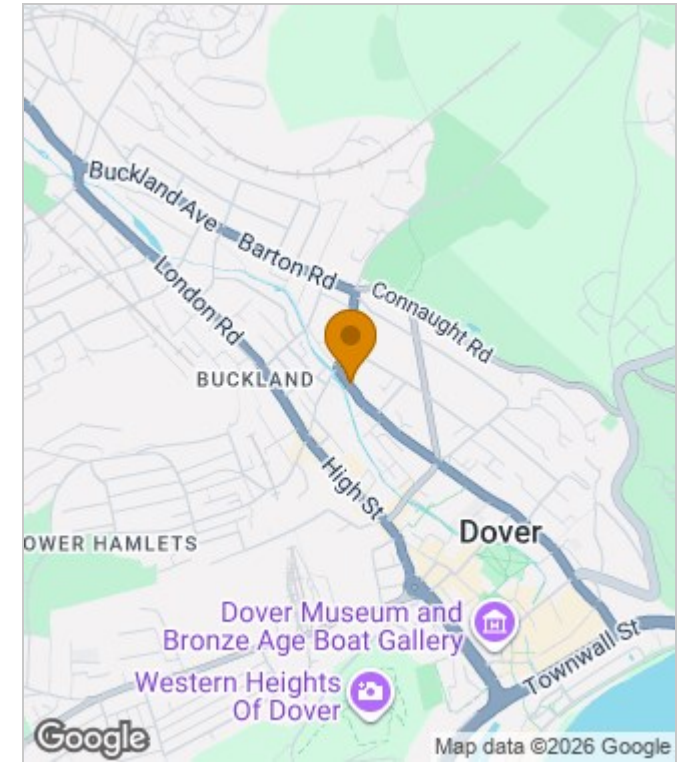

Energy Performance Graph

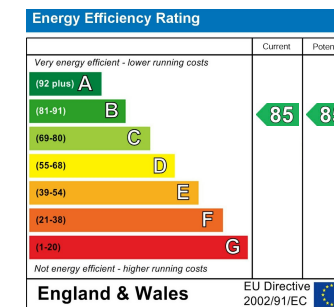

These particulars, whilst believed to be accurate are set out as a general outline only for guidance and do not constitute any part of an offer or contract. Intending purchasers should not rely on them as statements of representation of fact, but must satisfy themselves by inspection or otherwise as to their accuracy. No person in this firm's employment has the authority to make or give any representation or warranty in respect of the property.