

# Frank Harris & Co.



## Russell Court, WC1H

£250,000

Introducing a bright fifth-floor, south-facing studio apartment, this property benefits from lift access and a 24-hour concierge. Perfectly positioned in a central location, the property offers a comfortable and practical living space. Heating and hot water being included within the service charge.



Located in the heart of Bloomsbury, Russell Court is a short walk from the Brunswick Centre, offering access to restaurants, health and beauty stores, and a supermarket. A short walk to Russell Square, King's Cross and Euston station provides excellent transport links across London.

- South facing • Central location • 24 Hour Concierge •
- Share Of The Freehold • Lift Access • 5th Floor •



# Frank Harris & Co.

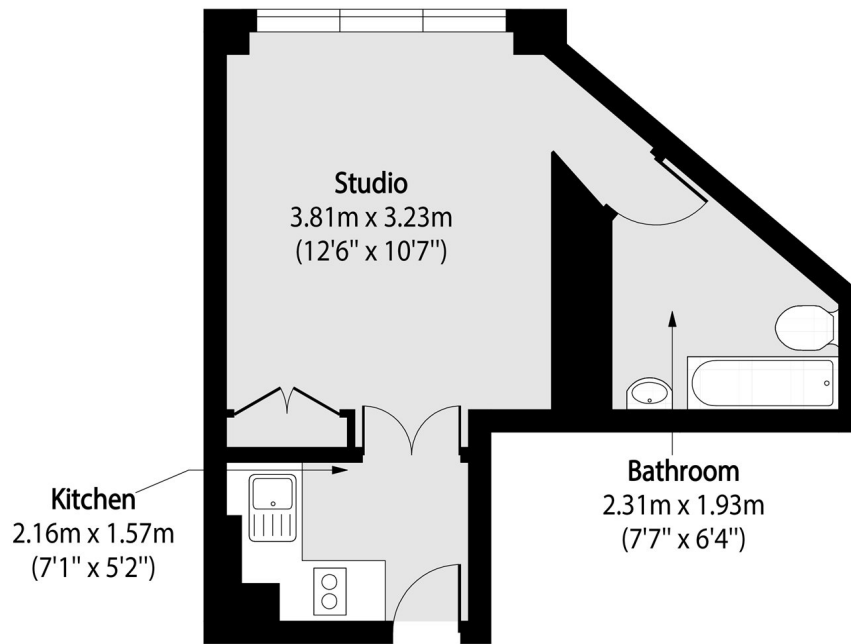

Total area (approx): 23.88 sq m (257 sq. ft)

Frank Harris & Co. Bloomsbury and Kings Cross

81 Marchmont Street,

London, WC1N 1AL

020 7405 4444

[bloomsburysales@frankharris.co.uk](mailto:bloomsburysales@frankharris.co.uk)

Energy Rating: . We aim to make our particulars both accurate and reliable. However they are not guaranteed; nor do they form part of an offer or contract. If you require clarification on any points then please contact us, especially if you're traveling some distance to view. Please note that appliances and heating systems have not been tested and therefore no warranties can be given as to their good working order.

