



**King Edward VII Apartments, Kings Drive, Midhurst**

Guide Price **£465,000**





**Bedrooms: 2**

**Bathrooms: 2**

**Receptions: 1**

Located on the ground floor of the main King Edward VII building no 16 boasts all the charm and elegance offered by this superb conversion by Award Winning Developers City & Country. This former Edwardian Hospital conversion is of the highest specification and within the restored main building is original parquet flooring, stunning lead light windows, original tiling and sympathetic William Morris wallpaper in communal corridors. There are even handy 'boot rooms' coming in from the gardens and walks where residents can leave muddy boots and garden chairs.

Once you step outside you are greeted by the south facing listed Edwardian Gardens designed by Gertrude Jekyll and featuring medicinal planting and the original stone step walkways. To the front of the main building one can walk towards Pine Walk taking you up to the National Trust Heathlands and viewing points all accessible within a stones throw from the front door, no need to get in the car to walk your dog.

The apartment is close to the main entrance as well as both resident boutique lounges, one is the former dining hall and is a superb place to relax with friends and family, the other the reading room has wonderful views of the gardens, a huge bookcase of books to share and superb wifi for home working and meeting friends.

The apartment comes with two superb allocated car parking spaces in the underground car park which is fully lit and has security cameras. There is also secure bike storage here for those enjoying the cycle trails through the woodlands around the estate.



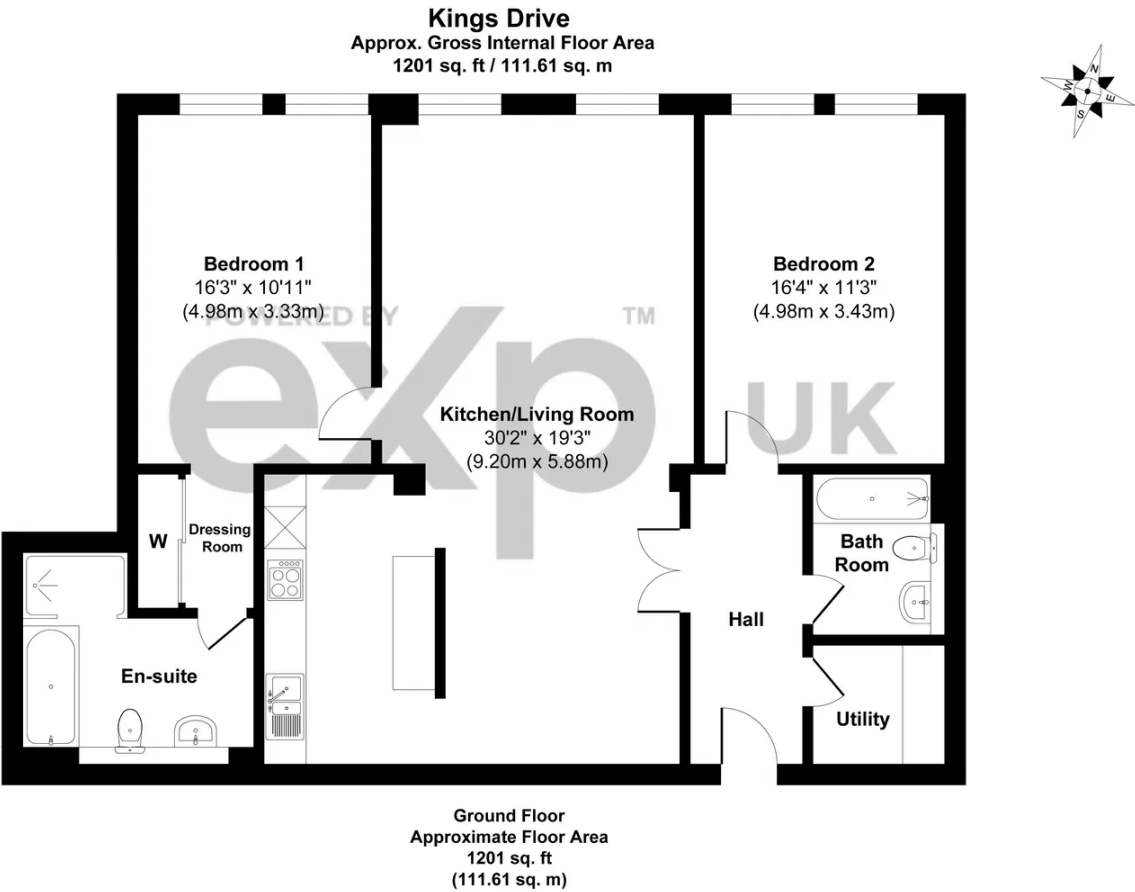

Whilst every attempt has been made to ensure the accuracy of the floorplan shown, all measurements, positioning Fixtures fittings and any other data shown are an approximate interpretation for illustrative purposes only and are not to scale. No responsibility is taken for any errors, omission, miss-statement or use of data show



**Bedrooms: 2**

**Bathrooms: 2**

**Receptions: 1**

Located on the ground floor of the main King Edward VII building no 16 boasts all the charm and elegance offered by this superb conversion by Award Winning Developers City & Country. This former Edwardian Hospital conversion is of the highest specification and within the restored main building is original parquet flooring, stunning lead light windows, original tiling and sympathetic William Morris wallpaper in communal corridors. There are even handy 'boot rooms' coming in from the gardens and walks where residents can leave muddy boots and garden chairs.

Once you step outside you are greeted by the south facing listed Edwardian Gardens designed by Gertrude Jekyll and featuring medicinal planting and the original stone step walkways. To the front of the main building one can walk towards Pine Walk taking you up to the National Trust Heathlands and viewing points all accessible within a stones throw from the front door, no need to get in the car to walk your dog.

The apartment is close to the main entrance as well as both resident boutique lounges, one is the former dining hall and is a superb place to relax with friends and family, the other the reading room has wonderful views of the gardens, a huge bookcase of books to share and superb wifi for home working and meeting friends.

The apartment comes with two superb allocated car parking spaces in the underground car park which is fully lit and has security cameras. There is also secure bike storage here for those enjoying the cycle trails through the woodlands around the estate.

Entering the apartment you are greeted by a wide spacious hallway with warm wood flooring, there are glimpses through the lead light mullion windows towards the front gardens and Historic Nurses House building.

To the left is the wonderful open plan kitchen/living area which blends contemporary living with historic elegance. The sleek kitchen features quartz worktops, recessed spotlights, premium integrated appliances, double oven and plenty of storage space.

The Principal bedroom is extremely generous with pretty views, a wonderful dressing area and superb tiled en-suite bathroom.

An equally spacious second bedroom has an adjacent guest bathroom which is complete with rainfall shower and tiled throughout.

There is a handy storage and utility area for washer dryer and storage just off the hallway.

In summary this wonderful apartment combines modern stylish living with fabulous Edwardian features and the unique architecture of the Bloomsbury Arts & Crafts Movement. You have everything at your doorstep, a swimming pool, steam room, gym, lots of walking, beautiful gardens with seating areas and a friendly community.

Dogs are welcome in all areas with miles of countryside to walk cycle and explore !

