



## Woodcroft Avenue, West Knighton

£1,350 pcm

A well presented THREE bedroom semi-detached home in WEST KNIGHTON.





















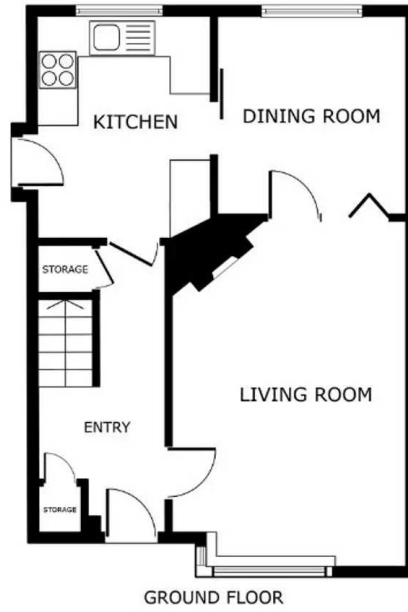

GROUND FLOOR

SIZES AND DIMENSIONS ARE APPROXIMATE, ACTUAL MAY VARY.

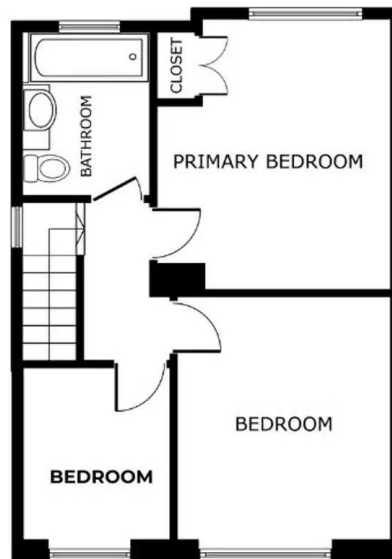

FLOOR 1

SIZES AND DIMENSIONS ARE APPROXIMATE, ACTUAL MAY VARY.







The property is perfectly situated for everyday amenities within West Knighton along Aberdale Road such as Tesco Express and popular local schooling including Sir Jonathan North Community College and Overdale Infant & Junior Schools. Regular bus routes running to and from Leicester City Centre along Welford Road and the main ring road are also within reach giving access to M1 & M69 motorway junctions and Fosse Retail Park.

Council Tax band: B

Tenure: Freehold

EPC Energy Efficiency Rating: D

**We'll keep you moving...**



We must inform all prospective purchasers that the measurements are taken by an electronic tape and are provided as a guide only and they should not be used as accurate measurements. We have not tested any mains services, gas or electric appliances, or fixtures and fittings mentioned in these details, therefore, prospective purchasers should satisfy themselves before committing to purchase. Intending purchasers must satisfy themselves by inspection or otherwise to the correctness of the statements contained in these particulars. Knightsbridge Estate Agents & valuers (nor any person in their employment) has any authority to make any representation or warranty in relation to the property.' The floor plans are not to scale, and are intended for use as a guide to the layout of the property only. They should not be used for any other purpose. Similarly, the plans are not designed to represent the actual décor found at the property in respect of flooring, wall coverings or fixtures and fittings.