



ROYAL ROAD
TEDDINGTON

JACKSON-STOPS 

ROYAL ROAD TEDDINGTON, TW11

ASKING PRICE: £1,600 PCM

This ground floor garden flat is just a short distance from shops, restaurants and the wonderful Bushy Park. Ideal for a single person or couple, the property benefits from a lovely and private garden, large kitchen and separate front reception room.

Royal Road is a short walk to Teddingtons shops and restaurants and only moments away from Fulwell Train Station with direct links to London Waterloo



KEY FEATURES

- Close To Shops
- Private Garden
- Close To Station
- Large Kitchen
- Ground Floor
- Close To Bushy Park



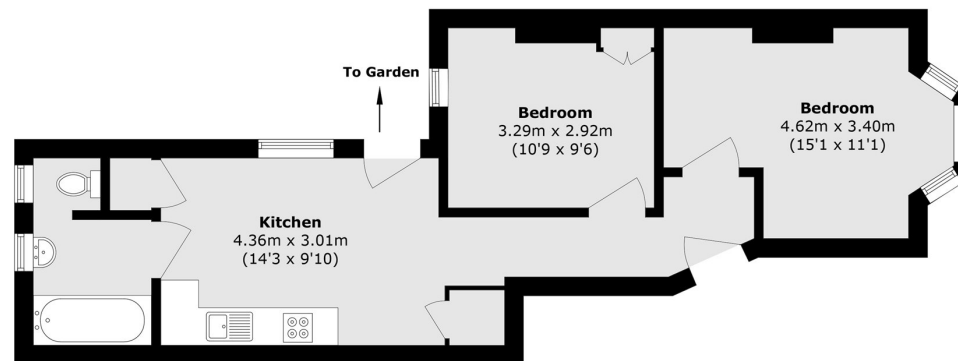

Total area (approx.): 50.0 sq. m (538.0 sq. ft)

Energy Rating: D. We aim to make our particulars both accurate and reliable. However they are not guaranteed; nor do they form part of an offer or contract. If you require clarification on any points then please contact us, especially if you are travelling some distance to view. Please note that appliances and heating systems have not been tested and therefore no warranties can be given as to their good working order.

ASKING PRICE: £1,600 PCM

TEDDINGTON

020 8943 9955

teddingtonlettings@jackson-stops.com

jackson-stops.co.uk

JACKSON-STOPS 