

Osprey Close

Middlesex • • UB7 7JE

PCM: £1,300 PCM



coopers
est 1986

A spacious one bedroom ground floor apartment to rent located in a quiet cul-de-sac within walking distance to West Drayton High Street and Station providing easy access to Central London via the Elizabeth Line. The M4/M25 Motorways, Heathrow Airport and Stockley Business Park are also nearby.

Features include a spacious double bedroom, large lounge leading onto a spacious kitchen, bathroom and allocated parking.

One Bedroom Apartment

Ground Floor

Large Lounge

Fitted Kitchen

Allocated Parking

Bathroom

West Drayton Station

West Drayton High Street

Motorway Access



GROUND FLOOR
443 sq.ft. (41.1 sq.m.) approx.

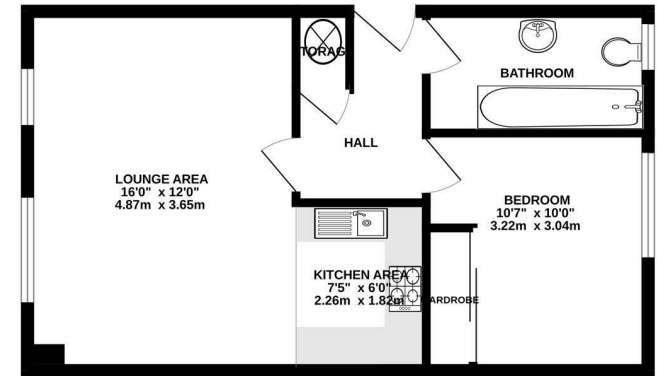

TOTAL FLOOR AREA: 443 sq.ft. (41.1 sq.m.) approx.
Whilst every attempt has been made to ensure the accuracy of the floorplan contained herein, measurements of doors, windows, rooms and any other items are approximate and no responsibility is taken for any error, omission or mis-statement. This plan is for illustrative purposes only and should be used as such by any prospective purchaser. The services, systems and appliances shown have not been tested and no guarantee as to their operability or efficiency can be given.
Made with MapInfo ©2026



Available Date

30th April 2026

01895 230 103

109 Hillingdon Hill, Hillingdon Village,
Middlesex, UB10 0JQ
propertymanagement@coopersresidential.co.uk

CoopersResidential.co.uk

Energy Efficiency Rating		Environmental Impact (CO ₂) Rating	
Current	Potential	Current	Potential
A	A	A	A
B	B	B	B
C	C	C	C
D	D	D	D
E	E	E	E
F	F	F	F
G	G	G	G

EU Directive 2002/91/EC

Important Notice: These particulars, whilst believed to be accurate are set out as a general outline only for guidance and do not constitute any part of an offer or contract. Intending purchasers should not rely on them as statements or representation of fact, but must satisfy themselves by inspection or otherwise has the authority to make or give any representation or warranty in respect of the property.

coopers
est 1986