



Mandeville Crescent, Bradford, BD6

- THREE BEDROOM SEMI DETACHED HOUSE
- AVAILABLE: NOW
- PART FURNISHED
- EPC RATING- D
- LOCAL AMENITIES, SCHOOL AND TRANSPORT LINKS WITHIN THE AREA
- DOUBLE GLAZING AND CENTRAL HEATING
- DRIVEWAY
- PRIVATE BACK GARDEN
- COUNCIL TAX BAND- A

£1,100 Per Calendar Month - Deposit £1,269



Mandeville Crescent, Bradford, BD6

DESCRIPTION

This three-bedroom semi-detached house is available ****to let**** in a residential area of Bradford, offering practical accommodation for families. The property is part-furnished and includes a driveway and a back garden, as well as a basement providing additional storage or utility space.

Internally, the house features one reception room with large windows and wood floors, creating a bright and functional living area. The kitchen benefits from natural light and provides dining space suitable for everyday family meals. There are two double bedrooms and one single bedroom, offering flexibility for sleeping arrangements or a home office. The property has one bathroom. The EPC rating is D and the council tax band is A.

The location provides access to local amenities, with shops, services and everyday conveniences a short distance away. Nearby parks and walking routes offer opportunities for outdoor recreation and family activities.

Bradford city centre can be reached by road within a reasonable journey time, giving access to a wider range of retail, leisure and employment options, as well as mainline rail connections towards Leeds, Skipton and beyond. Local bus routes operate within the surrounding area, linking residential streets to key parts of the city.

Overall, this part-furnished three-bedroom semi-detached house to let presents a practical option for families seeking a home with outdoor space, driveway parking and access to local amenities in Bradford.





HUNTERS
BRADFORD
HUNTERS.COM



HUNTERS
BRADFORD
HUNTERS.COM



HUNTERS
BRADFORD
HUNTERS.COM



HUNTERS
BRADFORD
HUNTERS.COM

Approx Gross Internal Area
88 sq m / 948 sq ft

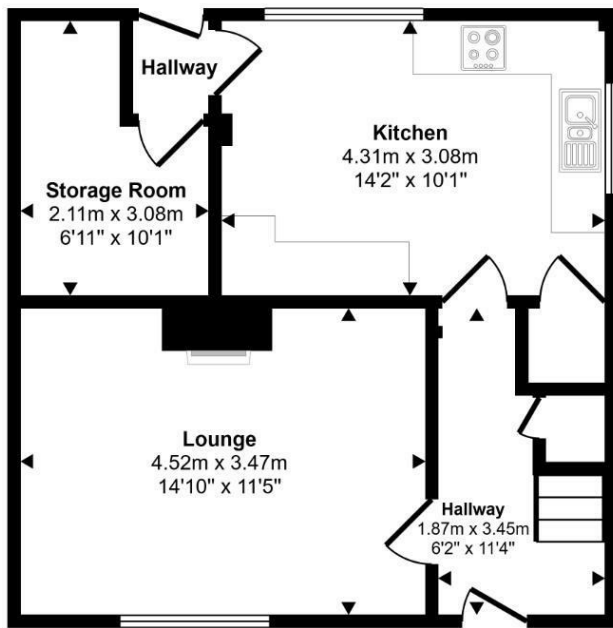

Ground Floor
Approx 43 sq m / 468 sq ft

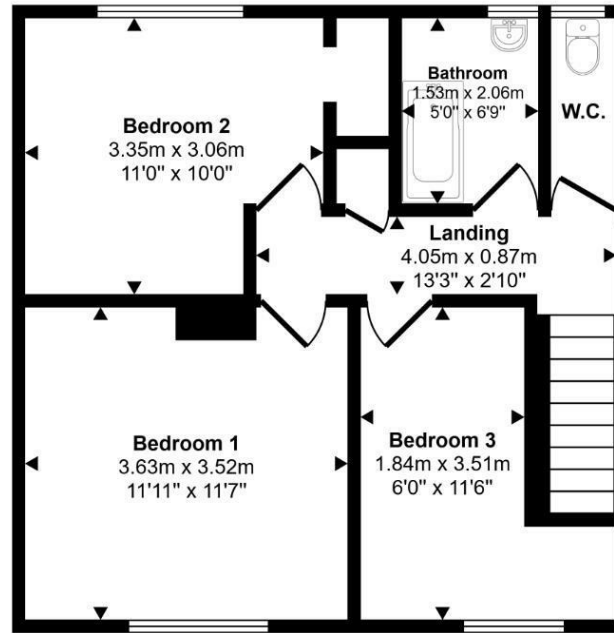

First Floor
Approx 45 sq m / 480 sq ft

This floorplan is only for illustrative purposes and is not to scale. Measurements of rooms, doors, windows, and any items are approximate and no responsibility is taken for any error, omission or mis-statement. Icons of items such as bathroom suites are representations only and may not look like the real items. Made with Made Snappy 360.

Viewings

Please contact bradford.lettings@hunters.com, if you wish to arrange a viewing appointment for this property or require further information.

Valuations

For a valuation of your property, please email the team with your property details, contact information and the times you are available.

ENERGY PERFORMANCE CERTIFICATE

The energy efficiency rating is a measure of the overall efficacy of a home. The higher the rating the more energy efficient the home is and the lower the fuel bills will be.

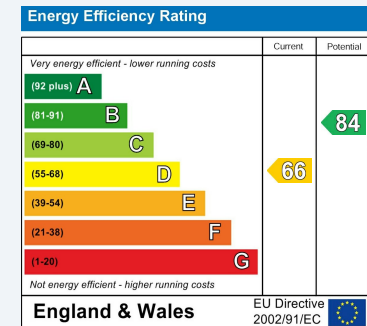

These particulars are intended to give a fair and reliable description of the property but no responsibility for any inaccuracy or error can be accepted and do not constitute an offer or contract. We have not tested any services or appliances (including central heating if fitted) referred to in these particulars and the purchasers are advised to satisfy themselves as to the working order and condition. If a property is unoccupied at any time there may be reconnection charges for any switched off/disconnected or drained services or appliances - All measurements are approximate.

THINKING OF SELLING? If you are thinking of selling your home or just curious to discover the value of your property, Hunters would be pleased to provide free, no obligation sales and marketing advice. Even if your home is outside the area covered by our local offices we can arrange a Market Appraisal through our national network of Hunters estate agents.

