



# 7 Common Lane

Harworth, Doncaster, DN11 8LW

£203,000

Extended three-bedroom semi-detached home offering spacious and versatile accommodation, this property is ideal for families. The ground floor features a lounge with oak French doors leading to the modern open-plan kitchen diner, perfect for everyday living and entertaining. The extension provides an additional reception room, currently used as a playroom, which could easily serve as a home office or further sitting room. To the first floor are three bedrooms and a contemporary shower room.

Externally, the property benefits from a generous, well-established rear garden and ample off-road parking to the front and side. Conveniently located for access to the A1 motorway network, local schools, supermarkets and healthcare facilities. Viewing highly recommended.

- Extended three-bedroom semi-detached home
- Open-plan kitchen diner ideal for entertaining and family living
- Additional reception room – perfect playroom or home office
- Spacious Lounge
- Generous, well-established rear garden, not overlooked
- Ample off-road parking to the front and side
- Excellent access to the A1 motorway network
- Close to local schools, supermarkets and healthcare facilities

## Viewing

Please contact our Office on 01302 751616 if you wish to arrange a viewing appointment for this property or require further information.

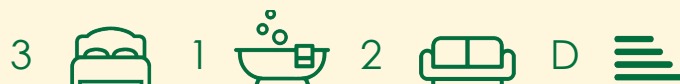

## Floor Plan

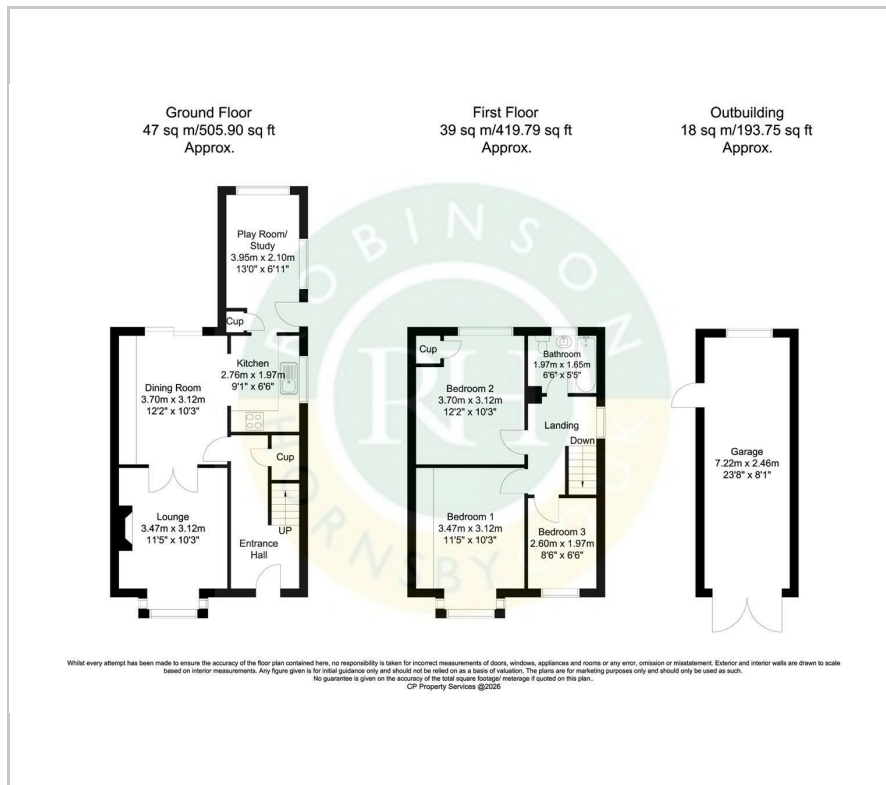

## Area Map



## Energy Efficiency Graph

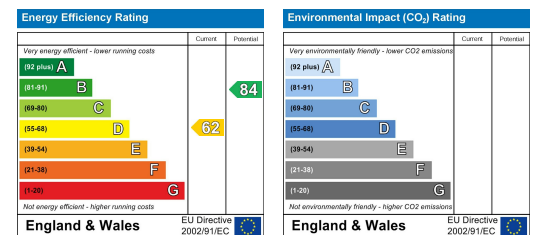

These particulars, whilst believed to be accurate are set out as a general outline only for guidance and do not constitute any part of an offer or contract. Intending purchasers should not rely on them as statements of representation of fact, but must satisfy themselves by inspection or otherwise as to their accuracy. No person in this firm's employment has the authority to make or give any representation or warranty in respect of the property.