



Park Crescent

Southport, PR9 9ND

£2,750 Per Month

Flexi-Agent are delighted to present this outstanding, fully renovated four bedroom detached family home to the lettings market. Situated in the desirable area of Hesketh Park, it is close to a wealth of nearby amenities including Churchtown village and Southport town centre, Hesketh Golf Links and local bus routes.

The property has a fantastic contemporary fitted open plan kitchen, dining living space ideal for family living and briefly comprises: Entrance porch and hallway, downstairs WC, spacious living room with feature bay window, spacious open plan kitchen/dining space with bi-folding doors to the garden and a further reception room with with bay window.

To the first floor there are four bedrooms one being en-suite, family bathroom and a separate WC.

Externally, there is a paved driveway to the front providing ample off-road parking. To the rear, there is a private and enclosed paved rear garden with ample storage.

Viewings are available upon request.

** Minimum tenancy 6 Months **

Viewing

Please contact our Flexi-Agent Southport Lettings Office on 01704 889455 if you wish to arrange a viewing appointment for this property or require further information.

- Detached House
- Four Bedrooms
- En-suite
- Open plan kitchen diner
- Bi-fold doors
- Downstairs WC
- Driveway parking
- Family Bathroom
- Sun catching garden
- Two Bathrooms



4



2



2



2

C

Floor Plan

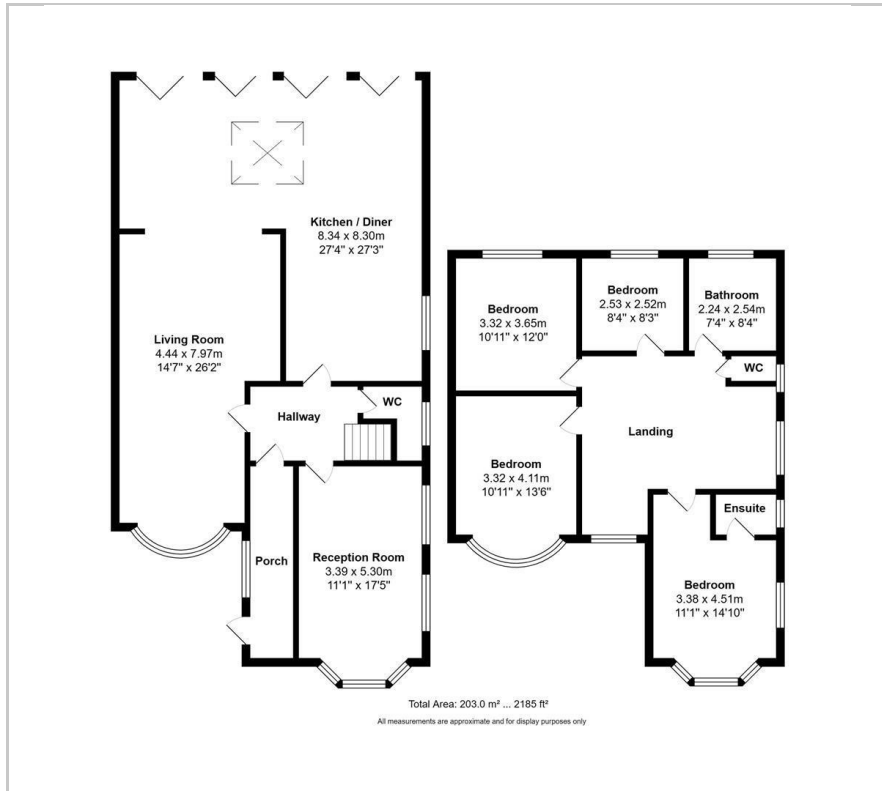

Area Map



Energy Efficiency Graph

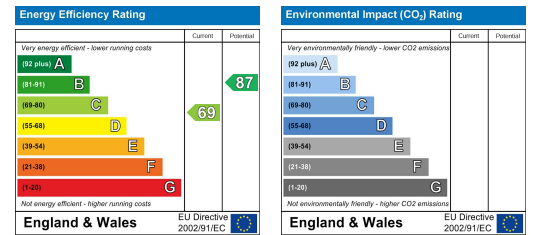

These particulars, whilst believed to be accurate are set out as a general outline only for guidance and do not constitute any part of an offer or contract. Intending purchasers should not rely on them as statements of representation of fact, but must satisfy themselves by inspection or otherwise as to their accuracy. No person in this firm's employment has the authority to make or give any representation or warranty in respect of the property.