



## Webber Street, SE1

£395,000

This highly attractive period conversion combines classic charm with modern comfort. Featuring high ceilings, large windows with fitted shutters, and quality hardwood flooring throughout, the property offers a bright and inviting atmosphere. The contemporary interior includes a generously sized, fully fitted kitchen with ample storage, a spacious double bedroom, and a three-piece bathroom. Offered to the market chain-free.

Located on Webber Street, this property offers excellent access to Borough, Southwark, London Bridge, and Elephant & Castle stations. Moments from the vibrant South Bank, residents can enjoy riverside walks, cultural landmarks, and the lively atmosphere of Borough Market. The surrounding area is rich in independent cafés, traditional pubs, and diverse dining options, blending historic charm with modern city living.

### Features

Period Conversion  
Open Plan Living  
High Ceilings  
Large Windows  
Chain Free Sale

Webber Street,  
London, SE1

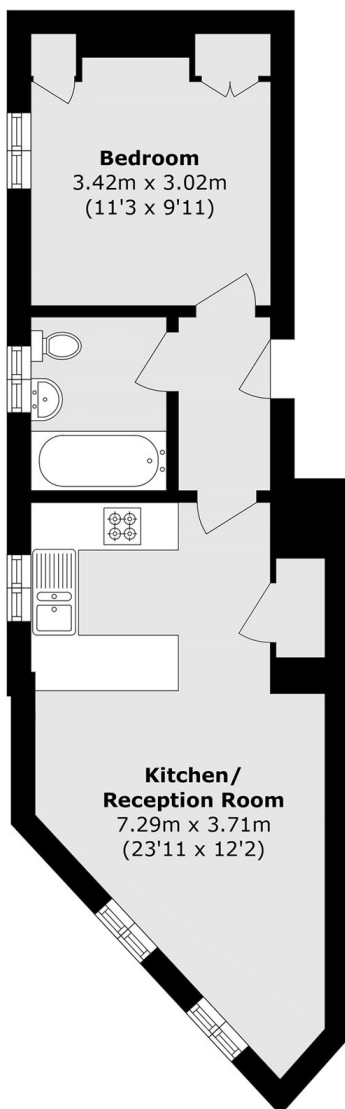

### First Floor

Total area (approx.): 39.2 sq. m (421.9 sq. ft)