



GRAHAM ROAD, SW19

£2,000 per month

One bedroom flat
Unfurnished
Modern
Off street parking
Gated development
Energy rating: c

@marshandparsons
marshandparsons.co.uk

MARSH &
PARSONS



ABOUT THE PROPERTY

A spacious, one double bedroom ground floor apartment with gated entrance. The property offers a large lounge with dining area, modern fitted kitchen, double bedroom with walk-in wardrobe, bathroom, two good sized storage cupboards. The property also offers one allocated off street parking space.

The property is within walking distance to Wimbledon Town Centre and station.



STEP INSIDE GRAHAM ROAD

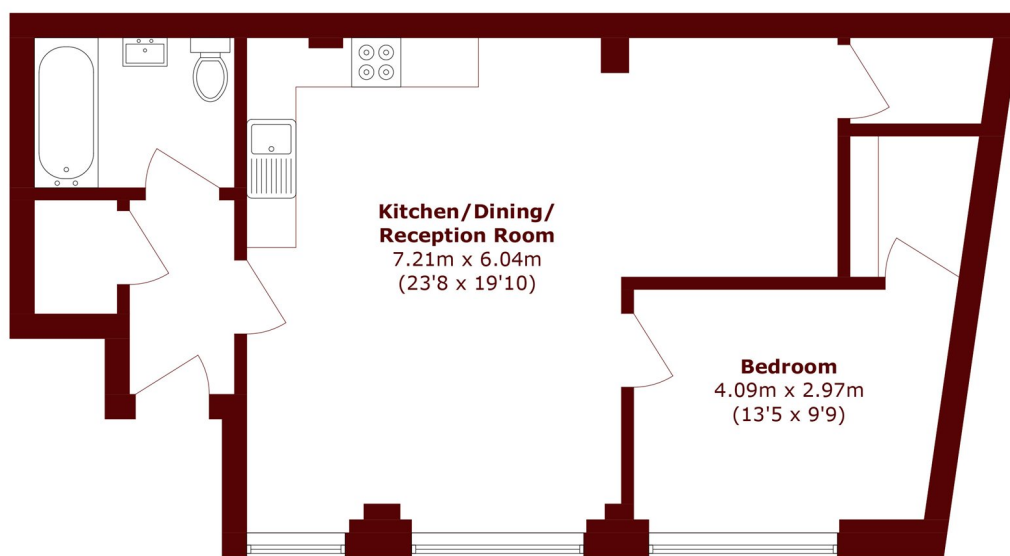

Total area (approx.): 62.5 sq. m (672.7 sq. ft)

Wimbledon
020 8879 6661

Energy Rating: C We aim to make our particulars both accurate and reliable. However, they are not guaranteed; nor do they form part of an offer or contract. If you require clarification on any points then please contact us, especially if you're traveling some distance to view. Please note that appliances and heating systems have not been tested and therefore no warranties can be given as to their good working order

MARSH &
PARSONS