

Head Office:
Dixon Kelley Estate Agents
1 Penn Court
Station Road, West Moors
Dorset. BH22 0JJ

Telephone: 01202 877511

DORSET PARK HOMES

DRAFT

www.dorsetparkhomes.com

44 Holton Heath Park, Wareham Road, Holton Heath, Poole. BH16 6JS



Well Presented Park Home on Sunny Plot

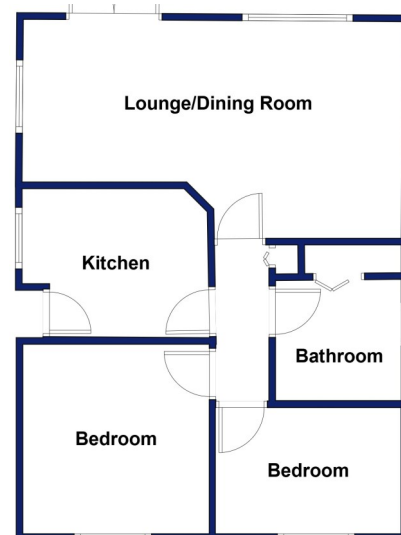

This drawing has been prepared for diagrammatic purpose only. Not to scale

2 Bedroom Park Home approx 27' x 20'

Accommodation & approximate room dimensions:

- Tingdene 'Hayden Classic' circa 1996
- Hall: Cloaks cupboard.
- Lounge/Dining Room: approx 19'6" x 11'5" max. Feature fireplace. Double doors to garden.
- Kitchen: approx 9'6" x 7'6". Range of floor & wall cupboards. Space for washing machine & tall fridge/freezer. Gas cooker. Recently fitted composite door to garden.
- Bedroom 1: approx 9'8" x 9'6". Fitted wardrobes & dresser unit.
- Bedroom 2: approx. 9'6" x 6'6". Fitted wardrobe
- Modern Bathroom: Panelled bath with mixer tap & shower attachment. Vanity wash basin & WC. Large cupboard housing combination gas boiler.
- Gas Central Heating (system untested)
- PVCu Double-Glazing
- Garden with pleasant aspect.
- Parking on Plot
- Age Restriction 50+ 1 Cat Permitted. No Dogs
- Small, popular Residential Park near to local amenities and between Wareham & Poole.

Popular Residential Park



PRICE £99,950

Pitch Fee: approx £195 per month

Subject to Annual Review

Council Tax band: 'A'

Tenure: 1983 Mobile Homes Act Agreement

VIEWING STRICTLY BY APPOINTMENT WITH THE VENDOR'S AGENT Dorset Park Homes 01202 877511

IMPORTANT NOTE: These particulars are believed to be correct but their accuracy is not guaranteed. They do not form part of any contract. Nothing in these particulars shall be deemed to be a statement that the property is in good structural condition or otherwise, nor that any of the services, appliances, equipment or facilities are in good working order or have been tested. Purchasers should satisfy themselves on such matters prior to purchase Ref.W05186

The recommended specialist in Park Home sales
Proprietor: Simon Dixon

