



Flat 18, 39 Bramham Gardens, London | Earls Court | London | SW5 0JL

£1,950 Per Month

SÉJOUR

Flat 18, 39 Bramham Gardens,
London | Earls Court
London | SW5 0JE

Presenting a beautifully refurbished studio apartment located in one of London's most sought-after locations.

- Fully furnished by award-winning interior designers
- Access to exclusive private garden square
- Excellent central London location
- Stylish modern interiors throughout
- Located on the second floor
- Clever layout

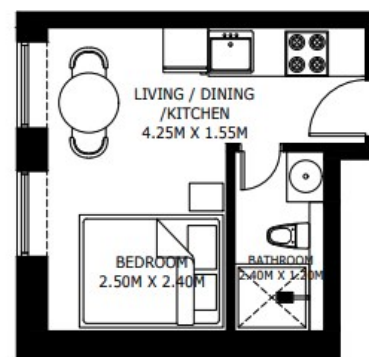

Energy Efficiency Rating		Current	Potential
<i>Very energy efficient - lower running costs</i>			
(92 plus) A			
(81-91) B		82	86
(69-80) C			
(55-68) D			
(39-54) E			
(21-38) F			
(1-20) G			
<i>Not energy efficient - higher running costs</i>			
England & Wales		EU Directive 2002/91/EC	

Council Tax Band C
EPC Rating B

UNIT 18

GROSS INTERNAL AREA
27.35 SQ.M. / 294.39 SQ.FT.

*SIZES AND DIMENSIONS ARE APPROXIMATE, ACTUAL MAY VARY.

10 Cromwell Pl
South Kensington
London
SW7 2JN

020 3865 0611
lettings@cityrelay.com