



Bridge Road, Desborough **Freehold** £220,000 O.I.E.O.

**Pattison
Lane**

Key Features



- Modern Two Bedroom Semi Detached Bungalow
- NO ONWARD CHAIN
- Spacious Lounge / Dining Room
- Four Piece Bathroom Suite
- Two Allocated Parking Spaces

Presented in truly superb decorative order throughout, this outstanding modern two-bedroom bungalow offers a rare opportunity to acquire a turnkey home. Offered to the market with NO ONWARD CHAIN, this property is perfectly positioned for a seamless and swift move.



Interior Highlights

Spacious Lounge / Diner: Positioned to the rear of the property, this expansive and inviting reception room serves as the true heart of the home, elegant French-style doors provide a seamless transition to the outside, creating an ideal environment for both relaxing and entertaining.

Modern Kitchen/Breakfast Room: A beautifully appointed, contemporary kitchen space shown in, featuring sleek cabinetry, ample workspace, and a comfortable area for a breakfast table.

Generous Bedrooms: The property boasts two well-proportioned bedrooms offering versatile, bright, and comfortably sized accommodation.

Four-Piece Bathroom: A superbly finished and comprehensive four-piece family bathroom suite, uniquely enhanced by a Velux-style roof light that bathes the room in natural sunshine.

Exterior & Parking

Private Rear Garden, the enclosed rear garden is a peaceful haven, uniquely benefiting from a high degree of privacy. Featuring a pleasant balance of patio seating space, mature hedging, and practical timber outbuildings, it is the perfect outdoor retreat.

Frontage & Parking: The property features an attractive brick facade with a neatly landscaped front lawn, central pathway and allocated parking for two.

Early internal viewing is highly advised to fully appreciate the exceptional standard and scale of the accommodation on offer.



GROUND FLOOR

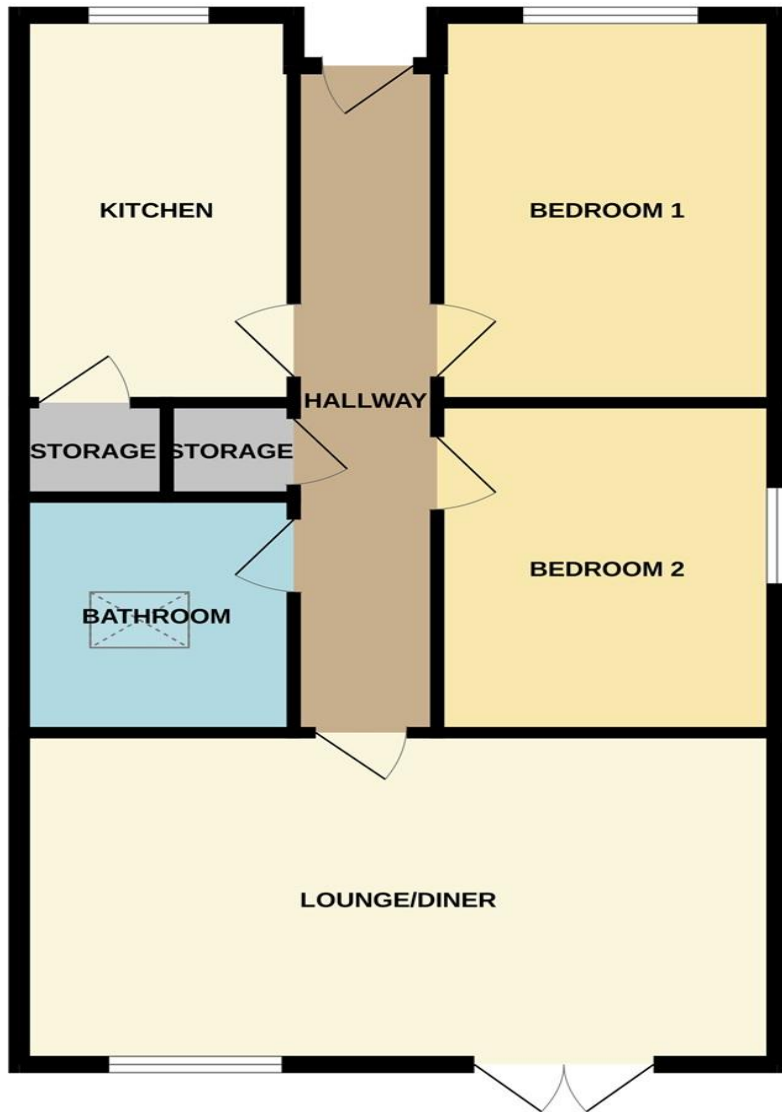

The accommodation comprises:

ENTRANCE HALL

KITCHEN 7'2 x 13'5 (2.18m x 4.08m)

LOUNGE / DINING ROOM 20'10 x 11'5 (6.35m x 3.47m)

BEDROOM ONE 13'4 x 9'4 (4.06m x 2.84m)

BEDROOM TWO 11'4 x 9'4 (3.45m x 2.84m)

BATHROOM 7'1 x 7'8 (2.15m x 2.33m)

OUTSIDE

FRONT GARDEN

ALLOCATED PARKING FOR TWO CARS

REAR GARDEN

AGENTS NOTE:

We are selling a number of identical properties, the pictures used are for example purposes only, please enquire for further details.

To view this property call Pattison Lane on:
01536 430527

Selling your property?



SCAN ME

Contact us to arrange a **FREE** home valuation.

 01536 430527

 42 Station Road, Desborough, KETTERING, Northamptonshire, NN14 2RL

 desborough@pattisonlane.co.uk

 www.pattisonlane.co.uk



SCAN ME



Sharman Quinney Holdings Limited is registered in England and Wales under company number 4174227, Registered Office is Cumbria House, 16-20 Hockliffe Street, Leighton Buzzard, Bedfordshire, LU7 1GN. VAT Registration Number is 500 2481 05.

1: These particulars do not constitute part or all of an offer or contract. 2: The measurements indicated are supplied for guidance only and as such must be considered incorrect. 3: Potential buyers are advised to recheck the measurements before committing to any expense. 4: Sharman Quinney has not tested any apparatus, equipment, fixtures, fittings or services and it is the buyers interests to check the working condition of any appliances. 5: Sharman Quinney has not sought to verify the legal title of the property and buyers must obtain verification from their legal representative. 6: Intending purchasers will be asked to produce identification documentation at a later stage and we would ask your co-operation in order that there will be no delay in agreeing the sale. Ref: DPL101714 - 0001

