



Pakenham Place, Haverhill, CB9 0JA

CHEFFINS

Pakenham Place

Haverhill,
CB9 0JA

A very well presented three bedroom end terraced house on the edge of the popular Chalkstone development close to schools and transport links. The property benefits from downstairs wc, and rear garden. Available 28th August 2026.

3 1 1

£1,200 Per Month



- Three Bedrooms
- Family Bathroom
- Lounge Dining Room
- Rear Garden
- EPC Rating C
- Council Tax Band B



GROUND FLOOR

Entrance Hall

Under stairs cupboard, stairs to first floor, doors to:

Kitchen

Fitted wall and base units with worktop over, cooker, space and plumbing for appliances, window to front, door to:

Lounge Dining Room

Window to rear, double doors to garden

Downstairs WC

Window to front, wc, wash hand basin

FIRST FLOOR

Landing

Storage cupboard, doors to:

Bedroom One

Window to rear

Bedroom Two

Window to rear

Bedroom Three

Window to front, storage cupboard

Bathroom

Fitted with panelled bath with shower over, wc, wash hand basin, window to front

Garden

Rear garden mainly paved with brick built storage shed and gated rear access

Holding Deposit

£276.00

Material Information

For more information on this property please refer to the Material Information brochure on our Website



Ground Floor
Approx. 46.8 sq. metres (503.5 sq. feet)

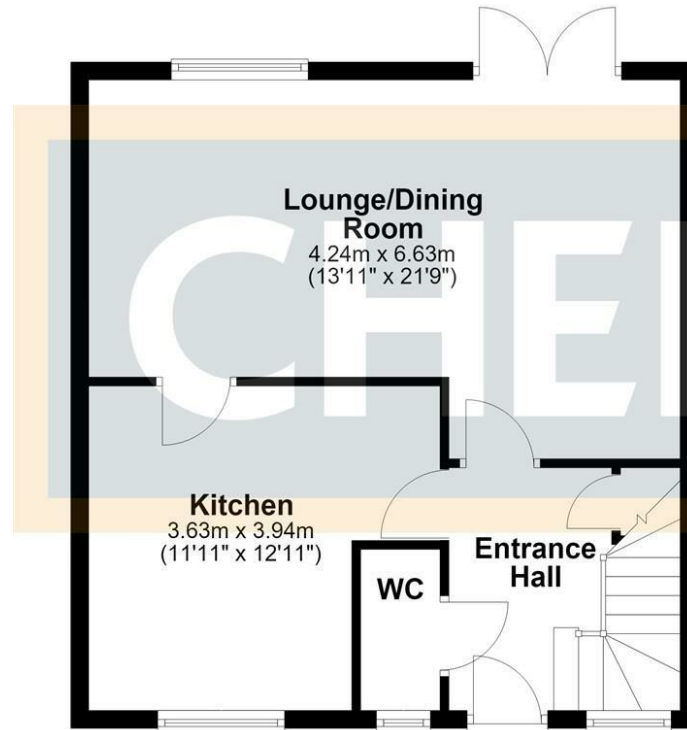

First Floor
Approx. 47.0 sq. metres (505.9 sq. feet)

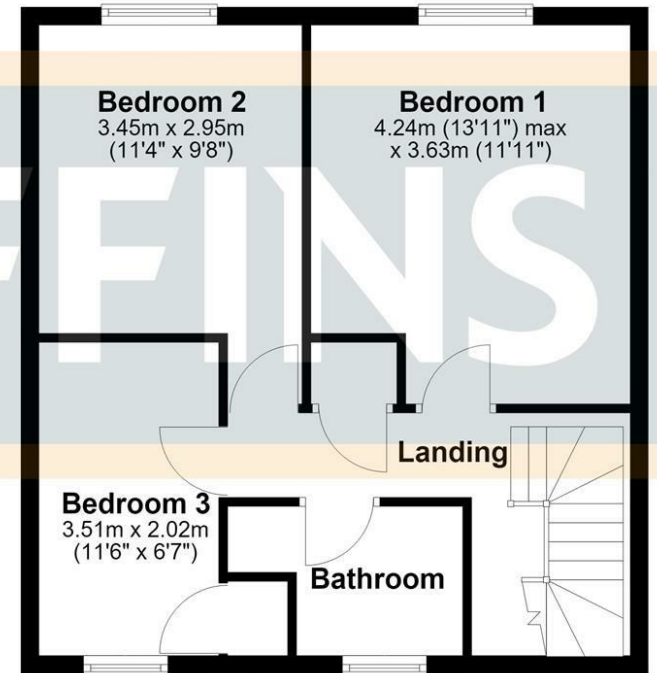

Total area: approx. 93.8 sq. metres (1009.5 sq. feet)

Energy Efficiency Rating

	Current	Potential
Very energy efficient - lower running costs		
(92 plus) A		88
(81-91) B		
(69-80) C		
(55-68) D	70	
(39-54) E		
(21-38) F		
(1-20) G		
Not energy efficient - higher running costs		
England & Wales	EU Directive 2002/91/EC	

Agents note:

For more information on this property please refer to the Material Information Brochure on our website.

Cavendish House, 27a High Street, Haverhill, Suffolk, CB9 8AD | 01440 707076 | cheffins.co.uk



IMPORTANT: Cheffins would like to inform prospective clients that these particulars have been prepared as a general guide only. A detailed survey has not been carried out, nor the services, appliances or fittings tested. Room sizes should not be relied upon for furnishing purposes and are approximate. If floor plans are included, they are for guidance and illustration purposes only and may not be to scale. Images may have been digitally edited for illustration purposes. If there are any important matters likely to affect your decision to buy or rent, please contact us before viewing the property.