



8 Ormond Avenue, Westhead

Ormskirk

£275,000

8 Ormond Avenue

Westhead, Ormskirk

This well-maintained two-bedroom detached bungalow offers over 1,040 sq. ft. of comfortable single-level living in a peaceful semi-rural village setting. The property features a spacious lounge, modern fitted kitchen and a bright conservatory overlooking the private rear garden. There are two double bedrooms, one with fitted wardrobes, along with a contemporary bathroom. Mature gardens to the front and rear provide pleasant, manageable outdoor space. Conveniently located with easy access to Ormskirk, Burscough and the motorway network, this home is ideal for downsizers seeking a quiet yet well-connected location. Viewings available upon request.

Council Tax band: D

Tenure: Freehold

EPC Energy Efficiency Rating: D

EPC Environmental Impact Rating: D

- Detached two-bedroom bungalow
- Bright garden conservatory
- Peaceful semi-rural setting
- Spacious & comfortable lounge
- Detached garage & driveway
- Excellent transport links
- Private mature gardens





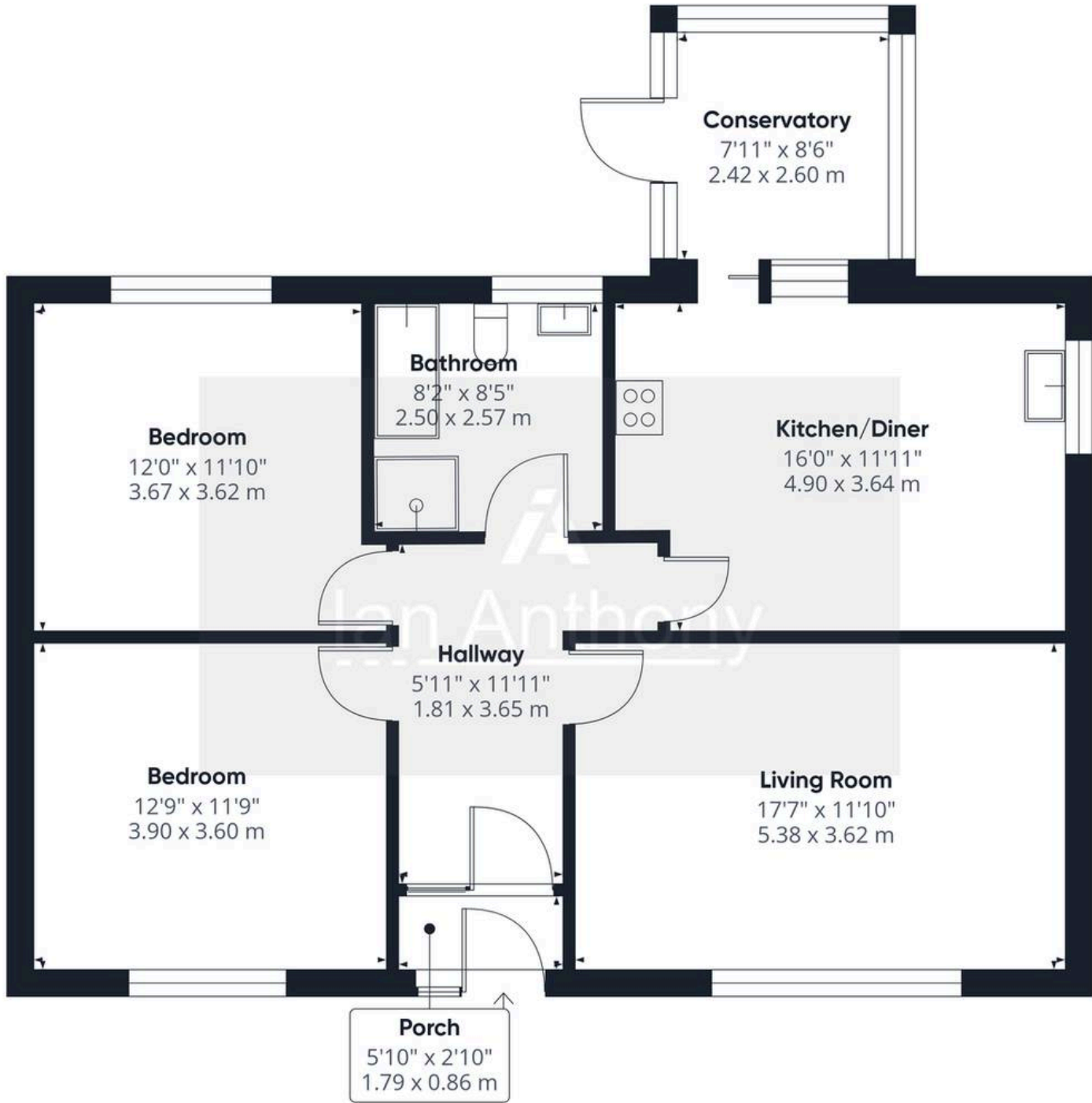

Approximate total area⁽¹⁾

946 ft²
87.8 m²

(1) Excluding balconies and terraces

Calculations reference the RICS IPMS 3C standard. Measurements are approximate and not to scale. This floor plan is intended for illustration only.

GIRAFFE 360





IAN ANTHONY

5 Burscough Street, Ormskirk - L39 2EG

01695580888

enquiries@iananthonyestates.co.uk

iananthonyestates.co.uk/

