



Cavendish Road, NW6

£390,000

This spacious one bedroom flat is located on the ground floor of this converted Victorian house and it would make an ideal first time purchase or investment. This very sizable property offers in excess of 540 sq ft and benefits from access to a communal garden.

Cavendish Road is conveniently located with good transport links to including Kilburn underground station (Jubilee Line) as well as many bus connections, shops bars and cafés.

Features

- Ground Floor
- Private Garden
- Victorian Conversion
- Close To Station
- Communal Garden
- No Onward Chain

Cavendish Road, London, NW6

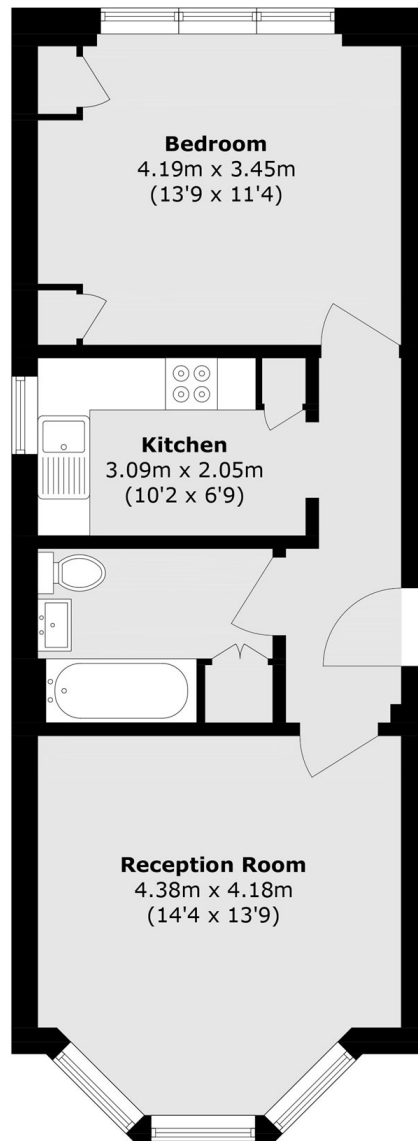

Total area (approx.): 50.4 sq. m (542.5 sq. ft)