

RIVERHOMES

Lots Ait
Brentford TW8

£300,000
Residential



Lots Ait Brentford TW8

In 2011, the boat began a new chapter when it was carefully converted from a working vessel into an expansive four-bedroom home. Measuring 82ft in length with a beam of over 18ft, the interiors have since been sympathetically reimaged by its current owner, an art director and interior stylist, balancing the vessel's industrial heritage with warm, contemporary living spaces.

The accommodation unfolds across beautifully considered interiors defined by tactile, reclaimed materials and bespoke detailing. Moulded concrete worktops form the centrepiece of the

kitchen and bathroom, while reclaimed timber features throughout the galley and en suite spaces add texture and warmth. Original salvaged light fittings from the vessel's former working life have been thoughtfully reintroduced, lending character and continuity to the design narrative. Air conditioning serves the principal living spaces, bringing comfort year-round. Outside, generous decks at both bow and stern provide spaces for entertaining, dining and enjoying the changing light on the water. Positioned within the unique community at Lots Ait.

KEY FEATURES

4 bedrooms

2 bathrooms

Built in 1958

Fully refurbished in 2011

Generous deck at bow and stern for entertaining and dining

Combines historic significance, architectural character and peaceful waterside living

Mooring charges £16,080 per annum approx.

Service charges £3,181 per annum approx.

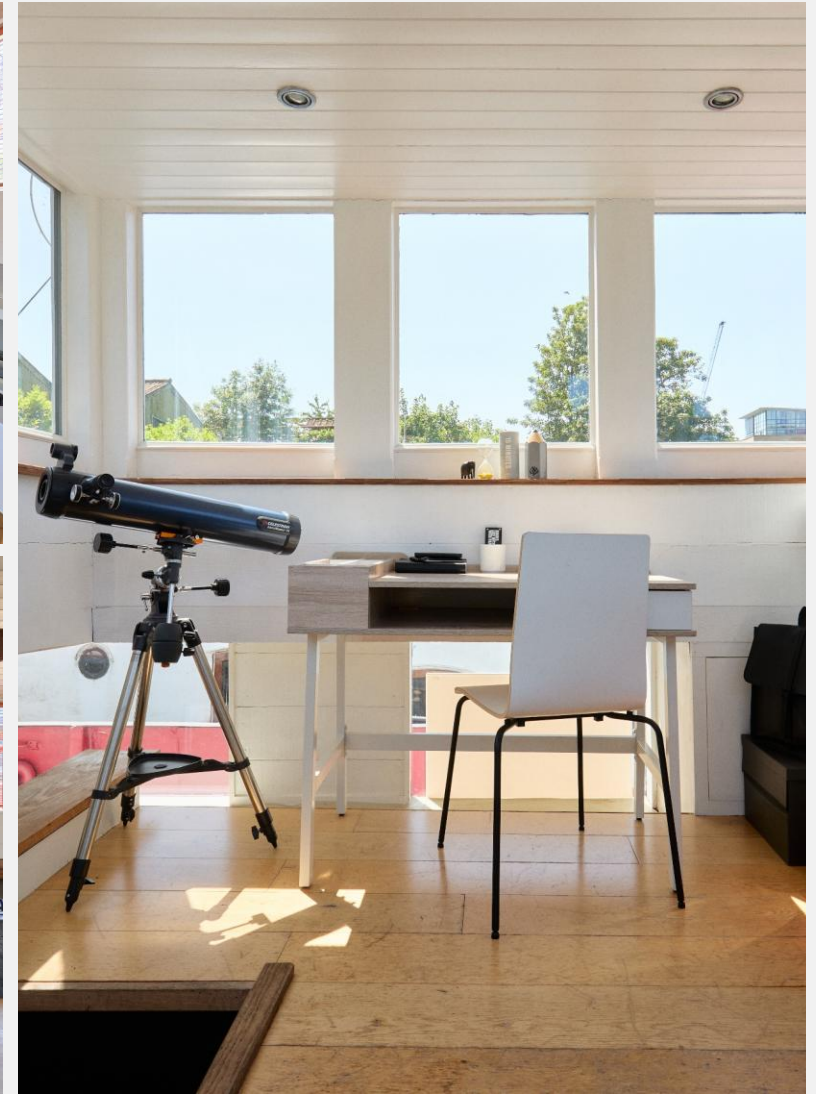



KEY INFORMATION

Local authority:	London Borough of Hounslow
Internal area:	1,252 sq. ft. / 116.42 sq. m.
No. of bedrooms:	4
Council tax band:	A - £1,457.04 per annum approx.
Mooring charge:	£16,080 per annum approx.
Service charge:	£3,181 per annum approx.

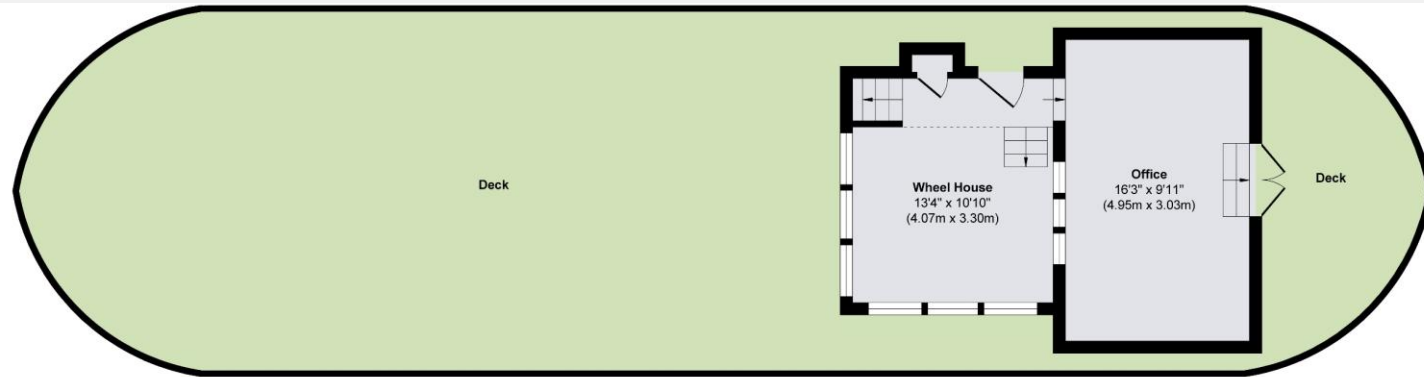

First Floor
Approximate Floor Area
302 sq. ft.
(28.14 sq. m)

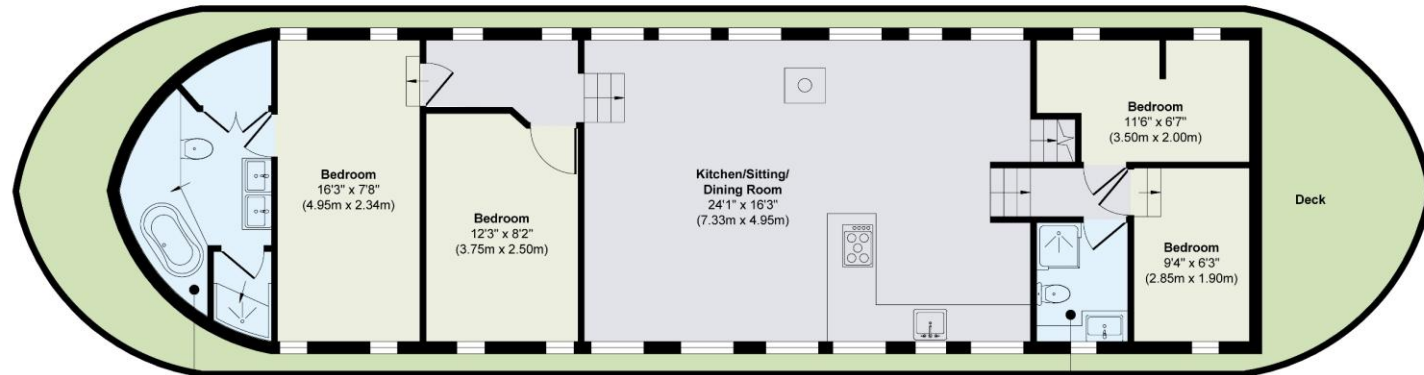

En-suite
16'3" x 8'2"
(4.95m x 2.50m)

Ground Floor
Approximate Floor Area
950 sq. ft.
(88.28 sq. m)

Shower Room
6'5" x 4'11"
(1.95m x 1.50m)