



Wear Road, Worthing, BN13 3PF

Freehold

A three bedroom semi-detached house in the popular area of Durrington • Offered in excellent order throughout having been refurbished in the last few years • Two reception rooms • South facing garden • Off street parking for two cars • Close to West Durrington shopping complex, prominent schools and easy reach of the A27 • For more information please visit the Cooper Adams website

Cooper Adams

A three-bedroom semi-detached house located in a popular residential area of Durrington. The accommodation includes an entrance hall leading to a sitting room, dining room, downstairs cloakroom with a utility area, and a fully fitted kitchen/breakfast room with a breakfast bar. Doors from the kitchen open onto the south-facing garden, which features decking, a patio area with a pergola, lawned section, creating an ideal space for outdoor entertaining and plenty of space to enjoy outdoors. There is also a large understairs cupboard providing useful storage. Upstairs, there are three bedrooms, two doubles and one single, along with a family bathroom. The property has been refurbished within the last few years and is in good condition throughout. To the front, there are two off-street parking spaces.

The house is conveniently located close to the West Durrington shopping complex, local schools, and provides easy access to the A27.



Worthing, a seaside town on England's south coast, lies between Brighton and Chichester. Known for its high quality of life, Worthing offers sailing, golf, and a vibrant town centre with shops, restaurants, and bars. Its long seafront promenade attracts walkers and runners, offering stunning sea views and an idyllic seaside lifestyle. This property is "Legally Prepared." Cooper Adams has gathered key documents, including the title, plans, property forms, warranties, and EPC. Buyers must request these before offering.



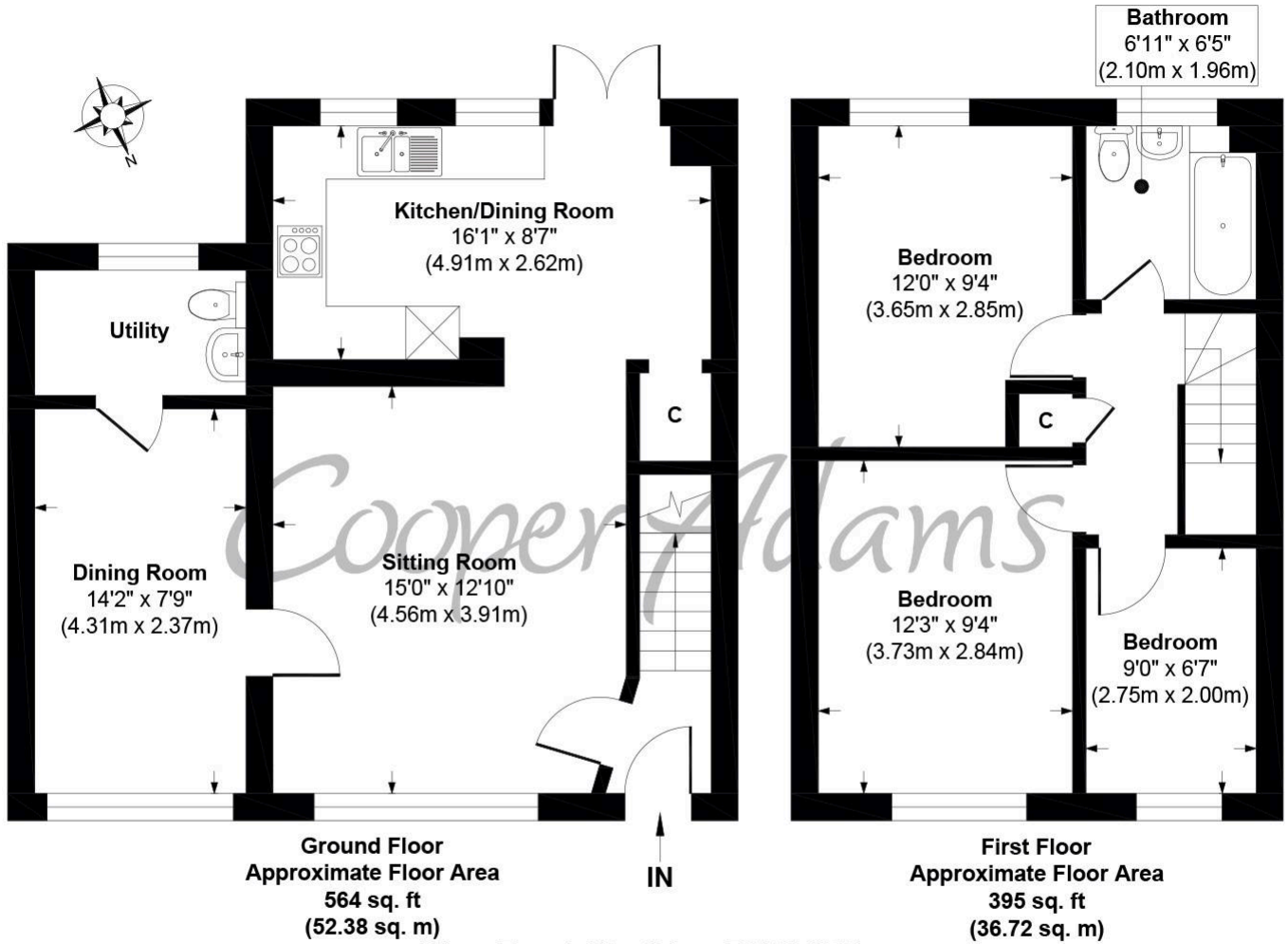

Wear Road, Worthing, BN13 3PF

Approx. Gross Internal Floor Area 959 sq. ft / 89.10 sq. m

Illustration for identification purposes only, measurements are approximate, not to scale

Copyright © Cooper Adams



Material Information includes important facts that may affect a buyer's decision to view or buy, such as tenure, restrictions, utilities, construction, and other key details. Full information for this property is available at www.cooper-adams.com. We may offer buyer services and receive referral benefits – details on request. All content is copyright Cooper Adams. Details and floor plans are for guidance only and don't form part of any contract. Measurements are maximums including bays and alcoves. Floor plan sizes are approximate. Images, maps and plans are not to scale. Appliances/services not tested. Cooper Adams Estates Ltd, Bishopstone. Reg No: 07127482. VAT No: 982847172.

Lettings | Sales | Free valuations | Land & New Homes | Mortgages

FULL DETAILS OF THE MATERIAL INFORMATION ARE ON OUR WEBSITE - VIEWING STRICTLY BY APPOINTMENT WITH COOPER ADAMS

FOR MORE PHOTOS AND TO BOOK A VIEWING VISIT OUR WEBSITE - Tel: 01903 791 792 - www.cooper-adams.com