

These particulars are believed to be accurate but they are not guaranteed and do not form a contract. Neither Jordan Fishwick nor the vendor or lessor accept any responsibility in respect of these particulars, which are not intended to be statements or representations of fact and any intending purchaser or lessee must satisfy himself by inspection or otherwise as to the correctness of each of the statements contained in these particulars. Any floorplans on this brochure are for illustrative purposes only and are not necessarily to scale.

Whilst every attempt has been made to ensure the accuracy of the floorplan contained here, measurements of doors, windows, rooms and any other items are approximate and no responsibility is taken for any error, omission or mis-statement. This plan is for illustrative purposes only and should be used as such by any prospective purchaser. The services, systems and appliances shown have not been tested and no guarantee as to their operability or efficiency can be given. Made with Metropix ©2026

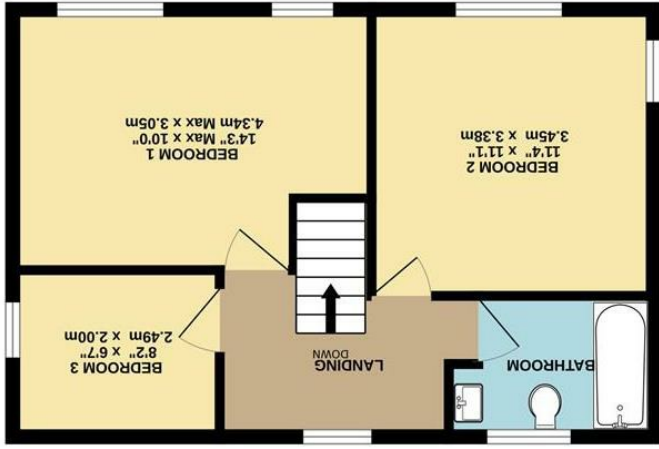

GROUND FLOOR



1ST FLOOR



The Gate House Buxton Road,
Chinley, High Peak, SK23 6DT

£390,000



The Property

'The Gate House' is a delightful detached three-bedroom property offering modern, bright, and spacious living throughout. Enjoying open countryside views and a desirable south-westerly orientation, the home benefits from an abundance of natural light and sunshine throughout the day. Perfectly suited to young families, the property provides fantastic living space along with private outdoor areas ideal for relaxing or entertaining. The ground floor features a well-appointed dining kitchen with fitted appliances, a convenient downstairs WC, and a bright, welcoming living room complete with a multi-fuel burner, creating a cosy and inviting atmosphere. To the rear, a conservatory takes full advantage of the home's sunny aspect, providing an additional versatile living space with lovely views over the garden. To the first floor are two generously sized double bedrooms, a further single bedroom, and a modern family bathroom completing the accommodation. Externally, the property benefits from private gardens, off road parking and ample space to enjoy outdoor living, all set within a peaceful countryside setting. NO ONWARD CHAIN.



- NO ONWARD CHAIN
- Beautiful Detached Property
- Three Bedrooms
- Spacious Dining Kitchen
- Multi Fuel Burner
- Downstairs W.C
- Off Road Parking
- South Westerly Aspect
- Countryside Views

Postcode - SK23 6DT
EPC Rating - D
Local Authority - High Peak
Council Tax - B

