



Simon House, St. Marys Road, Ipswich, IP4 4SP

welcome to

Simon House, St. Marys Road, Ipswich

This modern, ground floor flat is situated within the beautiful St Mary's development, is surrounded by woodland and benefits from a separate lounge and kitchen, one bedroom and one allocated parking space.

Entrance Hall

Wood effect flooring, an airing cupboard, an entry phone system and a fuse board.

Lounge/Diner

Spacious lounge/diner with wood effect flooring throughout, double glazed window to the rear, one electric heater, TV point and an additional storage radiator.

Kitchen

Eye and base level units in white with granite effect worktop surfaces, a sink plus drainer and chrome mixer tap, an integrated oven with electric hob and extractor hood, space for a fridge/freezer and washing machine, cream tiled splashback and wood effect flooring throughout.

Master Bedroom

Double glazed window to the rear, one electric radiator, a built in wardrobe and carpet flooring.

Bathroom

Tiled flooring, a panel heater, shaver point, a bath with shower attachment and glass screen, low level WC, wash hand basin and partially tiled walls.

Parking

One allocated parking space.

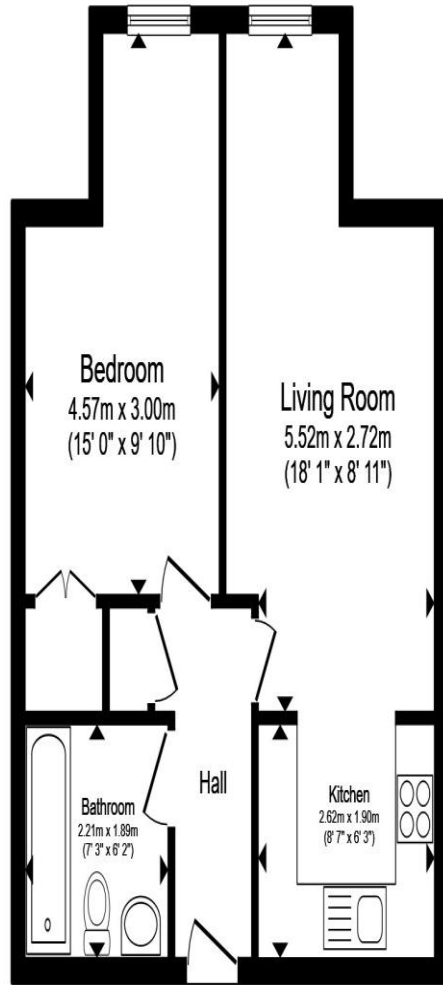

Floor Plan

Total floor area 43.3 m² (466 sq.ft.) approx

This floor plan is for illustrative purposes only. It is not drawn to scale. Any measurements, floor areas (including any total floor area), openings and orientation are approximate. No details are guaranteed, they cannot be relied upon for any purpose and they do not form part of any agreement. No liability is taken for any error, omission or misstatement. A party must rely upon its own inspection(s). Powered by www.propertybox.io



welcome to
**Simon House, St. Marys Road,
Ipswich**

- Modern ground floor flat
- Seperate lounge & kitchen
- One bedroom
- One allocated parking space
- Short walk to shops & amenities

Tenure: Leasehold EPC Rating: C

Council Tax Band: B Service Charge: 2093.20

Ground Rent: 100.00

This is a Leasehold property with details as follows; Term of Lease 125 years from 01 Jan 2002. Should you require further information please contact the branch. Please Note additional fees could be incurred for items such as Leasehold packs.

offers over

£130,000



view this property online williamhbrown.co.uk/Property/IPS121134



Property Ref:
IPS121134 - 0005

1. MONEY LAUNDERING REGULATIONS Intending purchasers will be asked to produce identification documentation at a later stage and we would ask for your co-operation in order that there is no delay in agreeing the sale. 2. These particulars do not constitute part or all of an offer or contract. 3. The measurements indicated are supplied for guidance only and as such must be considered incorrect. Potential buyers are advised to recheck measurements before committing to any expense. 4. We have not tested any apparatus, equipment, fixtures or services and it is in the buyers interest to check the working condition of any appliances. 5. Where an EPC, or a Home Report (Scotland only) is held for this property, it is available for inspection at the branch by appointment. If you require a printed version of a Home Report, you will need to pay a reasonable production charge reflecting printing and other costs. 6. We are not able to offer an opinion either written or verbal on the content of these reports and this must be obtained from your legal representative. 7. Whilst we take care in preparing these reports, a buyer should ensure that his/her legal representative confirms as soon as possible all matters relating to title including the extent and boundaries of the property and other important matters before exchange of contracts.

William H Brown is a trading name of Sequence (UK) Limited which is registered in England and Wales under company number 4268443, Registered Office is Cumbria House, 16-20 Hockliffe Street, Leighton Buzzard, Bedfordshire, LU7 1GN. VAT Registration Number is 500 2481 05.



william h brown



01473 226101



ipswich@williamhbrown.co.uk



16-18 Wolsey House, Princes Street, IPSWICH,
Suffolk, IP1 1QT



williamhbrown.co.uk