

Carlisle Road, Crouch End

£3,495 Per Month



# Carlisle Road, Crouch End

£3,495 Per Month



## Summary Description

Three double bedroom house is available from 26th of May. Property is featuring large lounge leading to a large private garden, fully fitted kitchen with dining area, three the very good size bedrooms, large bathroom and a separate WC.

Other benefit are fully double glazed windows, no carpets, high ceiling, great storage.

This location offers great transport links, within 13minutes walks easy access to Finsbury park, Manour house, Harringay and Crouch hill.

One week`s holding deposit required, 5 weeks damage deposit required, EPC rating C, Council tax band E. Call Jorgensen Turner estate agents to arrange a viewing.

## Area Map

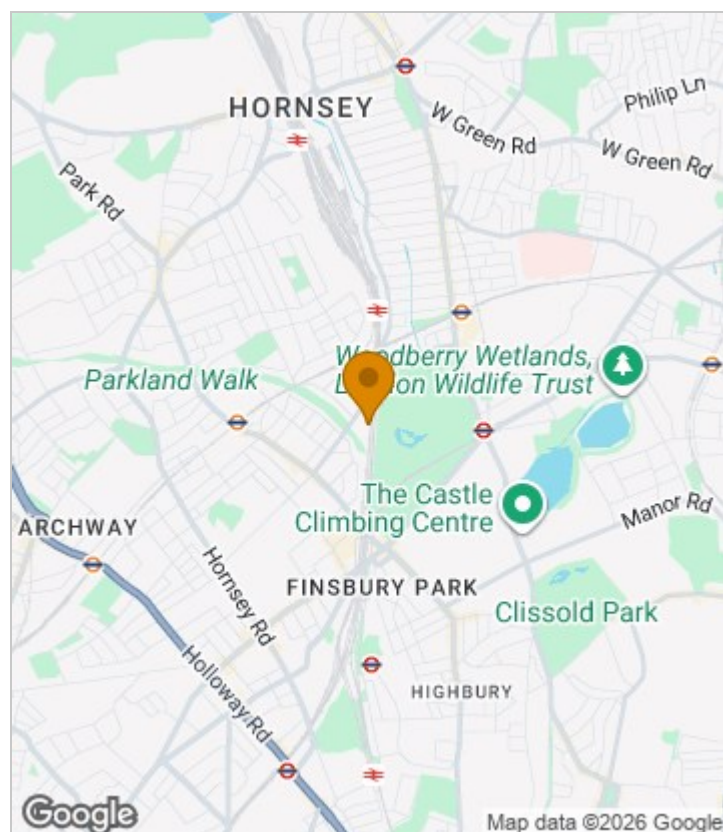



# Floor Plan

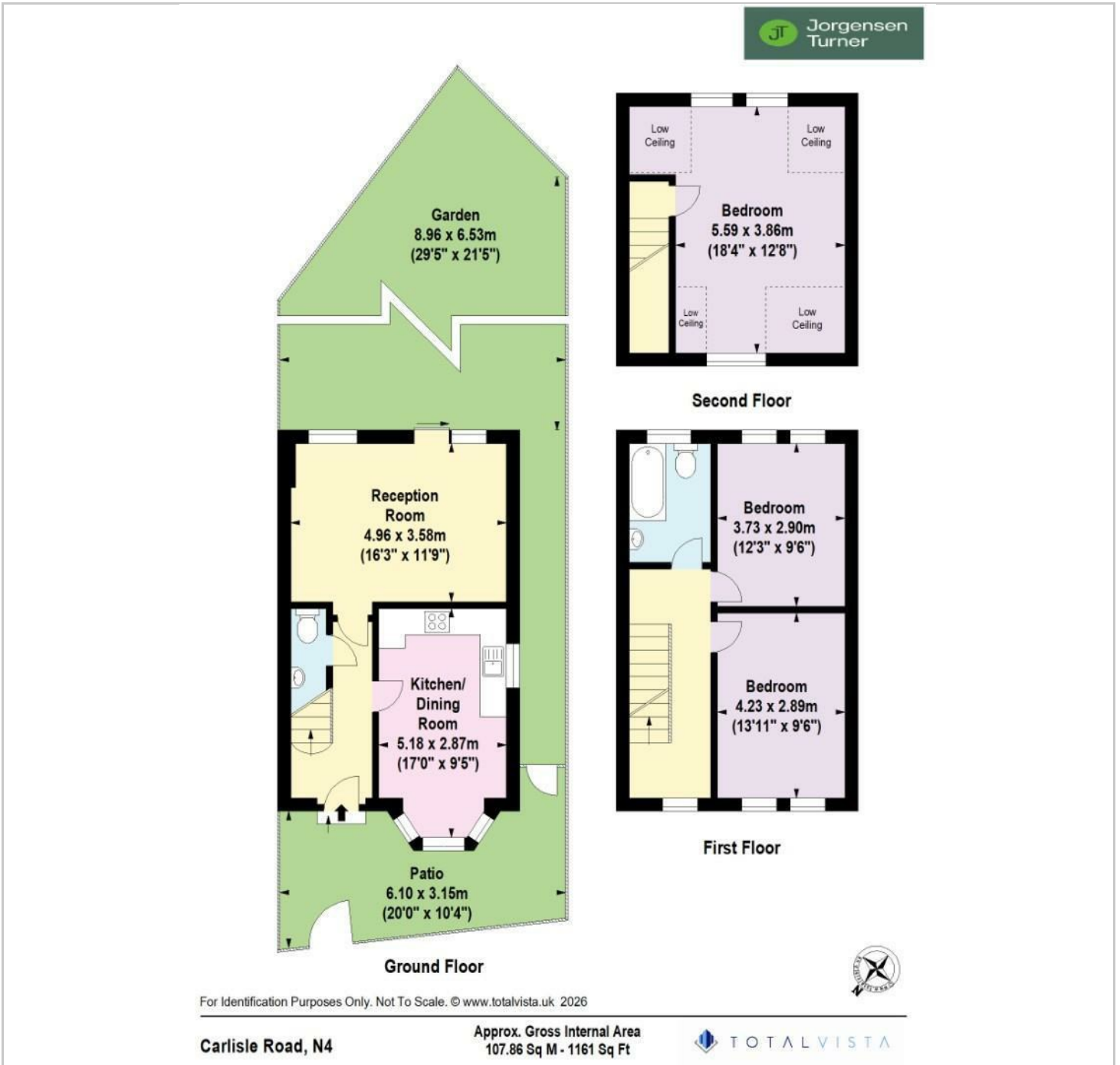

## Energy Efficiency Graph

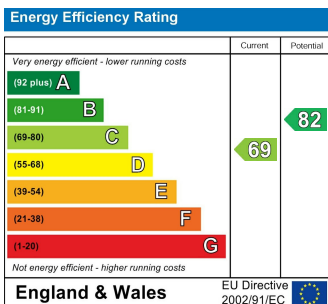

## Viewing

Please contact our Lettings QP Office on 0207 604 4040 if you wish to arrange a viewing appointment for this property or require further information.

For further information contact:

Lettings QP, 2a Brondesbury Road, London, NW6 6AS

Tel: 0207 604 4040 Email: [info@jorgensenturner.com](mailto:info@jorgensenturner.com) <https://www.jorgensenturner.com/>

## Disclaimer

These particulars, whilst believed to be accurate are set out as a general outline only for guidance and do not constitute any part of an offer or contract. Intending purchasers should not rely on them as statements of representation of fact, but must satisfy themselves by inspection or otherwise as to their accuracy. No person in this firm's employment has the authority to make or give any representation or warranty in respect of the property.