



MOVE INN ESTATES

MAKING THE RIGHT MOVE



Ouseley Road

Wraysbury, Staines-Upon-Thames, TW19 5JA

Asking Price £1,325,000



Floor Plan

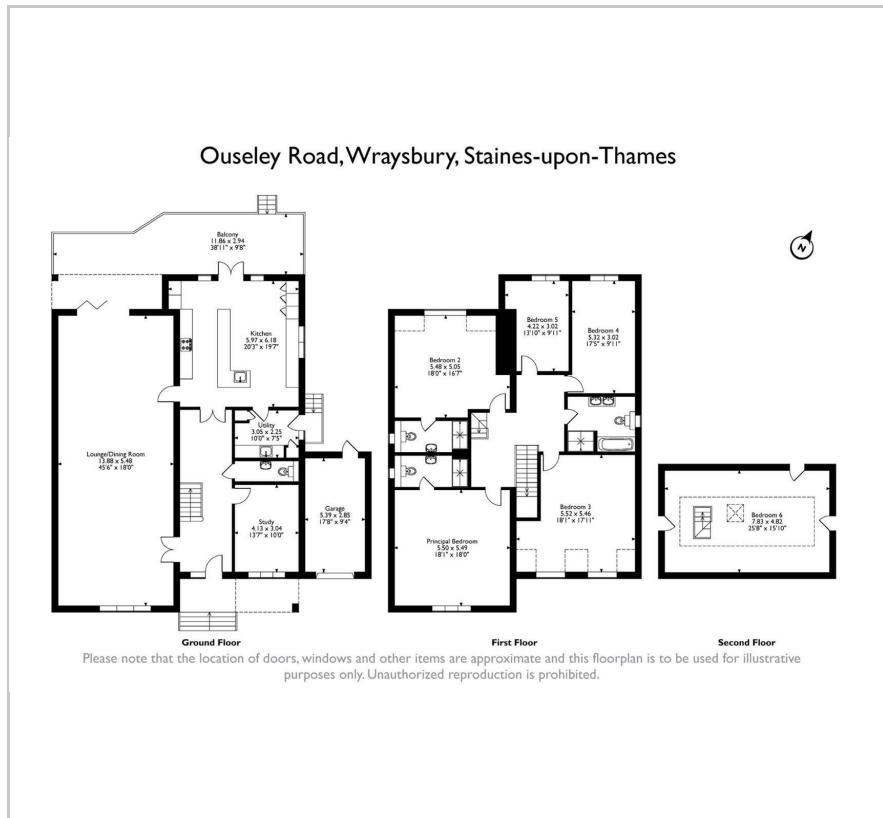

Area Map



Energy Efficiency Graph

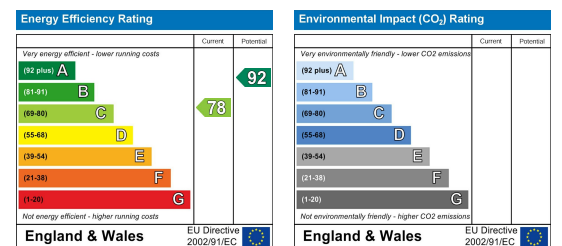

Viewing

Please contact our Move Inn Iver Office on 01753900950 if you wish to arrange a viewing appointment for this property or require further information.

- Well Sized Private Driveway
- Gated Detached Property
- 6 Bedrooms
- 100ft+ Garden To The Rear
- Ideal Location
- Finished To A High Class Standard



Move Inn Estates are proud to present this stunning detached house located on a highly desirable road in Wraysbury village. This exceptional property has been meticulously extended and renovated to offer contemporary living across a spacious layout of over 3,600 square feet. The house features six generous bedrooms, including two with ensuite bathrooms, a family bathroom, and a variety of living spaces designed to accommodate a modern lifestyle.

The main reception room, an expansive space that spans the length of the property, is perfect for both relaxation and entertaining. This is complemented by a cozy family room and a dedicated study, providing a quiet space for work or reading. The open plan kitchen and dining area is the heart of the home, boasting luxury finishes, high-end appliances, and ample space for both everyday meals and hosting guests. Additionally, a large utility room offers extra storage and functionality, ensuring that the home remains tidy and organized.

Set on approximately 1/3 of an acre, the property includes a beautifully designed garden that offers stunning views over the fields to the rear, providing a sense of tranquility and privacy. The outdoor space is ideal for gardening enthusiasts, family gatherings, or simply enjoying the picturesque scenery. A gated driveway adds an extra layer of security and privacy, leading to ample off-street parking and a garage, accommodating multiple vehicles with ease.

This house seamlessly blends luxury and practicality, making it an ideal family home. With its modern



These particulars, whilst believed to be accurate are set out as a general outline only for guidance and do not constitute any part of an offer or contract. Intending purchasers should not rely on them as statements of representation of fact, but must satisfy themselves by inspection or otherwise as to their accuracy. No person in this firm's employment has the authority to make or give any representation or warranty in respect of the property.