



## Beaumont Street, W1G

£799,950

A two double bedroom apartment located in central location behind Maylebone High Street. Overlooks a private residents garden and has a long lease.

Located just moments from the amenities of Marylebone High Street and Regents Park. Local stations are Baker Street, Regents Park and Bond Street.

### Features

Two Double Bedrooms  
Bright Reception - Dining Room  
Separate Modern Kitchen  
Passenger Lift  
Long Lease To 2144  
Residents Gardens



**Beaumont Street, W1G**



# Beaumont Street, London, W1G

## Lower Ground Floor

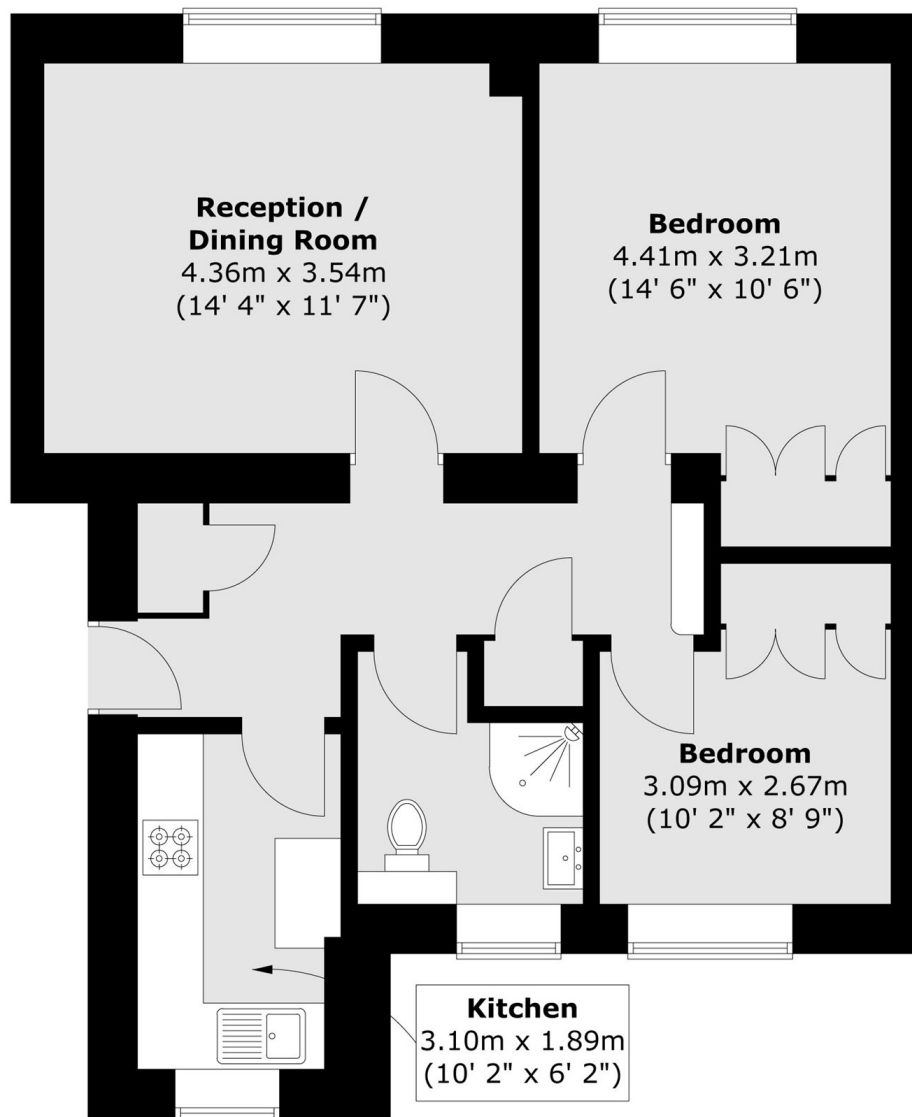

Total area (approx.) : 58.1 sq. m (625 sq. ft)