



Chevallier Street, Ipswich, £850 Per month



Grace Estate Agents are delighted to market this spacious two-bedroom ground floor apartment situated on Chevallier Street, conveniently located close to Ipswich town centre and local amenities.

The accommodation comprises a welcoming entrance hall leading to a bright and generously sized living room, a fitted kitchen with ample worktop and storage space, two well-proportioned bedrooms, and a bathroom suite. The principal bedroom is particularly spacious, while the second bedroom offers flexibility for use as a guest room or home office.

Ideally positioned within easy reach of Ipswich railway station, local shops, restaurants, and the popular waterfront area, the apartment also offers excellent transport links and convenient access to everyday amenities.

The property benefits from double glazing, electric heating, and permit parking available via a waiting list.

- Two-bedroom ground floor apartment
- Spacious living room
- Fitted kitchen with storage space
- Double glazing and electric heating
- Close to Ipswich railway station and waterfront
- Convenient access to Ipswich town centre
- Additional internal storage cupboard
- Permit parking available via waiting list

£850 Per month

Viewing

Please contact our Grace Estate Agents Office on 01473 747728 if you wish to arrange a viewing appointment for this property or require further information.



GROUND FLOOR
611 sq.ft. (56.8 sq.m.) approx.

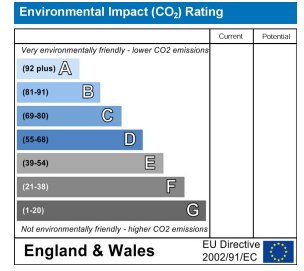
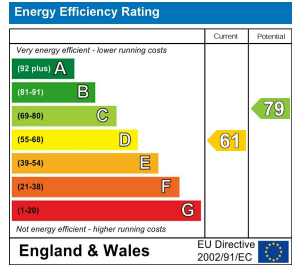
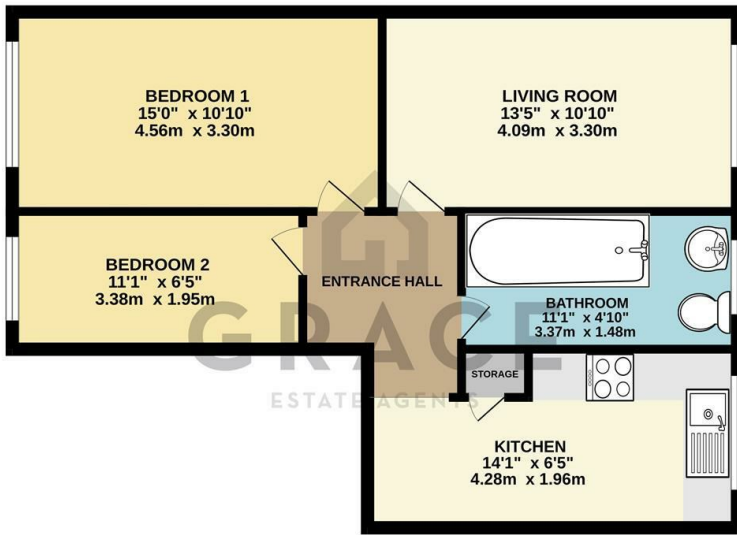

TOTAL FLOOR AREA: 611 sq.ft. (56.8 sq.m.) approx.
Whilst every attempt has been made to ensure the accuracy of the floorplan contained here, measurements of doors, windows, rooms and any other items are approximate and no responsibility is taken for any error, omission or mis-statement. This plan is for illustrative purposes only and should be used as such by any prospective purchaser. The services, systems and appliances shown have not been tested and no guarantee as to their operability or efficiency can be given.
Made with MetreX ©2026



These particulars, whilst believed to be accurate are set out as a general outline only for guidance and do not constitute any part of an offer or contract. Intending purchasers should not rely on them as statements of representation of fact, but must satisfy themselves by inspection or otherwise as to their accuracy. No person in this firm's employment has the authority to make or give any representation or warranty in respect of the property.