



Q Quinn & Co
ESTATE AND LETTING AGENTS

Milton Road, Bournemouth

- Two double bedrooms
- Sought after location
- Short walk to train station, bus routes etc
- Allocated parking space

£185,000

EPC Rating 'D'





Property Description

Spacious Two-Bedroom First Floor Flat – Prime Location Near Bournemouth Station

This well-presented two double bedroom first floor flat is ideally located within a short walk of Bournemouth train station, with easy access to local bus routes, shops, and amenities.

The property offers a bright and airy lounge featuring a charming bay window and attractive fire surround, creating a comfortable living space. The kitchen is well-equipped with ample storage, an integrated oven, gas hob, and fridge/freezer, along with space and plumbing for a washing machine.

Both bedrooms are generously sized, providing plenty of room for bedroom furniture. The modernised shower room includes a spacious shower cubicle and contemporary fittings.

Additional benefits include partial double glazing and gas-fired central heating.





The property is offered with no forward chain, making it an excellent option for both first-time buyers and investors.

Key Information:

Lease term: 189 years from September 2005
Maintenance charge: approximately £2,592 per year
Ground rent: Peppercorn
Council tax band: B



GROUND FLOOR
506 sq.ft. (47.0 sq.m.) approx.

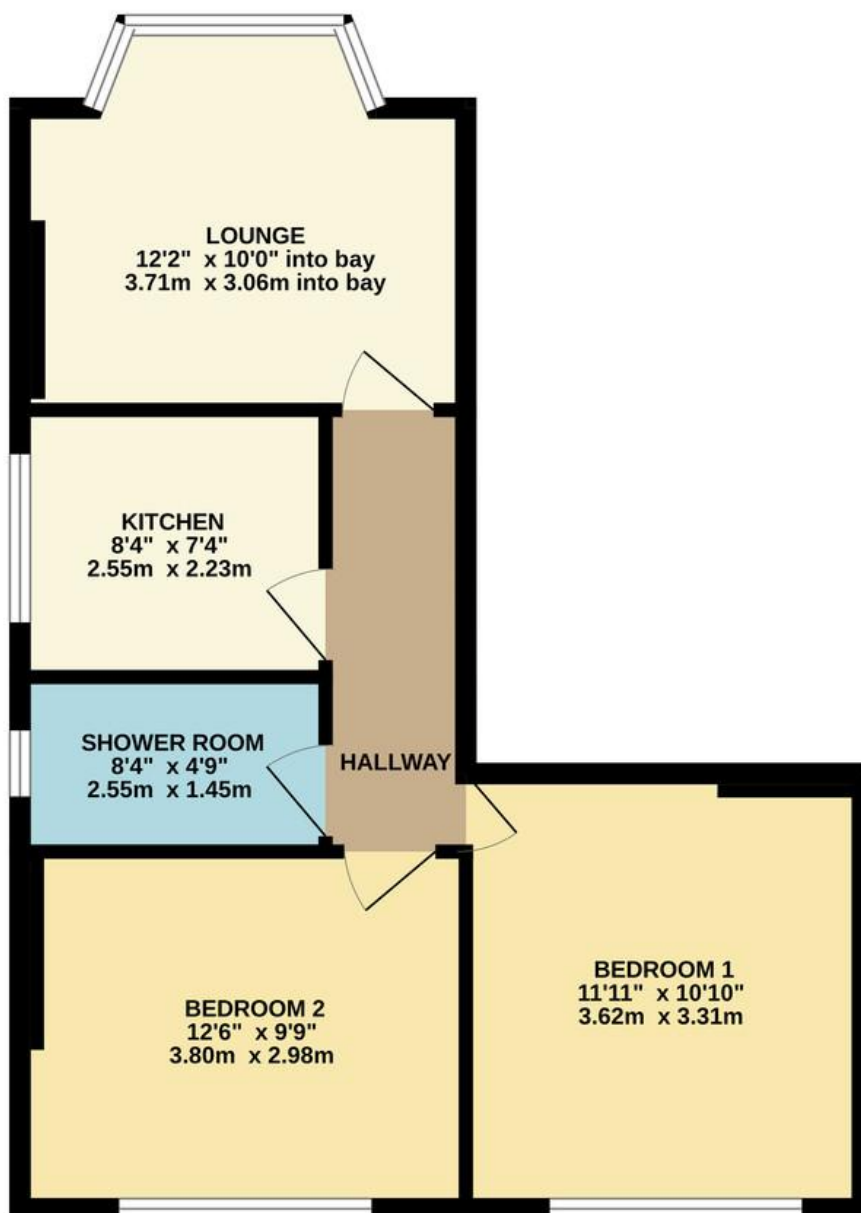

TOTAL FLOOR AREA : 506 sq.ft. (47.0 sq.m.) approx.

Whilst every attempt has been made to ensure the accuracy of the floorplan contained here, measurements of doors, windows, rooms and any other items are approximate and no responsibility is taken for any error, omission or mis-statement. This plan is for illustrative purposes only and should be used as such by any prospective purchaser. The services, systems and appliances shown have not been tested and no guarantee as to their operability or efficiency can be given.
Made with Metropix ©2026

413-415 Charminster
Road
Bournemouth
Dorset
BH8 9QT

www.quinnandco.co.uk
sales@quinnandco.co.uk
01202 512299

Consumer Protection from Unfair Trading Regulations 2008.
The Agent has not tested any apparatus, equipment, fixtures and fittings or services and so cannot verify that they are in working order or fit for the purpose. A Buyer is advised to obtain verification from their Solicitor or Surveyor. References to the Tenure of a Property are based on information supplied by the Seller. The Agent has not had sight of the title documents. A Buyer is advised to obtain verification from their Solicitor. Items shown in photographs are NOT included unless specifically mentioned within the sales particulars. They may however be available by separate negotiation. Buyers must check the availability of any property and make an appointment to view before embarking on any journey to see a property.