



Jordanfishwick

Barlow Moor Road
Manchester



**Barlow Moor Road
Manchester M21 8AY**
£1,195 Per Calendar Month



The Property

**** AVAILABLE NOW **** We are delighted to offer this spacious and perfectly placed one bedroom apartment. The property is situated in the centre of Chorlton close to Beech Road and all amenities and transport links. The property offers spacious accommodation throughout as well as direct access to the large communal garden at the rear. You enter the property via communal front door with Flat door on the right with vestibule, you then enter the large and light lounge/kitchen/diner - all appliances are new, double bedroom at the rear with built in wardrobe space, large bathroom with shower over bath. To the rear there is a large walled garden available for use to both Apartments in the building - Gardener provided. The property is offered unfurnished, double glazing and gas central heating installed.

***** To arrange a viewing please call 0161 860 4444 *****

Directions

- Council Tax Band - EPC D
- One bedroom Ground Floor apartment
- Unfurnished
- Central Chorlton
- Large communal rear garden
- Close to all Transport links & Beech Road
- Available Now

Postcode - M21 8AY
EPC Rating - D
Floor Area - sq ft
Local Authority - Manchester
Council Tax - A



GROUND FLOOR
410 sq.ft. (38.1 sq.m.) approx.

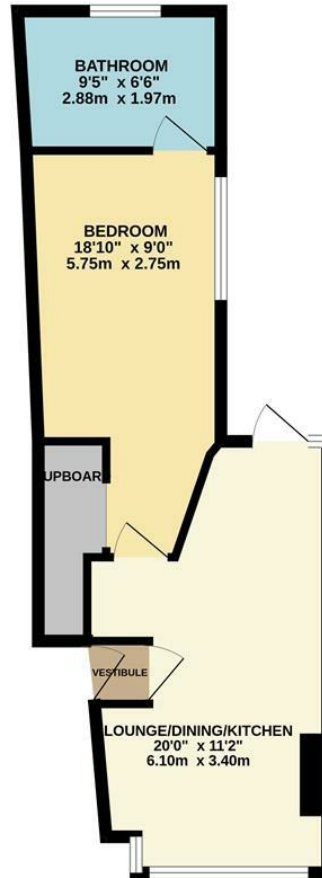

TOTAL FLOOR AREA : 410 sq.ft. (38.1 sq.m.) approx.

Whilst every attempt has been made to ensure the accuracy of the floorplan contained here, measurements of doors, windows, rooms and any other items are approximate and no responsibility is taken for any error, omission or mis-statement. This plan is for illustrative purposes only and should be used as such by any prospective purchaser. The services, systems and appliances shown have not been tested and no guarantee as to their operability or efficiency can be given.
Made with Metropix ©2026



These particulars are believed to be accurate but they are not guaranteed and do not form a contract. Neither Jordan Fishwick nor the vendor or lessor accept any responsibility in respect of these particulars, which are not intended to be statements or representations of fact and any intending purchaser or lessee must satisfy himself by inspection or otherwise as to the correctness of each of the statements contained in these particulars. Any floorplans on this brochure are for illustrative purposes only and are not necessarily to scale.

Offices at: Offices at Chorlton, Didsbury, Disley, Hale, Glossop, Macclesfield, Manchester Deansgate, Manchester Whitworth Street, New Mills, Sale, Wilmslow and Withington

410-412 Barlow Moor Road, Chorlton, Manchester, M21

8AD
01618604444

chorlton@jordanfishwick.co.uk
www.jordanfishwick.co.uk