



**POOLE
TOWNSEND**

47 Kentmere Crescent

£240,000

🛏️ 2 🚿 1 🚗 0



Located in the highly sought-after area of Hawcoat, this semi-detached bungalow occupies a level plot and is offered for sale with no onward chain. Ideally suited to those seeking single-storey living in a convenient residential setting, the property provides nicely appointed accommodation with scope to personalise. The internal layout includes a bright bay-windowed lounge/diner featuring a gas fire, creating a comfortable and welcoming living space. The kitchen provides access through to a conservatory, offering an additional reception area with views over the rear garden and direct access outside. There are two well-proportioned bedrooms and a wet room, providing practical and accessible accommodation throughout. Externally, the property benefits from a driveway with parking for two vehicles, along with lawned gardens to both the front and rear.

Location

What3Words///pure.cross.margin

Description

The entrance vestibule opens into a central hallway, where there is ladder access to the loft space and doors leading to all main living accommodation.

The lounge/diner is a generously sized reception room enjoying a pleasant outlook over the front garden. A central fireplace with hearth and an open-fronted gas fire provides a focal point, creating a warm and welcoming living space.

The breakfast kitchen is fitted with a range of storage cupboards, a two-sided worktop and matching breakfast bar, offering casual dining space alongside room for freestanding appliances. A door leads from the kitchen into a cosy conservatory, fitted with a radiator for year-round use, with glazed windows and doors providing views and access onto the rear garden.

The largest bedroom overlooks the rear garden and benefits from built-in wardrobes, drawers and a vanity dressing table. The second bedroom is a small double or large single, with space for freestanding furniture. The wet room comprises a wall-mounted



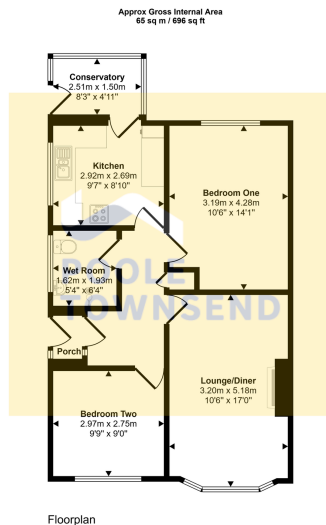

This floorplan is only for illustrative purposes and is not to scale. Measurements of rooms, doors, windows, and any items are approximate and no responsibility is taken for any error, omission or mis-statement. Icons of items such as bathroom suites are representations only and may not look like the real items. Made with Made Snappy 360.

- 2 Bed Semi-Detached Bungalow
- No Onward Chain
- Situated In A Convenient residential Setting
- Featuring a Bright Bay-Windowed Lounge/Diner
- Kitchen Providing Access To The Conservatory
- Two well-Proportioned Bedrooms
- A wet Room
- Featuring A Driveway
- Offering Parking For Two Vehicles
- Lawned Gradients To Both Front And Rear

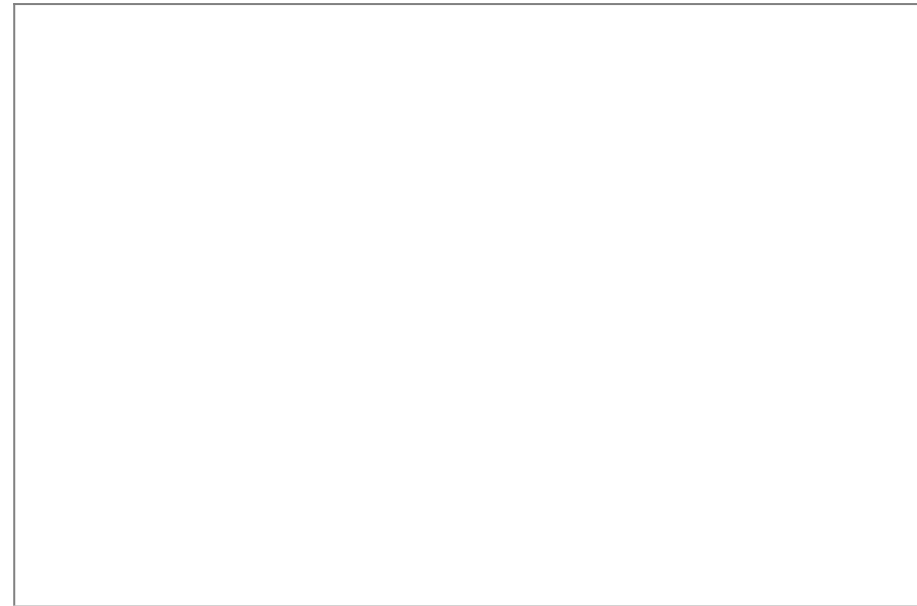

Visit us at
www.pooletownsend.co.uk
enquiries@pooletownsend.co.uk

We are open
 Monday – Friday 9.00 – 5.00
 Saturday 9.00 – 1.00

Barrow 01229 811811
 Ulverston 01229 588111
 Grange 015395 33316
 Kendal 01539 734455
 Milnthorpe 015395 62044