



75 Clive Road

, Portsmouth, PO1 5JB

Guide price £245,000

Chain Complete | 3 Bedroom Family Home | Central Location
| Well Decorated | Upstairs Bathroom | Great Transport Links
| Perfect for First Time Buyers | Ideal for Investors

- 3 Bedroom Family Home
- Central Location
- Well Decorated
- Close to Transport Links
- Perfect for First Time Buyers
- Ideal for Investors
- Upstairs Bathroom
- Chain Complete

Viewing

Please contact our ROK Marsh Office on 02393233267
if you wish to arrange a viewing appointment for this property or
require further information.

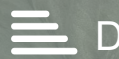

Floor Plan

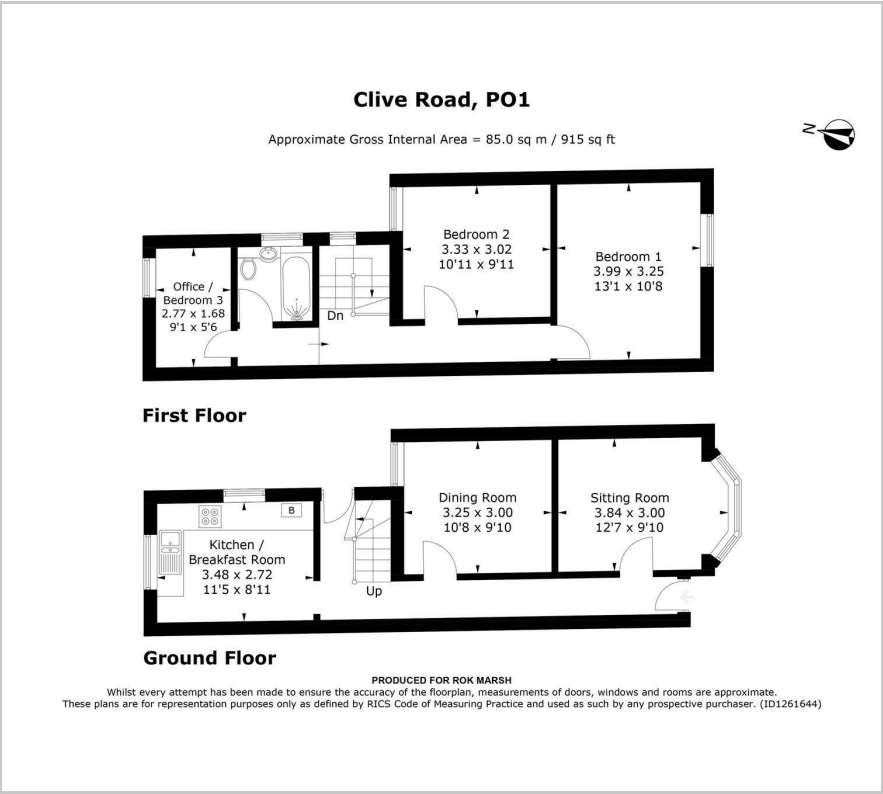

Area Map



Energy Efficiency Graph

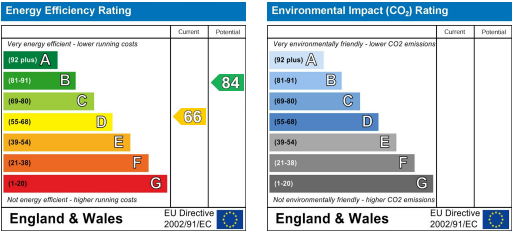

These particulars, whilst believed to be accurate are set out as a general outline only for guidance and do not constitute any part of an offer or contract. Intending purchasers should not rely on them as statements of representation of fact, but must satisfy themselves by inspection or otherwise as to their accuracy. No person in this firm's employment has the authority to make or give any representation or warranty in respect of the property.