



Cantors Way, Minety – SN16 9QZ
Malmesbury

In Excess of **£425,000**
mcfarlane
property.com

Cantors Way

Minety, Malmesbury

- FOUR BEDROOMS Ensuite to Master
- Improved and Altered
- Cul De Sac Setting
- Kitchen Breakfast Room + Utility + Boiler Room + WC
- Generous Living Room with 2 Sets of French Doors to Garden
- Electric Car Charging Point
- Driveway Off Road Parking

A well proportioned Four Bedroom detached home in a sought after cul-de-sac setting within the sought after wiltshire village of Minety. This picturesque village offers a community shop plus a renowned primary school a well as sports/ social clubs.



Cantors Way

Minety, Malmesbury

Council Tax band: D

Tenure: Freehold

EPC Energy Efficiency Rating: D

EPC Environmental Impact Rating: D



mcfarlane
property.com

Ground Floor

Approx. 69.9 sq. metres (752.1 sq. feet)

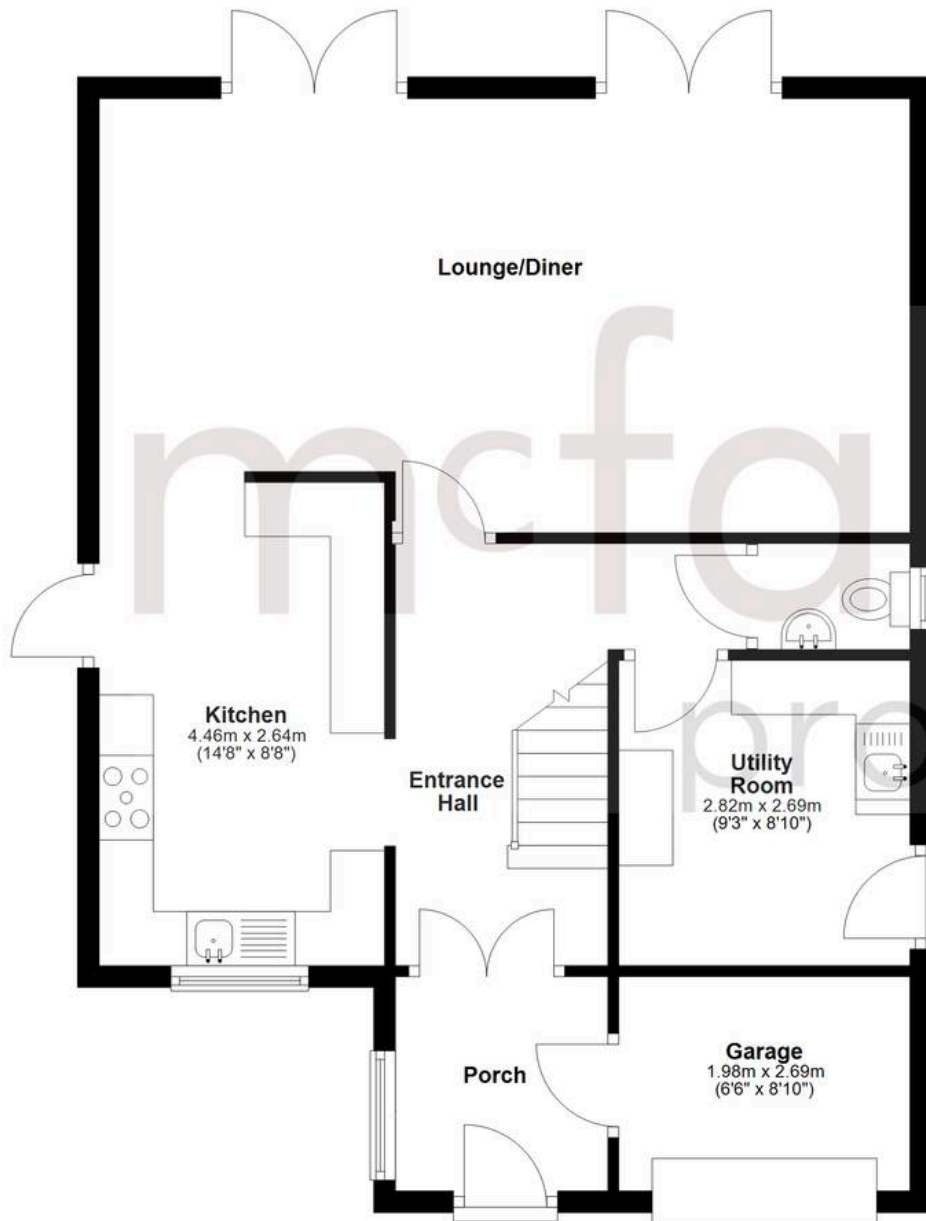

First Floor

Approx. 60.2 sq. metres (647.6 sq. feet)

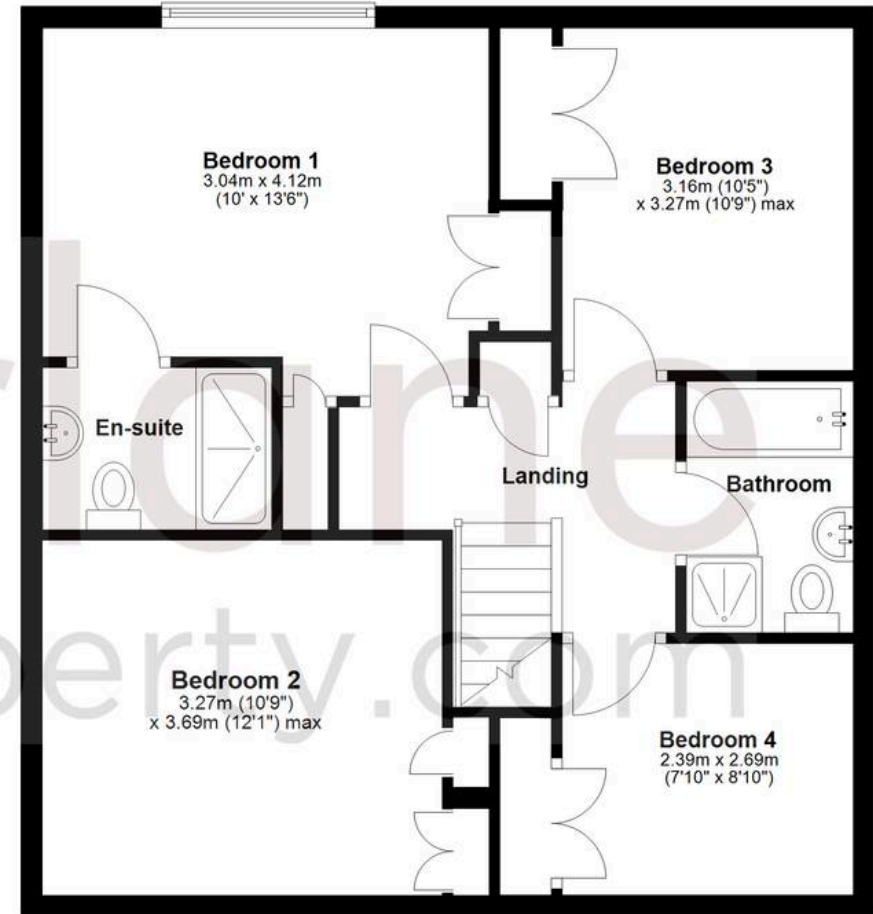

Total area: approx. 130.0 sq. metres (1399.7 sq. feet)

Agents Note: Whilst every care has been taken to prepare these sales particulars, they are for guidance purposes only. All measurements are approximate and for general guidance purposes only and whilst every care has been taken to ensure their accuracy, they should not be relied upon and potential buyers are advised to recheck the measurements.