

# Parkheath

*Sold on Service*

---

**Wenlock Road N1**

**£3,100 PCM (£715 per week) - Hackney Band E**



Stylish 1 bedroom loft with separate study

Architecturally designed

Communal quayside terrace

Separate spacious kitchen

Located minutes to Angel, Old Street and Shoreditch

Canalside development with portorage

Fantastic canal views

Bright reception with dining area

Double bedroom with fitted wardrobes

EPC Rating C, Council Tax: Hackney band E

Belsize Park Office 020 7431 3104

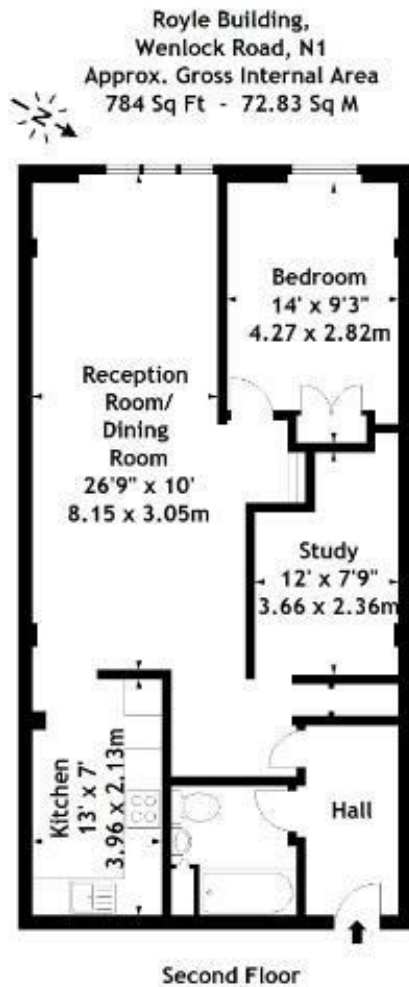

Measured in accordance with RICS guidelines. Every attempt is made to ensure accuracy, however all measurements are approximate. This floor plan is for illustrative purposes only and is not to scale.  
© Datagraphy Ltd 2016  
Photographs \* Floorplans \* Virtual Tours  
Tel: 0845 643 4401 [www.datagraphy.com](http://www.datagraphy.com)

The particulars do not constitute part of an offer or contract. The particulars, including text, photographs and plans, are for the guidance only of prospective purchasers/tenants and must not be relied upon as statements of fact. The descriptions provided therein represent the opinion of the author and whilst given in good faith should not be construed as statements of fact. Nothing in these particulars shall be deemed a statement that the property is in good condition or otherwise or that any services or facilities are in good working order. All measurements are approximate.

The particulars do not constitute part of an offer or contract. The particulars, including text, photographs and plans, are for the guidance only of prospective purchasers/tenants and must not be relied upon as statements of fact. The descriptions provided therein represent the opinion of the author and whilst given in good faith should not be construed as statements of fact. Nothing in these particulars shall be deemed a statement that the property is in good condition or otherwise or that any services or facilities are in good working order. All measurements are approximate