



House - Detached (EPC Rating:)

GOLF AT 6A GLOUCESTER ROAD, BIRKDALE, SOUTHPORT, MERSEYSIDE, PR8

2AU
Per Week

£22,000

FEATURES

- Golf Open 2026 Accommodation
- Sleeps Up To Eleven
- Four Bedroom Main House & Two Bedroom Lodge
- Beautifully Kept Gardens
- Closeby to Birkdale Village
- 1.2 Miles From Royal Birkdale
- Gated Off Street Parking
- Multiple Reception Spaces



 **anthony james**
estate agents

5 Bedroom House - Detached located in Southport

GOLF | CHARLOTTE HOUSE, GROUND FLOOR, 35-37 HOGHTON STREET, SOUTHPORT, MERSEYSIDE, PR9 0NS



GOLF | CHARLOTTE HOUSE, GROUND FLOOR, 35-37 HOGHTON STREET, SOUTHPORT, MERSEYSIDE, PR9 0NS



GOLF | CHARLOTTE HOUSE, GROUND FLOOR, 35-37 HOGHTON STREET, SOUTHPORT, MERSEYSIDE, PR9 0NS



GOLF | CHARLOTTE HOUSE, GROUND FLOOR, 35-37 HOGHTON STREET, SOUTHPORT, MERSEYSIDE, PR9 0NS

Call us on

01704543434

golf@ajestateagents.co.uk

<https://www.ajestateagents.co.uk/properties/to-rent/sort-price-asc>

Council Tax Band

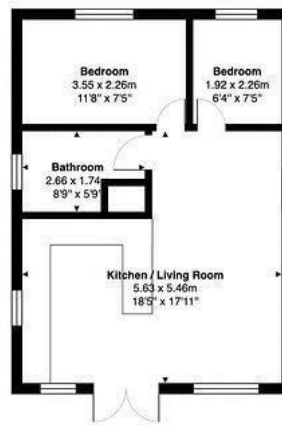

Energy Efficiency Rating		
	Current	Potential
<i>Very energy efficient - lower running costs</i>		
(92 plus) A		
(81-91) B		
(69-80) C		
(55-68) D		
(39-54) E		
(21-38) F		
(1-20) G		
<i>Not energy efficient - higher running costs</i>		
England & Wales	EU Directive 2002/91/EC	

Agents Note: Whilst every care has been taken to prepare these particulars, they are for guidance purposes only. All measurements are approximate and are for general guidance purposes only and whilst every care has been taken to ensure their accuracy, they should not be relied upon and potential buyers are advised to recheck the measurements.

Gloucester Road, Birkdale, PR8 2AU

Total Area: 300.8 m² ... 3238 ft² Approximate sq ft - garage, outbuilding and eaves not measured
All measurements are approximate and for display purposes only

