



Bramley Road, Birmingham, B27 6TR

**SHELDON
BOSLEY
KNIGHT**

LAND AND
PROPERTY
PROFESSIONALS

Property Description

This beautifully presented two bedroom home has been recently refurbished, offering a fresh, modern living space ideal for tenants seeking comfort and convenience.

The property benefits from a brand new fitted kitchen, finished to a high standard, providing ample storage and workspace, along with new double doors allowing plenty of natural light into the room and create a seamless connection to the garden.

Internally, the property has been newly decorated throughout, complemented by brand new carpets, giving the entire home a clean and contemporary feel. A new central heating system has also been installed.

Situated in a popular residential location, the property is close to local amenities, transport links, and schools, as well as being a short drive from Acocks Green Village

Early viewing is highly recommended to appreciate the quality of this home.





Key Features

- Refurbished Two Bedroom Home
- New Modern Fitted Kitchen
- New Carpets
- Newly Decorated
- New Central Heating System
- New Rear Double Doors
- Driveway Parking
- EPC Rating: D
- Council Tax Band: C

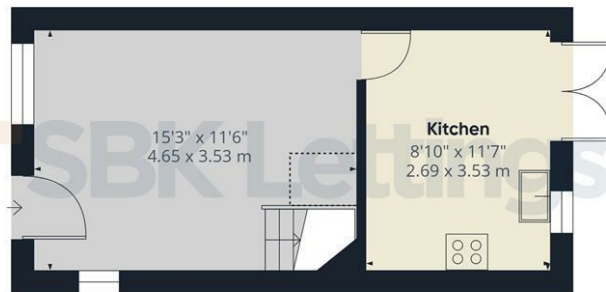

Ground Floor

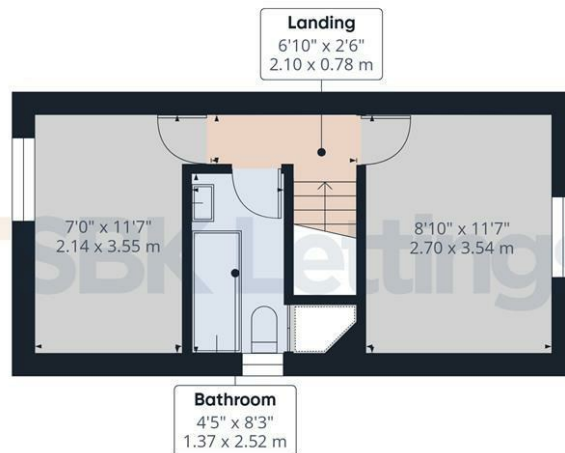

Floor 1



Approximate total area⁽¹⁾

524 ft²
48.7 m²

Reduced headroom

7 ft²
0.7 m²

(1) Excluding balconies and terraces

Reduced headroom

Below 5 ft/1.5 m

Calculations reference the RICS IPMS 3C standard. Measurements are approximate and not to scale. This floor plan is intended for illustration only.

GIRAFFE360

£1,150 PCM