

Symonds
& Sampson

43 Back Lane
Cerne Abbas, Dorchester,

43

Back Lane
Cerne Abbas
Dorchester
DT2 7JW

A modern village house in need of gentle updating.



- Soughtafter village location
- In need of gentle improvement
 - No chain
 - Garage
- Close to village amenities
 - End of terrace

Guide Price **£240,000**

Freehold

Dorchester Sales
01305 261008
dorchester@symondsandsampson.co.uk



THE PROPERTY

This modern village house requires some gentle modernisation and is being sold with no chain. The property has been extended and has accommodation comprising; Entrance porch, sitting room, separate dining room and kitchen fitted with a range of cupboards and drawers, work surfaces with sink and drainer, integrated electric oven, hob and extractor hood. There is space for an undercounter fridge and freezer and washing machine. Upstairs there are 2 bedrooms and a bathroom.

The property benefits from UPVC double glazing, electric storage heating and a garage sited at the rear of the house.

OUTSIDE

At the front of the property is a blocked paved area of garden, there is a gravel side path leading to the garden. A patio abuts the house with outside tap. There are some established shrubs and rear gate, with the garden extending behind the garage to another secluded area of garden.

SITUATION

Cerne Abbas, one of Dorset's most historic and picturesque villages, is surrounded by unspoiled countryside and lies approximately 8 miles north of the county town of Dorchester. The village enjoys a regular bus service to Sherborne (around 12 miles away) and to Dorchester, home to Dorset County Hospital. Both Sherborne and Dorchester offer mainline railway stations with direct services to London Waterloo.

The village is well regarded for its excellent amenities, including a popular sub-post office and village store, parish church, three public houses, a brewery, and a doctors' surgery with a dispensary. Cerne Abbas has a thriving community with a range of clubs and societies, as well as a fine, modern village hall.

DIRECTIONS

What3words [///forklift.texted.cool](#)

SERVICES

Mains water, electricity and drainage are connected.
Electric heating.

Broadband - Superfast speed available

Mobile - There is mobile coverage in the area, please refer to Ofcom's website for more detail.

Council tax band C. Dorset Council.

MATERIAL INFORMATION

There is currently a woodburning stove at the property. Please note that this does not have a HEATAS Certificate.



Energy Efficiency Rating		
Energy efficiency class	Current	Potential
A		
B		
C		
D		
E		
F		
G		

England & Wales

Back Lane, Cerne Abbas, Dorchester

Approximate Area = 680 sq ft / 63.1 sq m

Garage = 147 sq ft / 13.6 sq m

Total = 827 sq ft / 76.7 sq m

For identification only - Not to scale

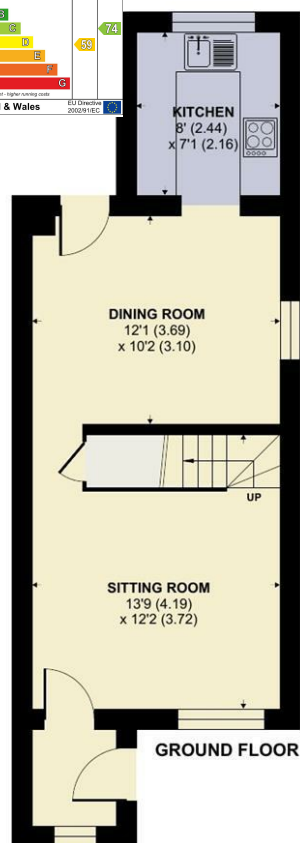

GROUND FLOOR



FIRST FLOOR

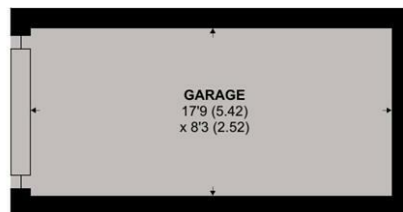

GARAGE



Floor plan produced in accordance with RICS Property Measurement 2nd Edition, Incorporating International Property Measurement Standards (IPMS2 Residential). © nichecom 2025. Produced for Symonds & Sampson. REF: 1388043

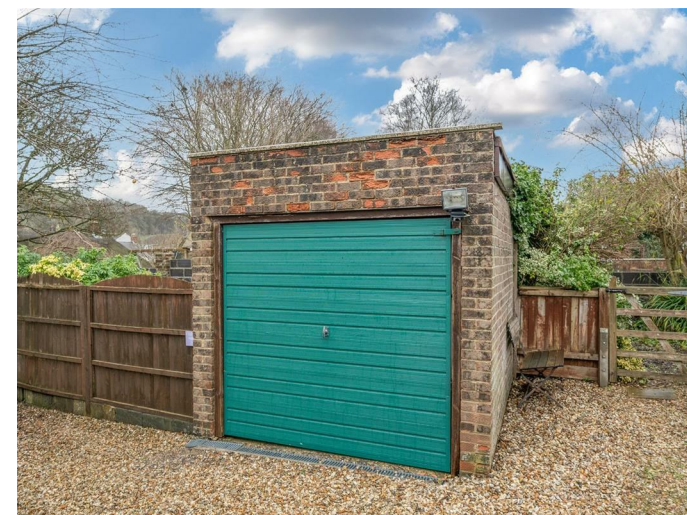

Dorchester/SP/11.12.25



01305 261008

dorchester@symondsandsampson.co.uk
Symonds & Sampson LLP
9 Weymouth Avenue, Brewery Square,
Dorchester, Dorset DT1 1QR



Important Notice: Symonds & Sampson LLP and their Clients give notice that: 1. They have no authority to make or give any representations or warranties in relation to the property. These particulars do not form part of any offer or contract and must not be relied upon as statements or representations of fact. 2. Any areas, measurements or distances are approximate. The text, photographs and plans are for guidance only and are not necessarily comprehensive. It should not be assumed that the properties have all necessary planning, building regulation or other consents and Symonds and Sampson LLP have not tested any services, equipment or facilities. 3. We have not made any investigation into the existence or otherwise of any issues concerning pollution of the land, air or water contamination and the purchaser is responsible for making his/her own enquiries in this regard. 4. The property is sold subject to and with the benefit of all existing wayleaves, easements and rights of way whether public or private, specifically mentioned or not. The vendors shall not be required to define any such rights, privileges or advantages.

SALES | LETTINGS | AUCTIONS | FARMS & LAND | COMMERCIAL | NEW HOMES | PLANNING & DEVELOPMENT