



Grosvenor Crescent Mews  
Belgravia, SW1X

CHESTERTONS





A well-presented and modern one bedroom apartment, situated on the ground floor of this gated location with a caretaker in the heart of Knightsbridge.

Accommodation is well-planned comprising a spacious reception room with separate kitchen, principal bedroom with built in wardrobes and separate modern bathroom.

Grosvenor Crescent Mews is an exclusive gated mews development, with private security at the entrance to the mews. Located moments from Hyde Park in the heart of Belgravia.

- One bedroom
- One bathroom
- Separate kitchen
- Fully furnished
- Built in storage
- Gated mews

**£3,683.33 pcm**

Additional tenant charges apply (fees apply to non-AST tenancies only)

Tenancy Agreement Fee: £300

References per Tenant/Guarantor: £60

Inventory check (approx. £100 – £250 inc. VAT)

[chestertons.co.uk/property-to-rent/applicable-fees](http://chestertons.co.uk/property-to-rent/applicable-fees)

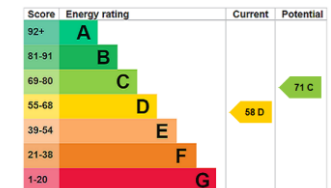

**Minimum Term:** 12 months  
**Deposit Required:** 5 weeks  
**Local Authority:** Westminster  
**Council Tax Band:** G  
**EPC Rating:** D  
**Furnished**

*Chestertons Knightsbridge & Belgravia Lettings*

31 Lowndes Street  
 London  
 SW1X 9HX

[knightsbridgelettingsusers@chestertons.co.uk](mailto:knightsbridgelettingsusers@chestertons.co.uk)  
 02072353530  
[chestertons.co.uk](http://chestertons.co.uk)

# Grosvenor Crescent Mews, SW1X

Approximate Gross Internal Area  
46.23 sq m / 498 sq ft

( CH = Ceiling Heights )

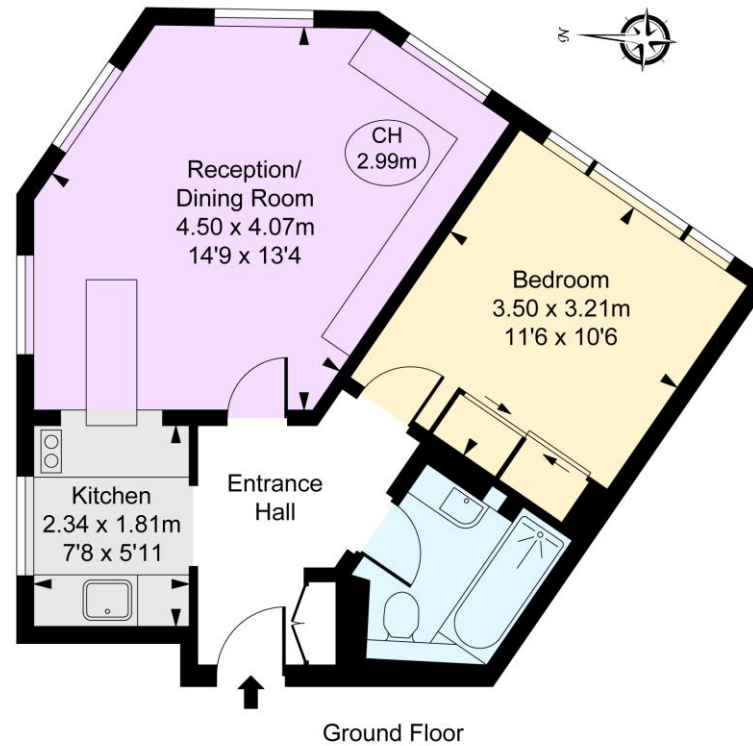

This plan is not to scale. It is for guidance and not for valuation purposes.  
All measurements and areas are approximate only, and have been prepared in accordance with the current edition of the RICS Code of Measuring Practice.  
© Fulham Performance

Chesterton UK Services Limited trading as Chestertons for themselves and for the vendor of this property whose agents they are, give notice that (i) these particulars do not constitute any part of an offer or contract, (ii) all statements contained within these particulars are made without responsibility on the part of Chestertons or the vendor, (iii) whilst made in good faith, none of the statements contained within these particulars are to be relied upon as a statement or representation of fact, (iv) any intending purchasers must satisfy themselves by inspection or otherwise as to the correctness of each of the statements contained within these particulars, (v) the vendor does not make or give either Chestertons or any person in their employment any authority to make or give representation or warranty whatsoever in relation to this property. Wide angle lenses may be used. ©Copyright Chestertons | Chesterton Global Ltd | Registered Office 5th Floor, The Lantern, 75 Hampstead Road, London, NW1 2PL Registered Company Number 05334580.



This paper is  
100% recyclable