



Purdy Court New Station Road, Fishponds, BS16 3RT
Guide Price £140,000

GOODMAN
& LILLEY



THE INDEPENDENT SALES, LETTINGS & LAND AGENTS

Purdy Court New Station Road, Fishponds, BS16 3RT

This superbly presented one-bedroom ground floor retirement apartment is situated within the highly regarded Purdy Court development and is offered to the market with the added benefit of no onward chain.

- Ground floor retirement apartment
- Beautifully presented throughout
- Communal parking gardens and facilities
- Walking distance of amenities
- One bedroom
- Modern bathroom

The property has been lovingly maintained and recently redecorated throughout, creating a bright, welcoming home ready for immediate occupation. Further enhancing the accommodation is a stylish, modern bathroom which has been replaced within recent years.

Summary

Internally, the apartment offers a spacious and comfortable living room, flooded with natural light and featuring French doors that open directly onto the beautifully maintained, south-facing communal gardens — an ideal space to enjoy warmer days and peaceful surroundings. A separate, well-equipped kitchen provides ample storage and worktop space, while the generously sized bedroom benefits from fitted wardrobes. Completing the layout is the contemporary shower room and a selection of built-in storage cupboards, adding to the practicality of the home.

Residents of Purdy Court enjoy a variety of communal facilities designed to enhance comfort and community living. These include a communal lounge, laundry room, lift access to all floors, well-kept communal gardens, and communal parking. The development also hosts organised social activities such as games evenings and film nights, providing opportunities to socialise and enjoy an active lifestyle within a friendly and supportive environment.

Location

The location is a particular highlight, with Fishponds High Street just a short walk away. Here, residents will find a wide range of amenities including supermarkets, local shops, cafés, restaurants, and excellent public transport links. Regular bus services offer convenient and direct access to Bristol City Centre as well as surrounding areas, making this an ideal spot for both convenience and connectivity.

Properties within this popular development are consistently in high demand, and early viewing is highly recommended. Contact Goodman & Lilley today to arrange your appointment and avoid missing out on this exceptional opportunity.

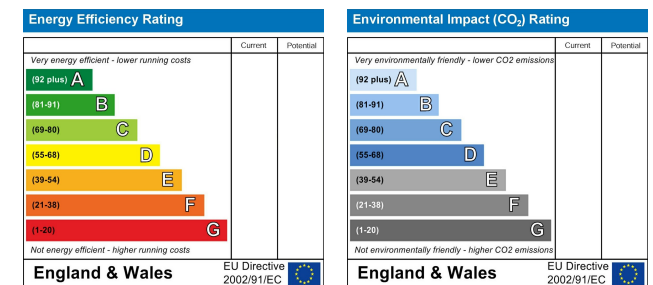

Bristol

9 High Street, Shirehampton

Bristol BS11 0DT

01172 130333

www.goodmanlilley.co.uk



Ground Floor

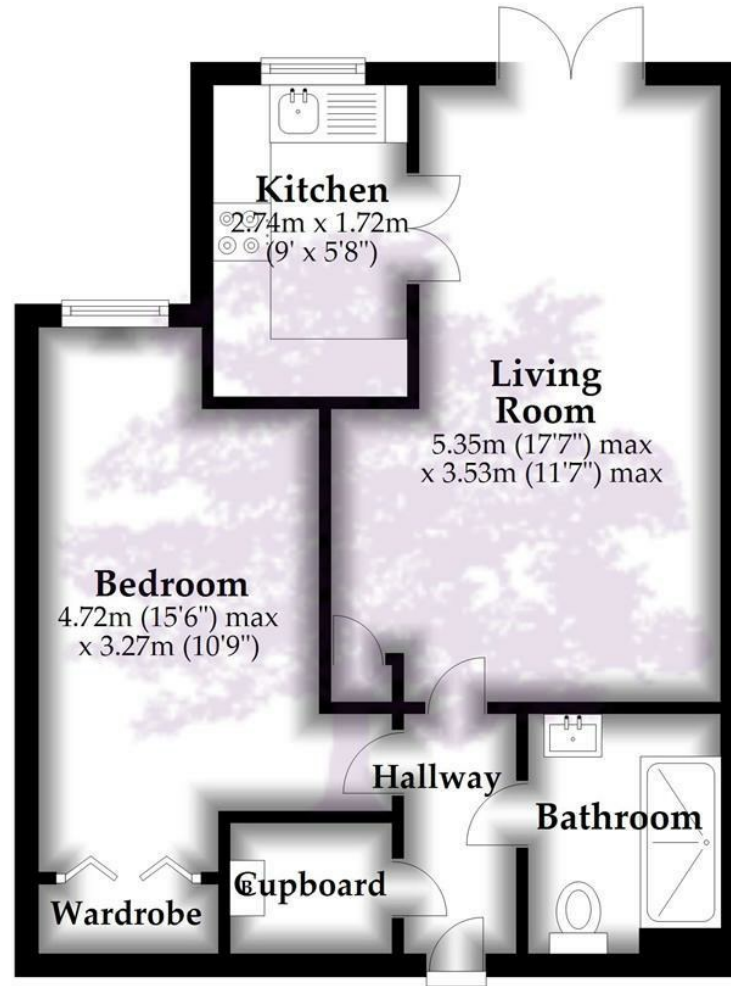

Total area: approx. 41.4 sq. metres (445.5 sq. feet)

Whilst every attempt has been made to ensure accuracy of the floor plan all measurements are approximate and no responsibility is taken for any error, omission or measurement.

Plan produced using PlanUp.



These particulars are for general guidance only. They do not form or constitute any part of an offer or contract. Goodman & Lilley has not carried out structural surveys of the property. The services, appliances or specific fittings mentioned in these details have not been tested. Every attempt is made to ensure accuracy, however all photographs, measurements, floor plans and distances are for illustrative purposes only. They must not be relied upon when purchasing carpets and or other fixtures and fittings. Lease details, service charges and ground rents are given as a guide only. They should be checked and confirmed by a licensed solicitor prior to exchange of contracts. The copyright of all details, photographs and floor plans remain exclusive to Goodman & Lilley.